

MEDIUM DUTY, HIGH PERFORMANCE SEMI-AUTOMATIC STRETCH WRAP MACHINE- SWA-82-AW

APPROX WEIGHT: 2186 lbs.  
DOES NOT INCLUDE WEIGHT OF POWER OR PACKAGING!!!

\*\*\*ANY ADDITIONS, DELETIONS, OR OMISSIONS MUST BE CORRECTED ON THIS DRAWING AS THIS DRAWING WILL BE CONSIDERED ALL INCLUSIVE\*\*\*

\*\*\*THE USE OF A GFCI WILL REQUIRE THE USE OF A LINE-REACTOR  
CONSULT YOUR LOCAL ELECTRICAL SUPPLIER FOR DETAILS\*\*

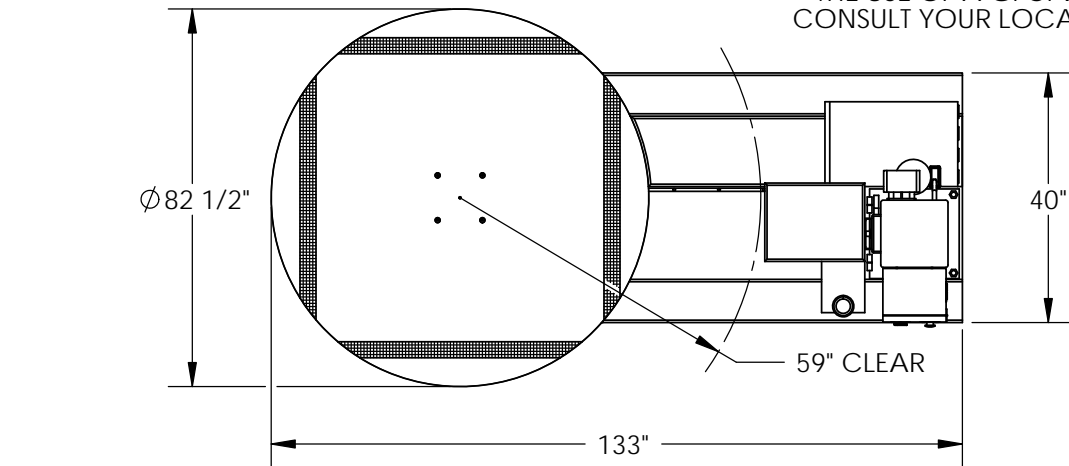

CONTAINER/LOAD MUST BE AT LEAST 20" HIGH

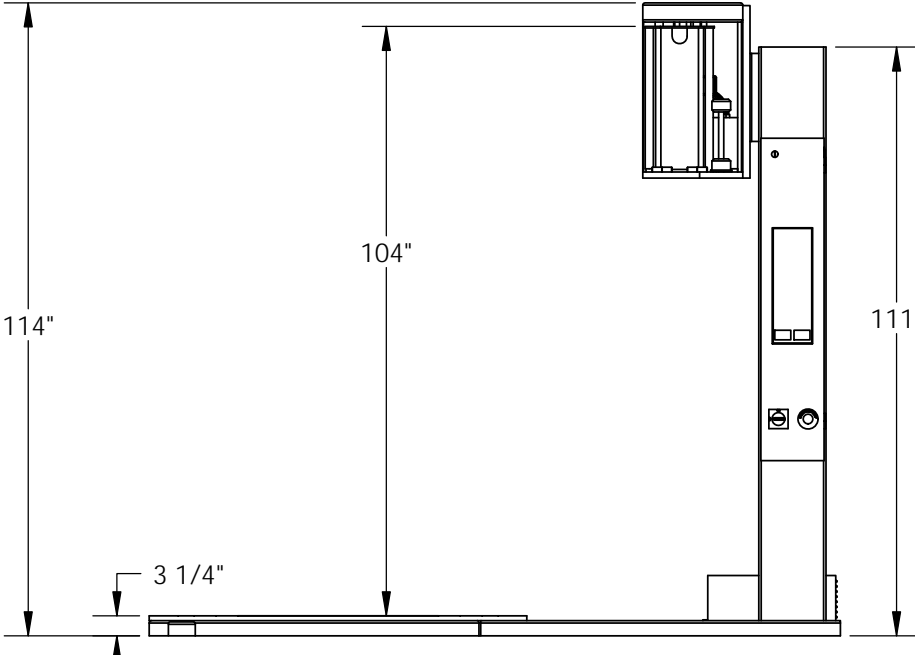

\*115V SUPPLY VOLTAGE;  
INCLUDES 12' LONG POWER CORD  
WITH NEMA 5-15 PLUG  
\*10A AT FULL LOAD

FOR INTERNAL USE ONLY PROJECT SIGN OFF	
SALES	
ENG.	
FAB.	
POWER	

ALL GRAPHICS PROVIDED ARE FOR REFERENCE ONLY. IF CERTAIN DIMENSIONS ARE CRITICAL PLEASE VERIFY THOSE DIMENSIONS WITH YOUR SALESPERSON

DIMENSION TOLERANCE ± 1/4"

STANDARD FEATURES

- MODEL NUMBER IS: SWA-82-AW
- CAPACITY IS: 4,000 LBS.
- OVERALL WIDTH IS: 82 1/2"
- OVERALL LENGTH IS: 133"
- OVERALL HEIGHT IS: 111"
- 82 1/2" DIAMETER TOP PLATE
- VARIABLE SPEED CONTROL, 0-13 RPM
- CAN HANDLE FILM ROLLS UP TO 20" LONG
- WRAPS DOWN TO 3" ABOVE TURNTABLE
- CRATE SIZE: 84" x 134" x 24" TALL

SPECIAL FEATURES

NONE

APPROVAL

I, THE UNDERSIGNED, AGREE THAT THE PRODUCT AS REPRESENTED SATISFIES DESIGN AND DIMENSION REQUIREMENTS. I ALSO ACKNOWLEDGE MY DUTY TO CONFIRM PRODUCT AND INSTALLATION COMPLIANCE WITH ALL APPLICABLE FEDERAL, STATE AND LOCAL REGULATIONS AND STANDARDS.  
**ALL SPECIAL UNITS ARE NON-RETURNABLE**  
[ ] As drawn [ ] As marked  
Signed: \_\_\_\_\_ Date: \_\_\_\_\_  
LEAD TIME WILL START UPON RECEIPT OF SIGNED APPROVAL DRAWING

DISTRIBUTOR'S NAME:		P.O.#
VESTIL MANUFACTURING		X
DRAWN BY: TJM		W.O.#
DATE: 11/08/10		X
REFERENCE: X	SCALE: NTS	SALES: X
QUOTED LEAD TIME: X	QUOTE # X	FILE NAME:
		20-007-104-003