

SEMI-AUTOMATIC STRETCH WRAP MACHINE RAMP - SWA-R-48100-SCL

APPROX WEIGHT: 447.21 lbs.
DOES NOT INCLUDE WEIGHT OF POWER OR PACKAGING!!!

ANY ADDITIONS, DELETIONS, OR OMISSIONS MUST BE CORRECTED ON THIS DRAWING AS THIS DRAWING WILL BE CONSIDERED ALL INCLUSIVE

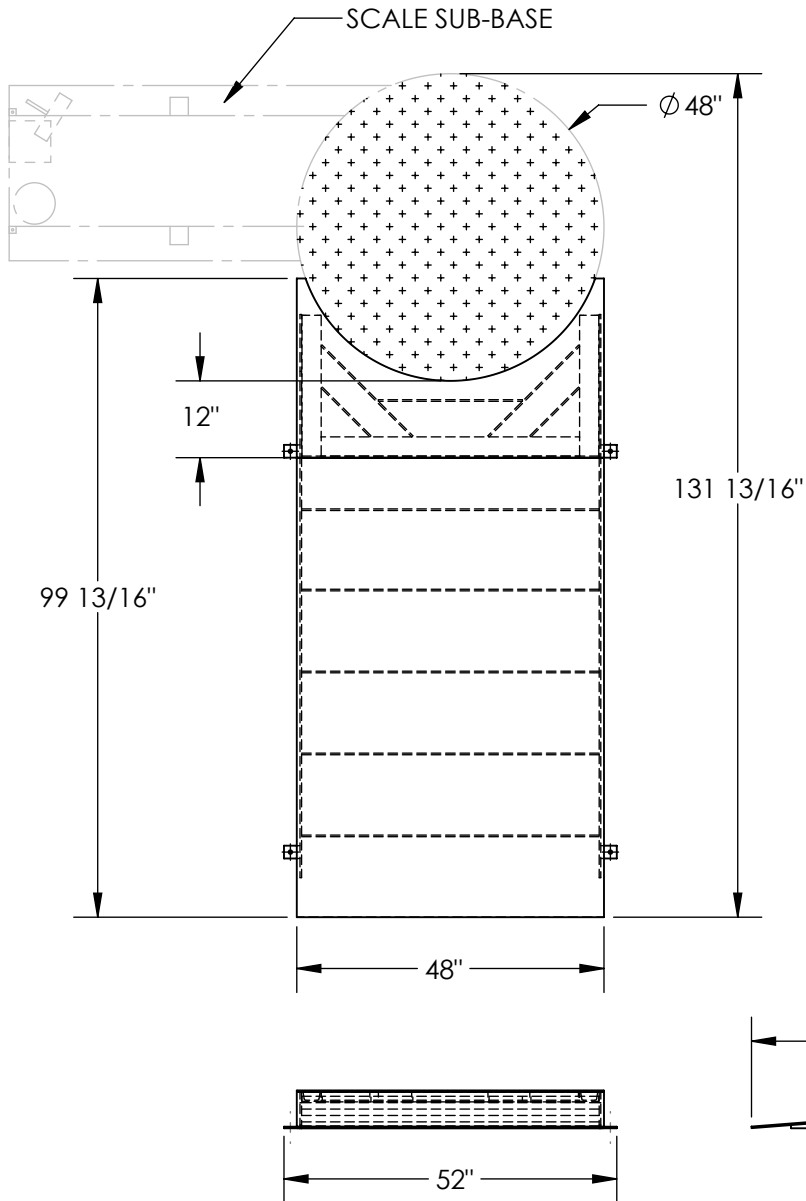

IT IS THE END USER'S RESPONSIBILITY
TO DETERMINE IF THIS RAMP WILL
FUNCTION WITH THEIR PALLET JACK

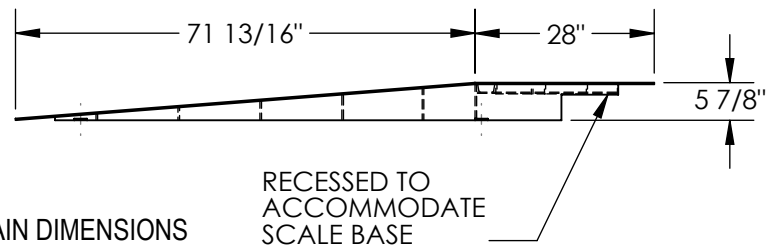
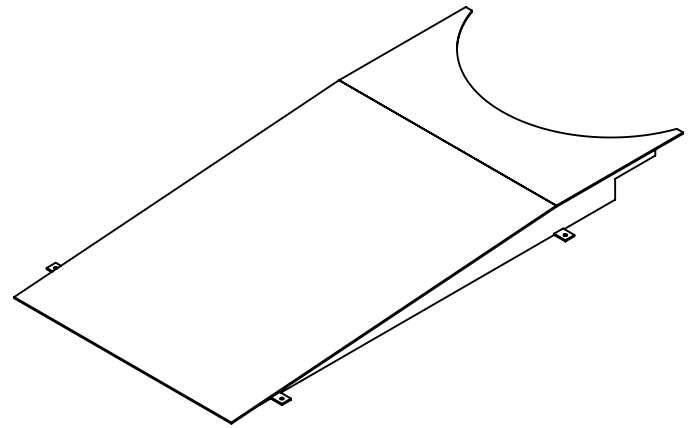

RECESSED TO
ACCOMMODATE
SCALE BASE

DIMENSION TOLERANCE $\pm 1/4"$

ALL GRAPHICS PROVIDED ARE FOR REFERENCE ONLY. IF CERTAIN DIMENSIONS
ARE CRITICAL PLEASE VERIFY THOSE DIMENSIONS WITH YOUR SALESPERSON

STANDARD FEATURES

MODEL NUMBER IS SWA-R-48100-SCL
CAPACITY IS: 4,000 LBS.
OVERALL WIDTH IS: 52"
USABLE WIDTH IS: 48"
OVERALL LENGTH IS: 99 13/16"
OVERALL HEIGHT IS: 5 7/8"
LEVEL OFF: 28"
FOR USE ON A SWA-48 W/SCALE OPTION
(NOT INCLUDED)

SPECIAL FEATURES

NONE

APPROVAL

I, THE UNDERSIGNED, AGREE THAT THE PRODUCT AS
REPRESENTED SATISFIES DESIGN AND DIMENSION
REQUIREMENTS. I ALSO ACKNOWLEDGE MY DUTY TO
CONFIRM PRODUCT AND INSTALLATION
COMPLIANCE WITH ALL APPLICABLE FEDERAL, STATE
AND LOCAL REGULATIONS AND STANDARDS.
ALL SPECIAL UNITS ARE NON-RETURNABLE
[] As drawn [] As marked

Signed: _____ Date: _____

LEAD TIME WILL START UPON RECEIPT
OF SIGNED APPROVAL DRAWING

DISTRIBUTOR'S NAME:		P.O.#
VESTIL MANUFACTURING		X
DRAWN BY: TJM		W.O.#
DATE: 07/16/13		X
REFERENCE: X	SCALE: 1:30	SALES: X
QUOTED LEAD TIME: X	QUOTE #	FILE NAME:
	X	20-007-130