

# ADJUSTABLE MACHINERY SKATE - ASKT-6

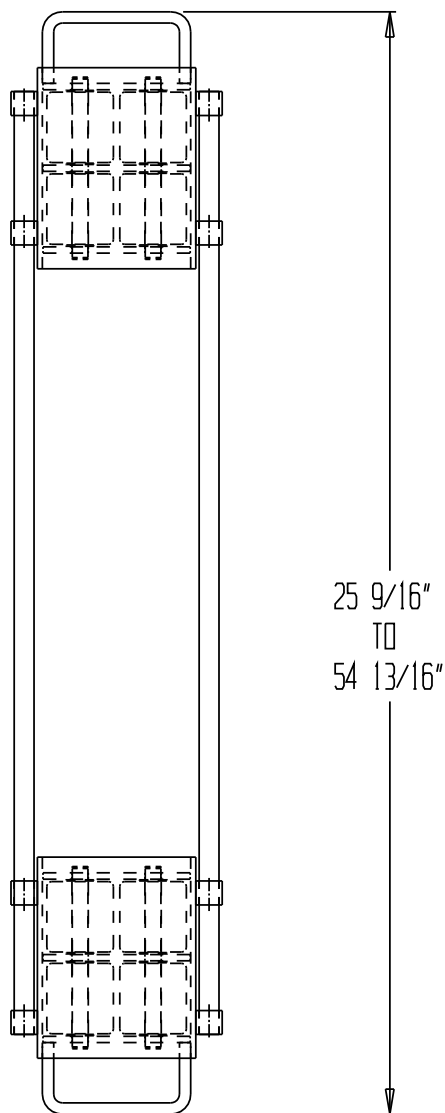

## STANDARD FEATURES

MODEL NUMBER: ASKT-6  
CAPACITY: 12,000 LBS  
INDIVIDUAL SKATE DIMENSIONS:  
12 13/16" x 10 1/2" x 4 3/8"  
8 NYLON ROLLERS (4 PER SKATE)

## SPECIAL FEATURES

NONE

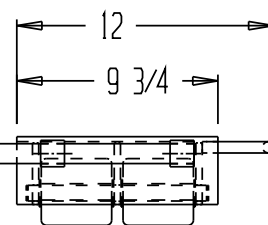
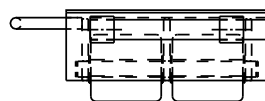
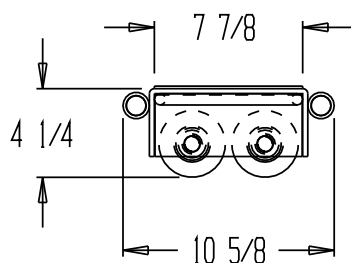

PRODUCTION WILL START UPON  
RECEIPT OF SIGNED APPROVAL  
DRAWING

## APPROVAL

I, the undersigned, hereby approve this print

☐ As drawn ☐ As marked

This includes my approval of design & dimensions.

Signed: \_\_\_\_\_

Date: \_\_\_\_\_

\*\*SPECIAL UNITS ARE NON-RETURNABLE

\*AVAILABLE AT ADDITIONAL COSTS

DISTRIBUTOR'S NAME:

**T & S EQUIPMENT**

P.O.#: \_

W.O.#: \_

DRAWN BY: KY

DATE: 9/13/04

SALES:

REFERENCE:

DRWG./FILE NAME:

-

scale: 1:10

33-007-126