

PRIME DESIGN™

A Safe Fleet Brand

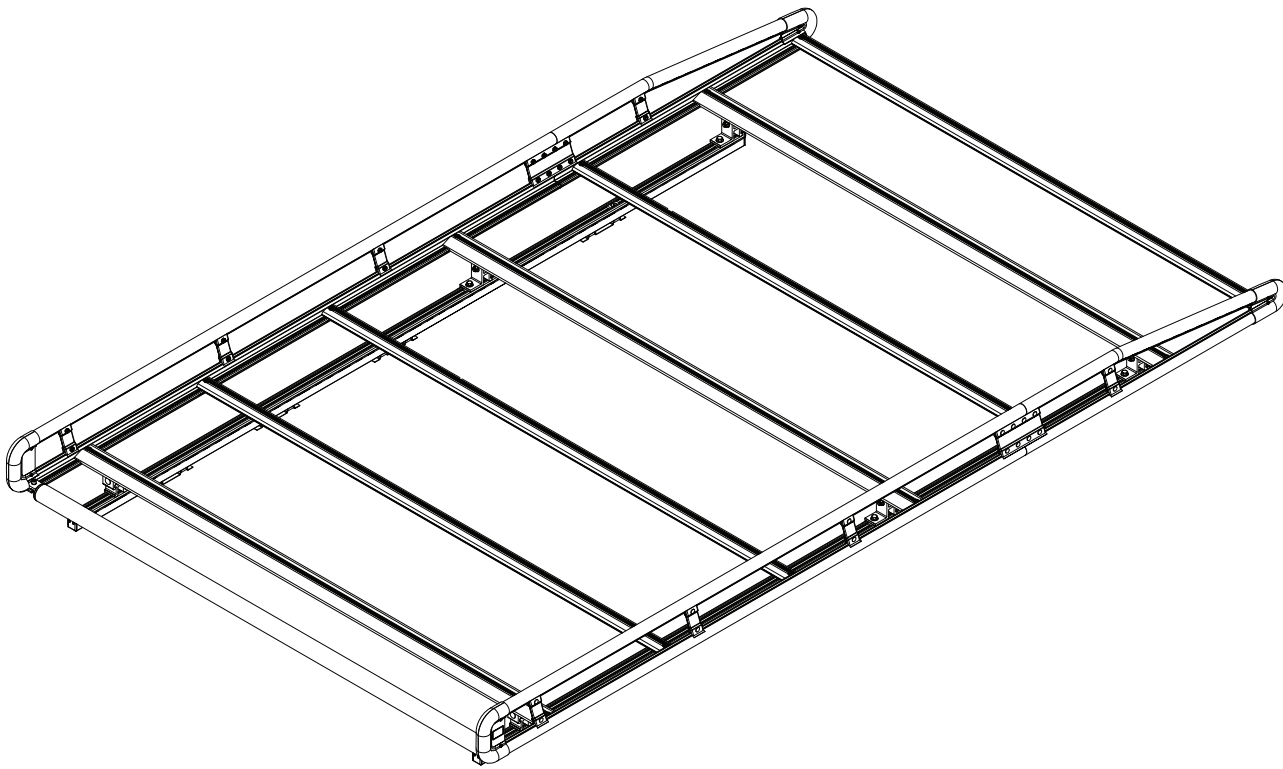

AR1901

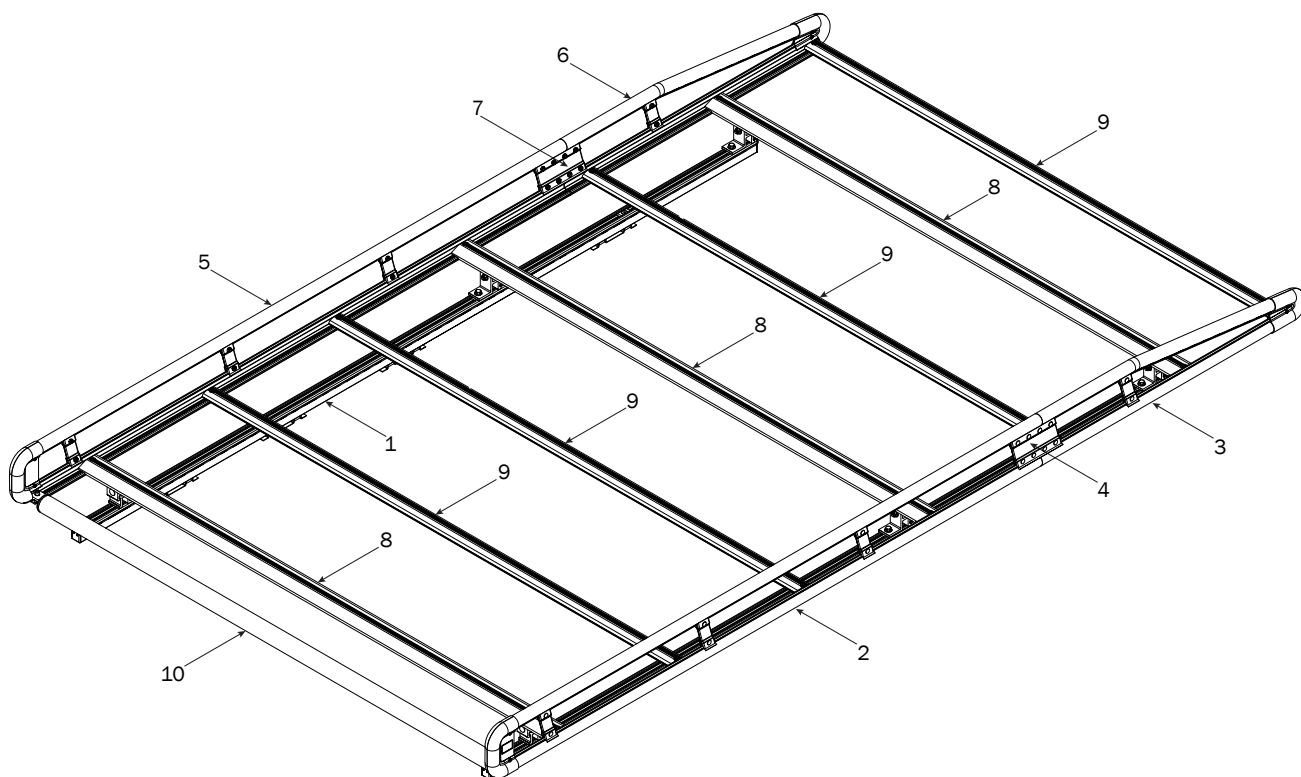

- 1—FBM3-0049-A..... (Qty 2)
Channels with hardware



Channels (2X)

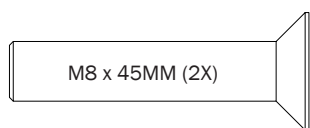

M8 x 45MM (2X)

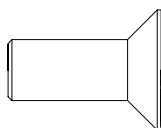

M8 x 20MM (14X)

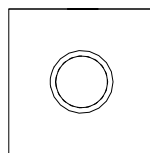

Square Nut (16X)

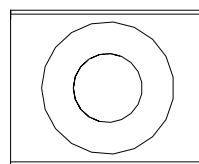

T Slot Insert (14X)

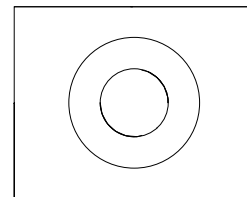

Channel Strip (2X)



End Caps (4X)



Screws (8X)



Brackets (6X)

- 2—Side Rail Assembly..... (Qty 1)
Rear, Right Hand, 76.00"

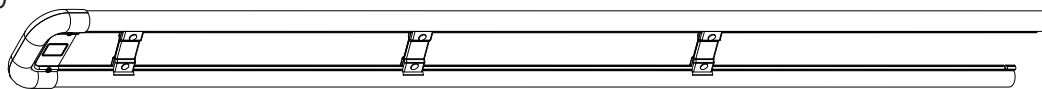

- 3—Side Rail Assembly..... (Qty 1)
Front, Right Hand, 36.00"

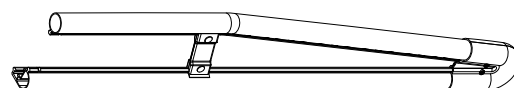

- 4—Side Rail Connector (Qty 1)
Right Hand, 6.00"

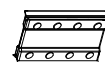

- 5—Side Rail Assembly (Qty 1)
Rear, Left Hand, 76.00"

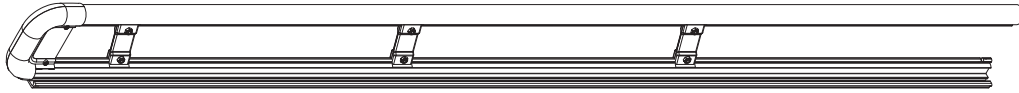

- 6—Side Rail Assembly (Qty 1)
Front, Left Hand, 36.00"

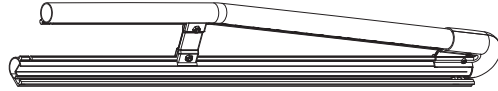

- 7—Side Rail Connector (Qty 1)
Left Hand, 6.00"

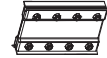

- 8—AluRack Construction Crossbar (Qty 3)
With hardware, 67.00"



- 9—AluRack Standard Crossbar (Qty 4)
With hardware, 67.00"



- 10—Roller Tube Assembly (Qty 1)
With caps, 63.75"



HKT-0082-Hardware Kit

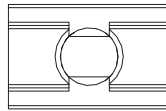

M8 Strip Nut (16X)

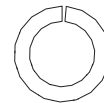

M8 Lock Washer (16X)

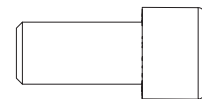

M8 Cap Head Bolt (16X)



Roller Holder (2X)



Roller Tube Pin (2X)

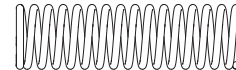

Roller Spring (2X)

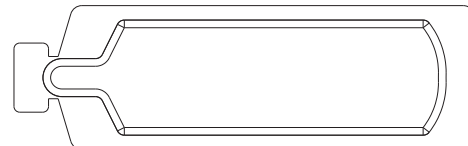

ASZ-0101 (1X)

FBM3-0049 MOUNTING SYSTEM CHANNELS TO ROOF

- 0.1** Assemble Mounts as shown below.

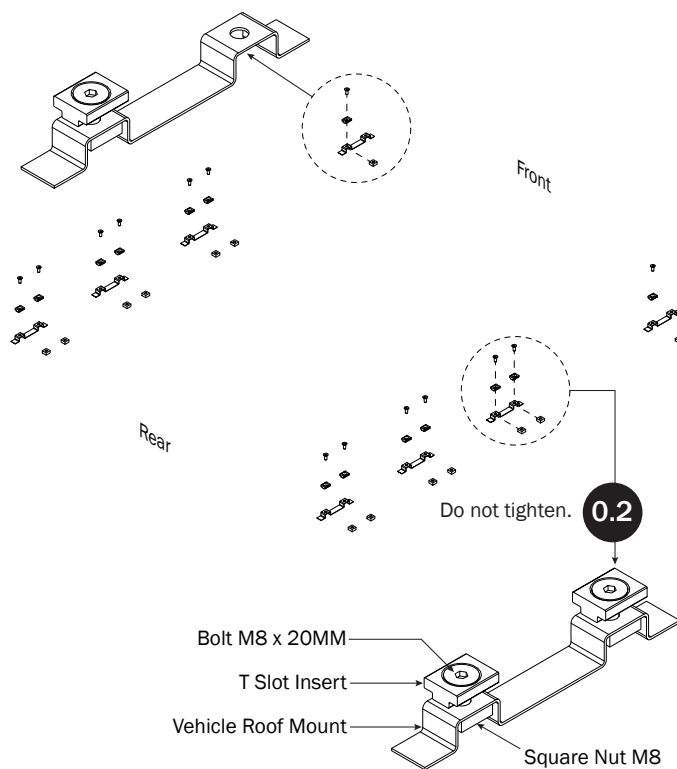

- 0.3** Slide Channels onto roof Mounts and set distances as shown.

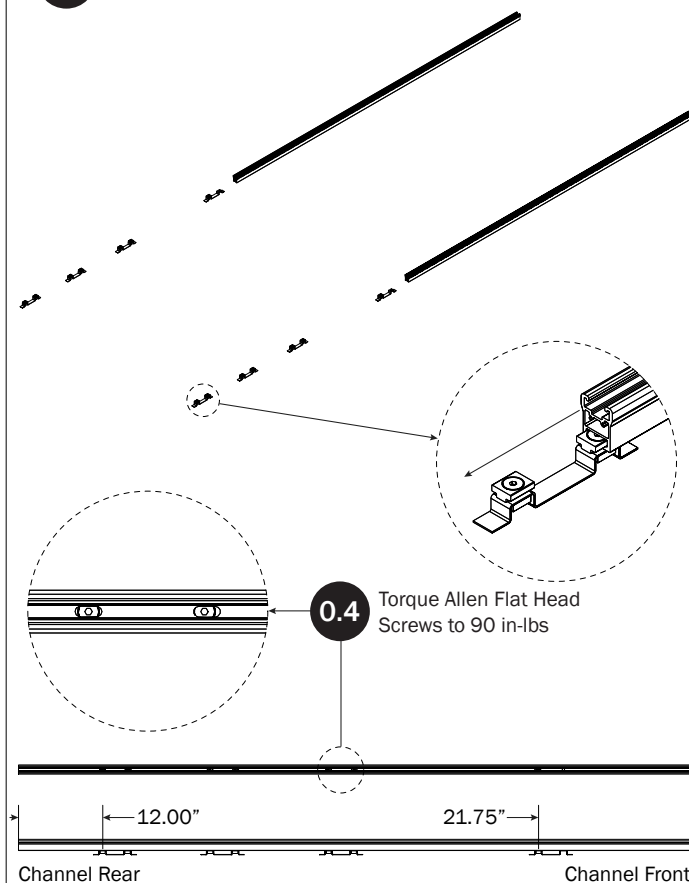

- 0.6** Set to distances then torque Rear Bracket nuts to 90 in-lbs leaving Center and Front Brackets loose until Step 7.5

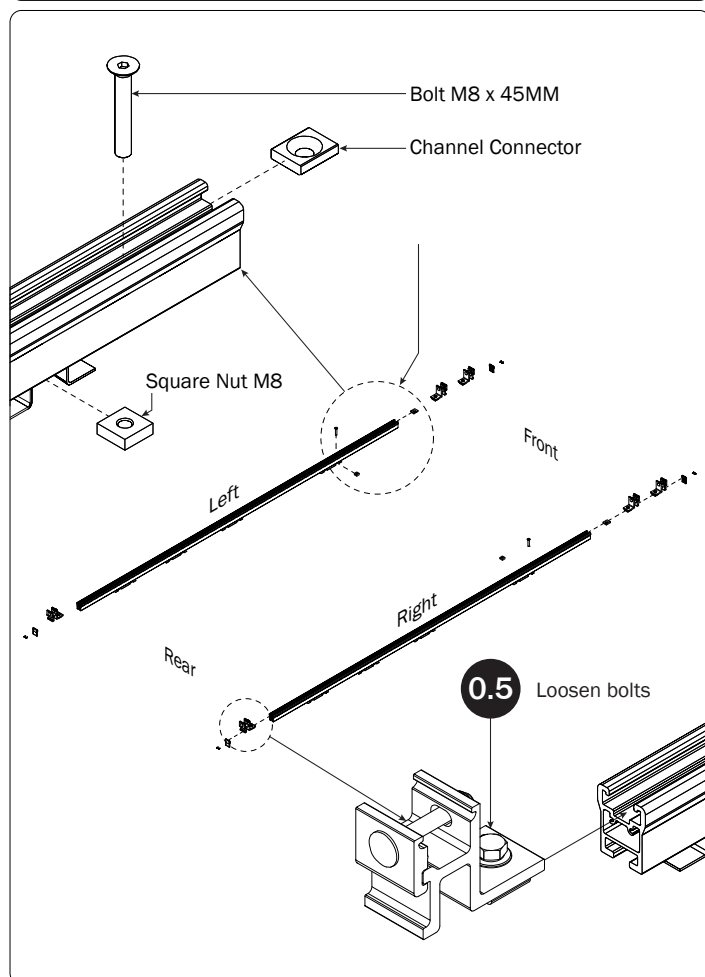
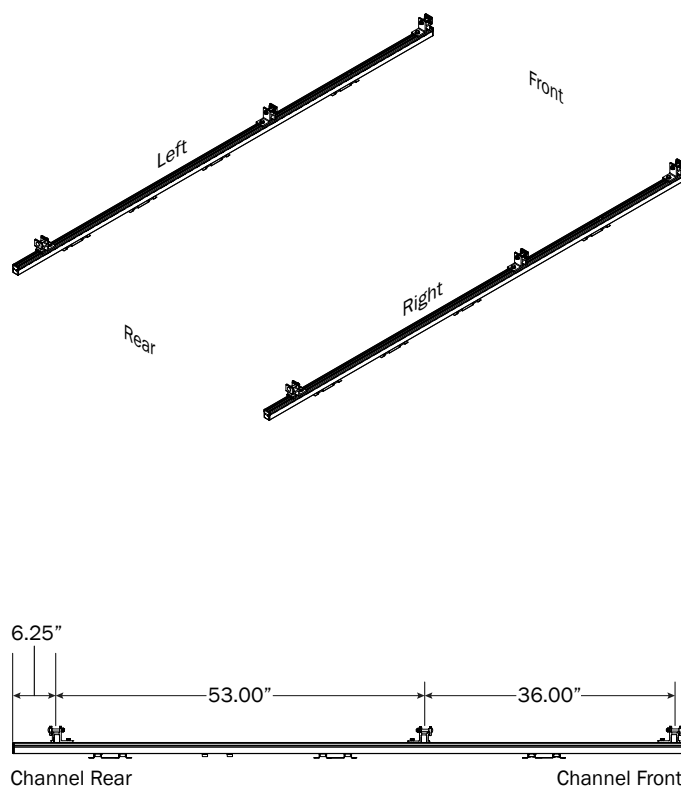

ALURACK ASSEMBLY SEQUENCE

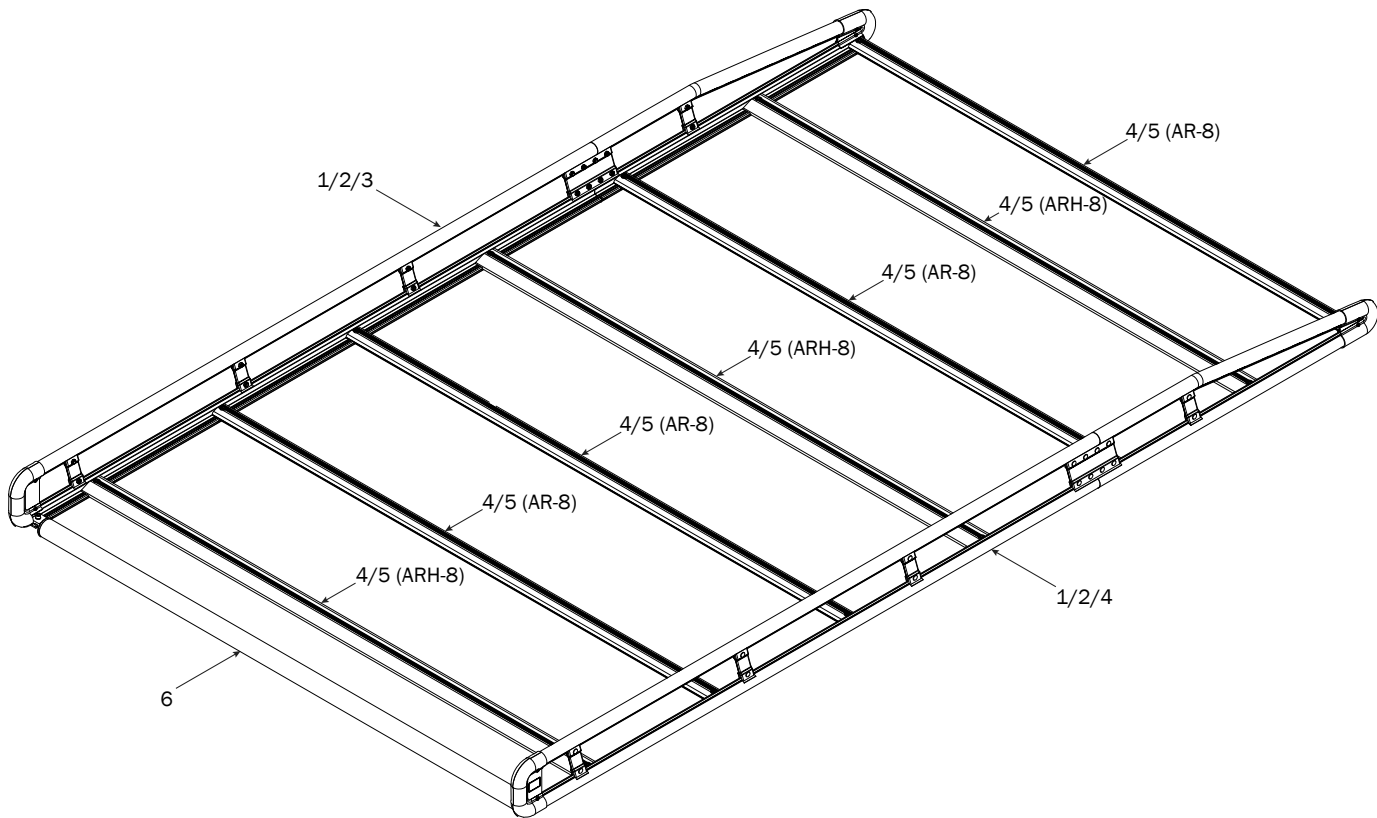

STRIP NUT ASSEMBLY

- 1 Insert Strip Nuts (7x) per side into Side Rails as shown

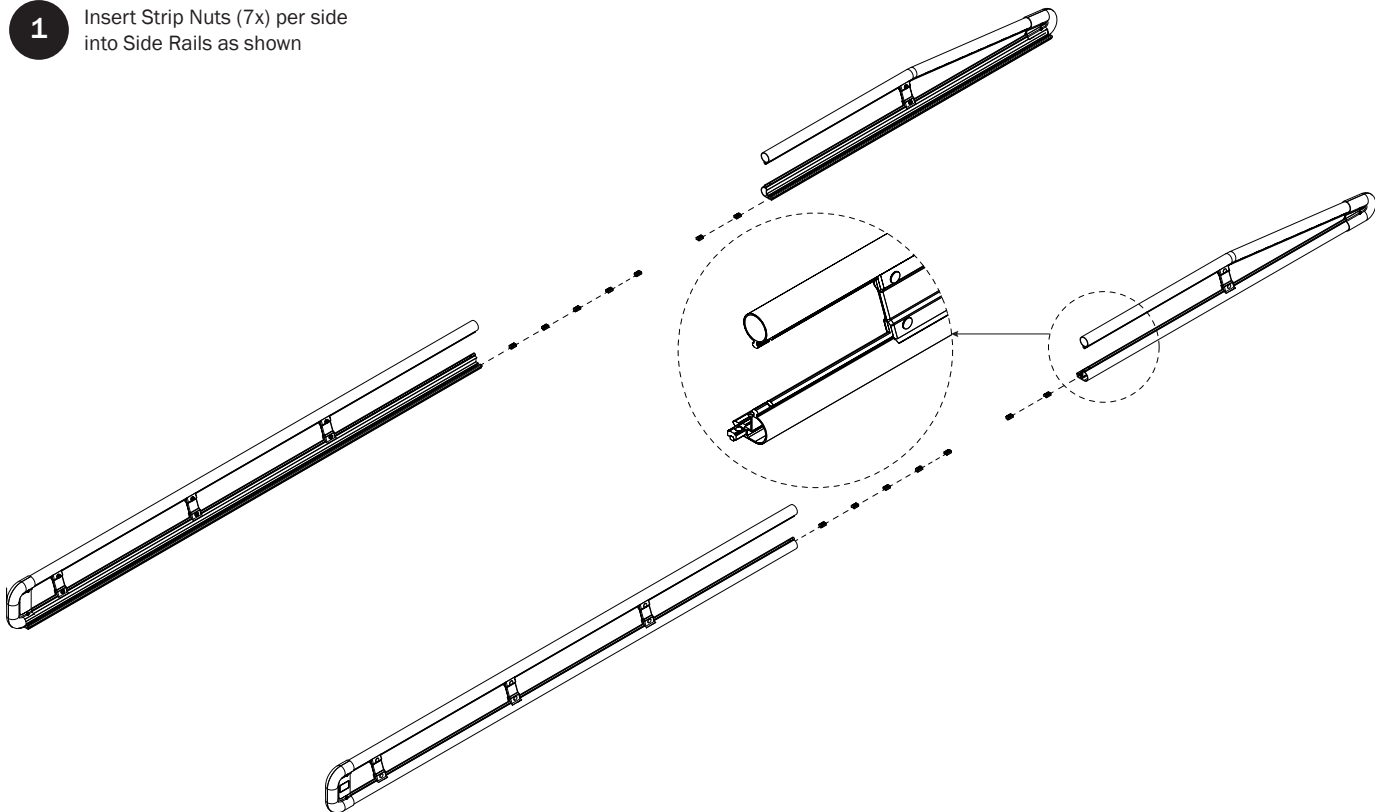

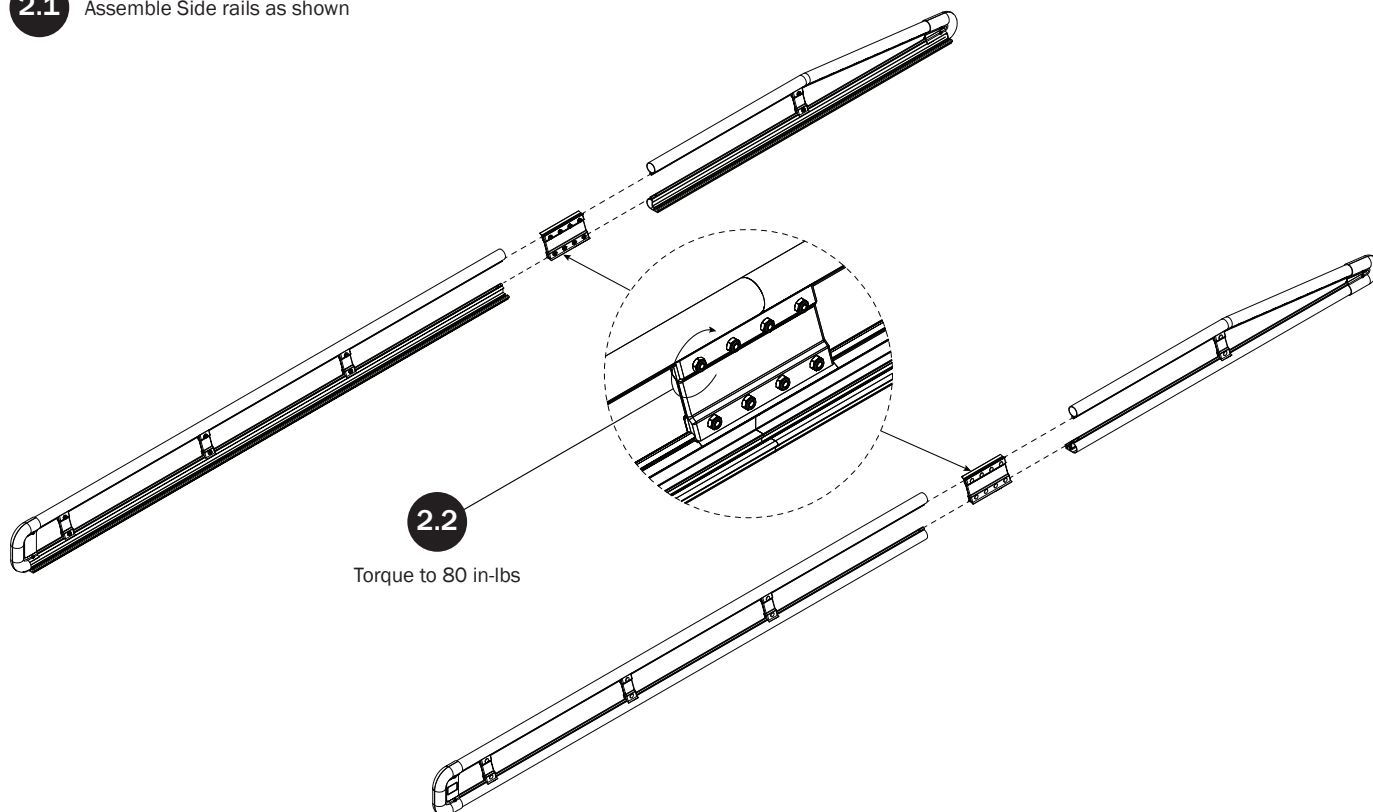
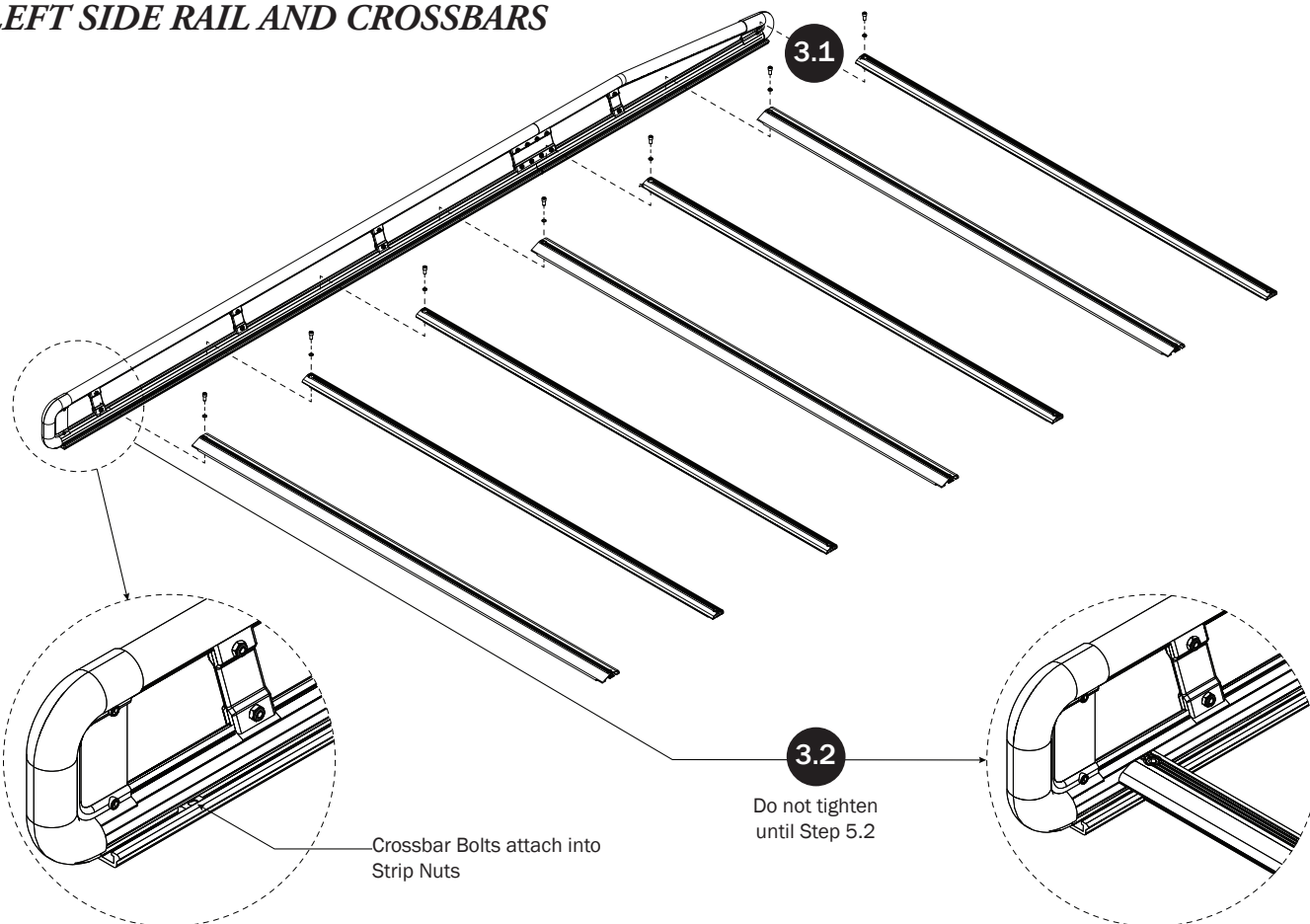
SIDE RAIL ASSEMBLY**2.1** Assemble Side rails as shown***LEFT SIDE RAIL AND CROSSBARS***

RIGHT SIDE RAIL AND CROSSBARS

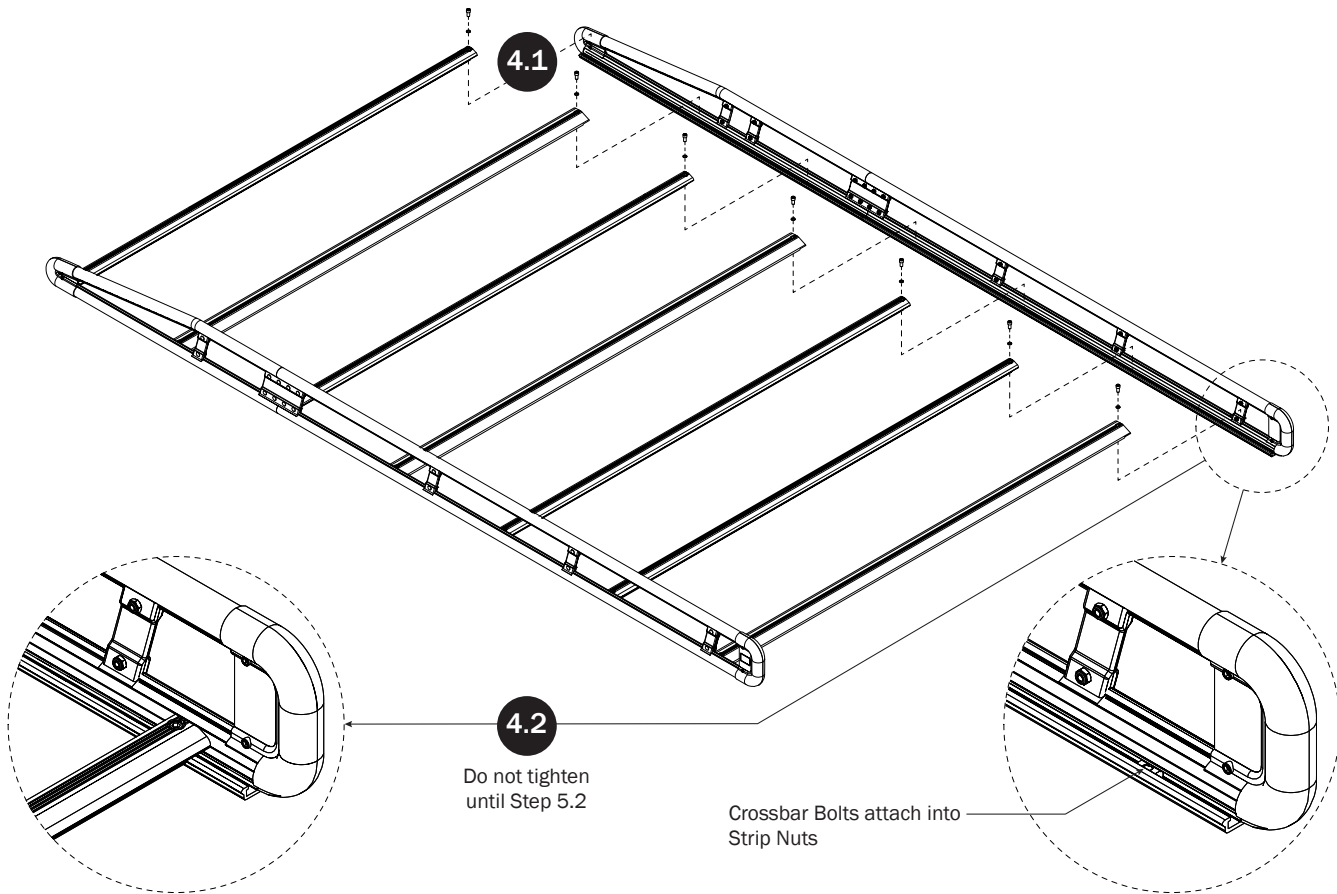

CROSSBAR ADJUSTMENT

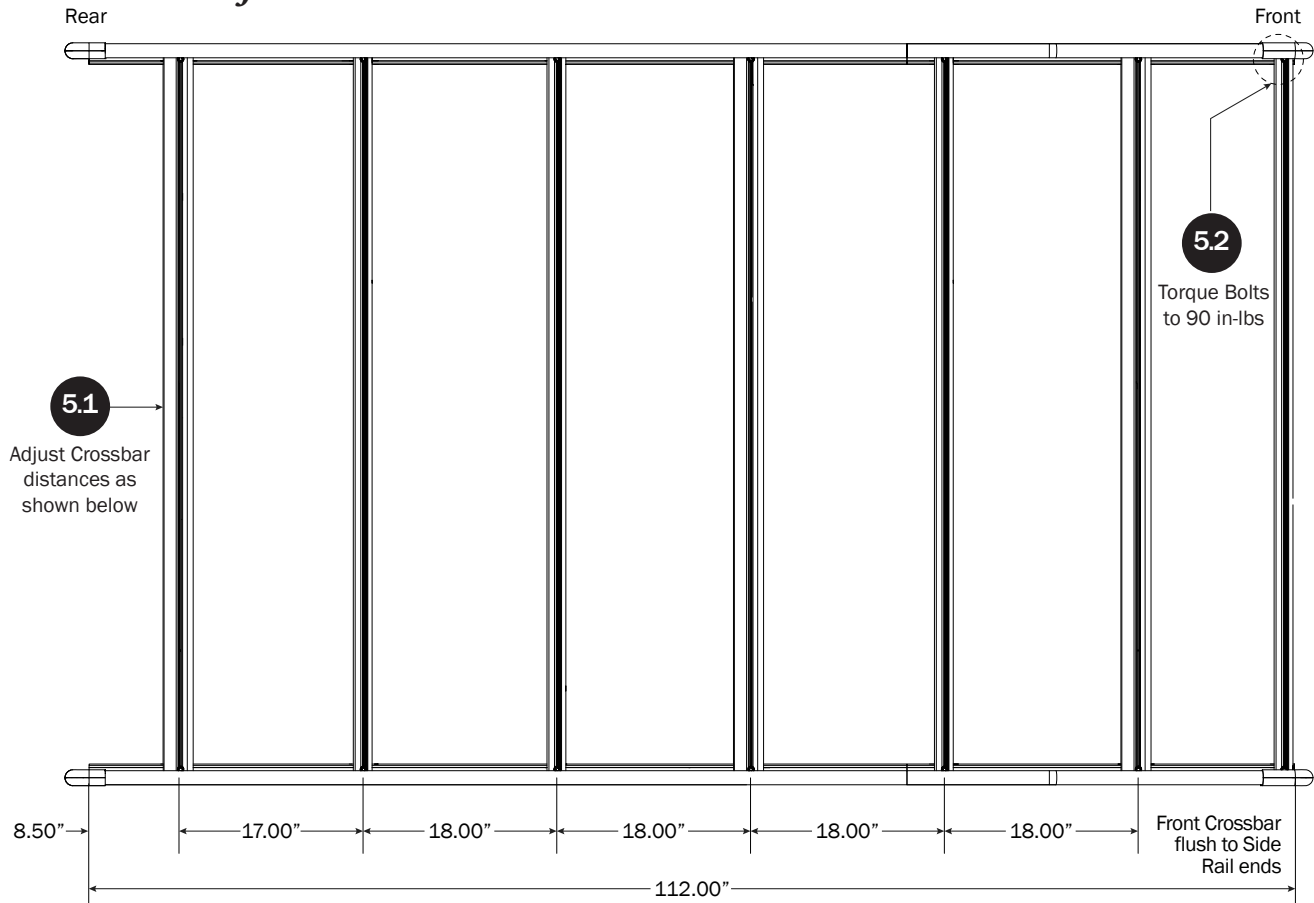

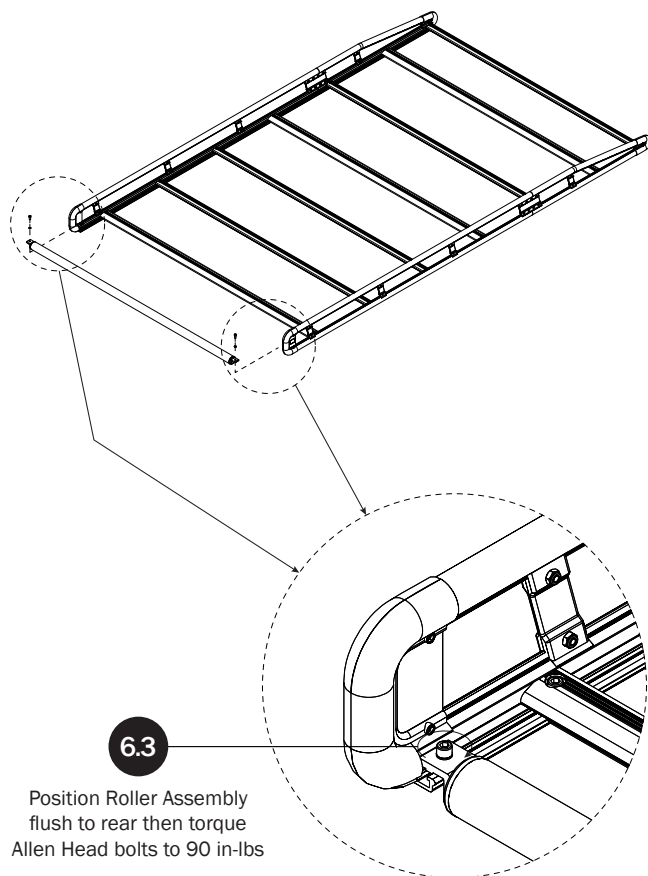
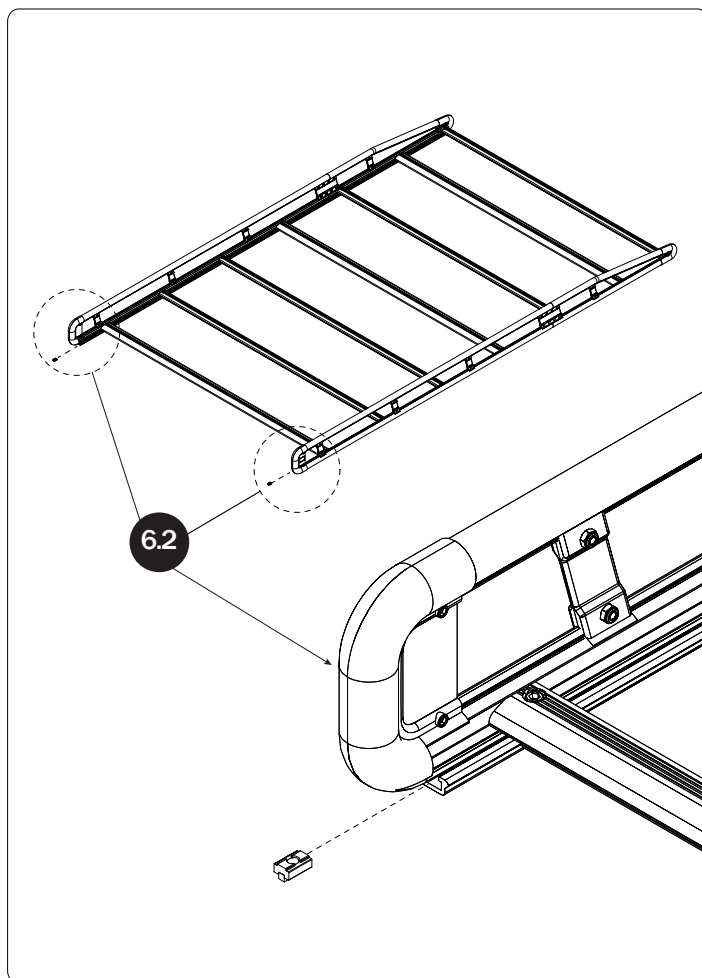
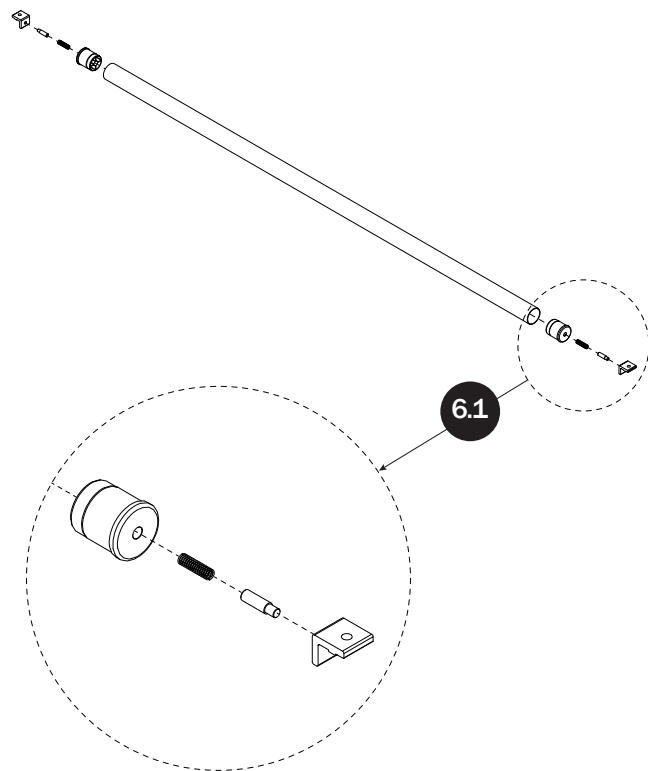
ROLLER ASSEMBLY

MOUNTING RACK TO CHANNELS

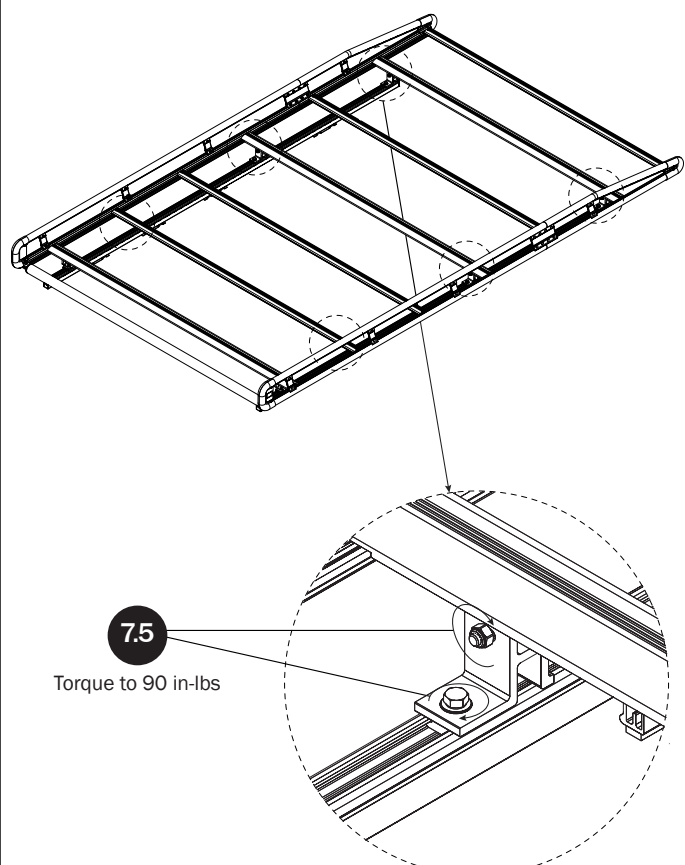
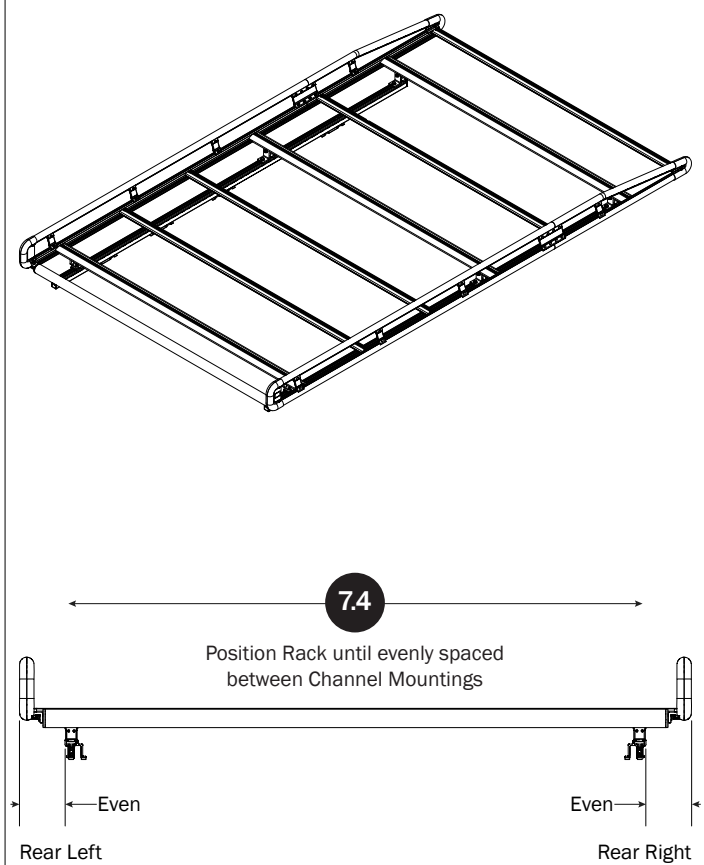
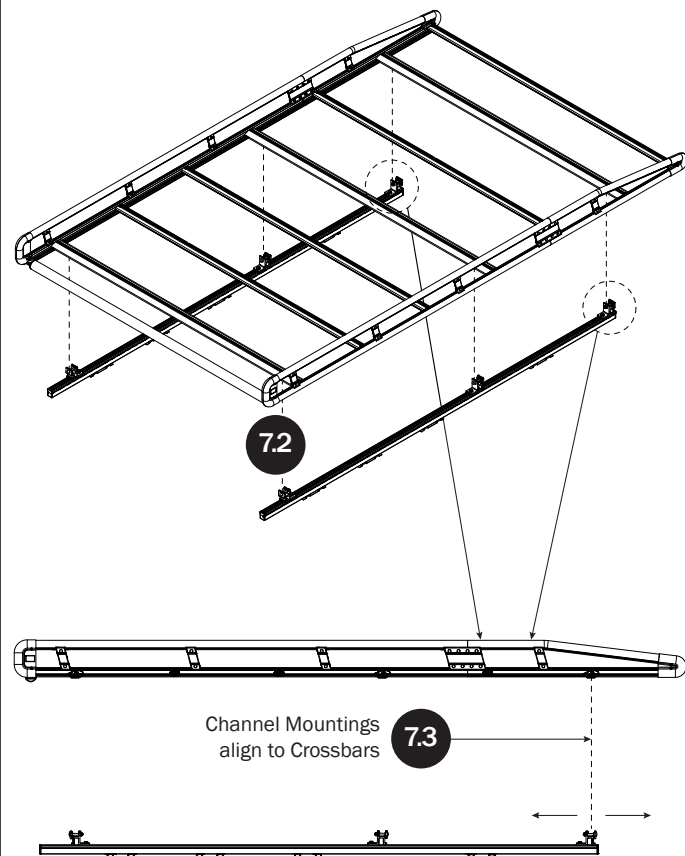
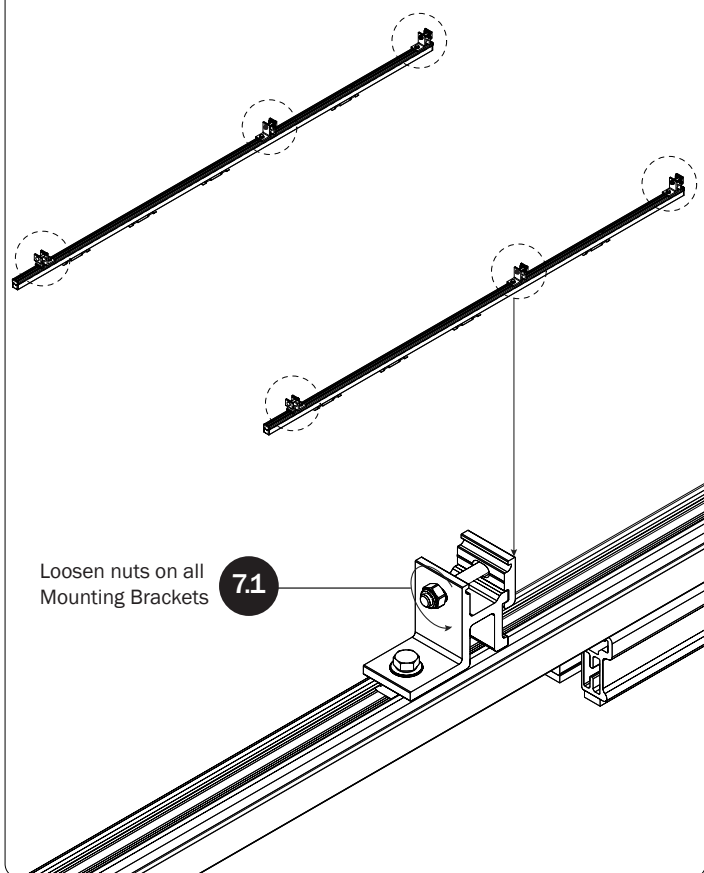

ADDITIONAL INFORMATION

For additional information regarding your AR1901 Ladder Rack, please visit the Prime Design website at: www.primedesign.net.

Using a QR code reader in your smart phone or tablet, read the QR Code shown below and follow the same steps as you would from your laptop or computer.

If you're viewing this document as an interactive PDF, you may simply click on the QR Code below to access the Prime Design website.

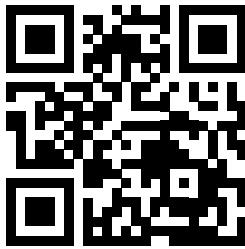

Page Intentionally Left Blank

