

PRIME DESIGN™

A Safe Fleet Brand

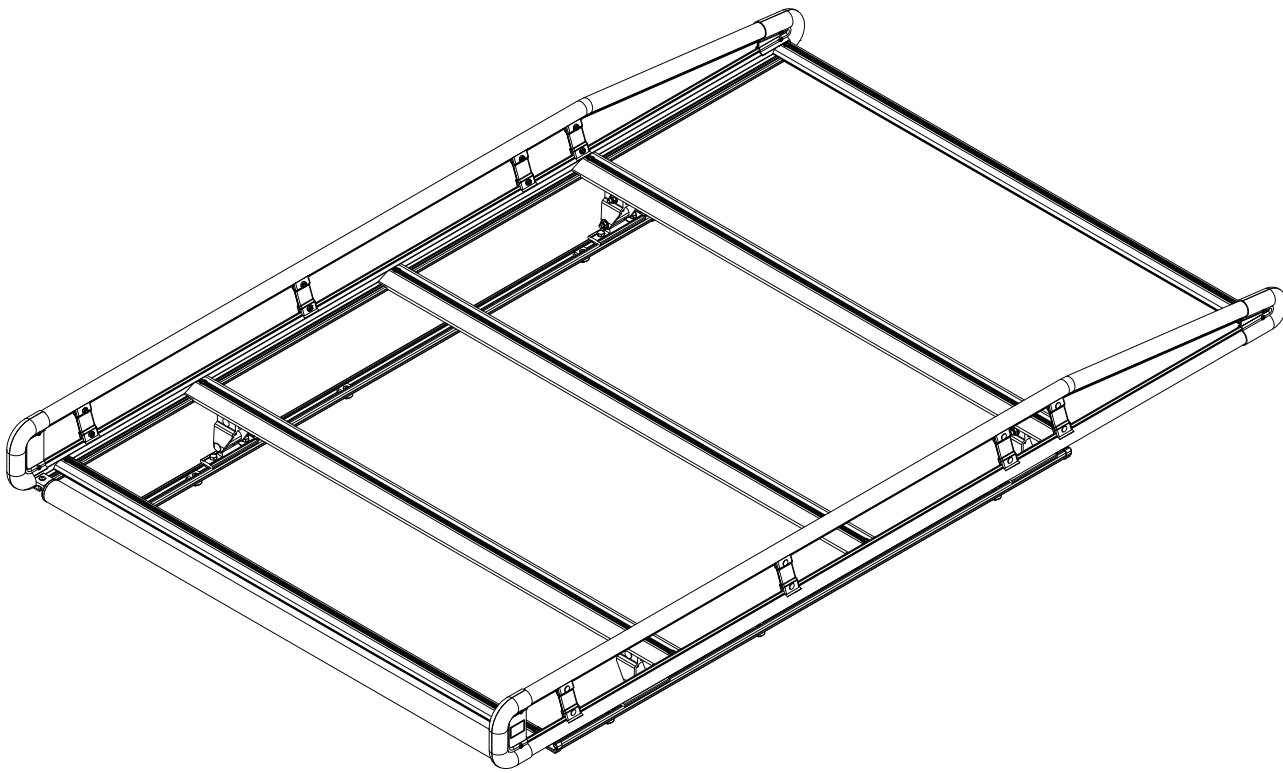

AR1903

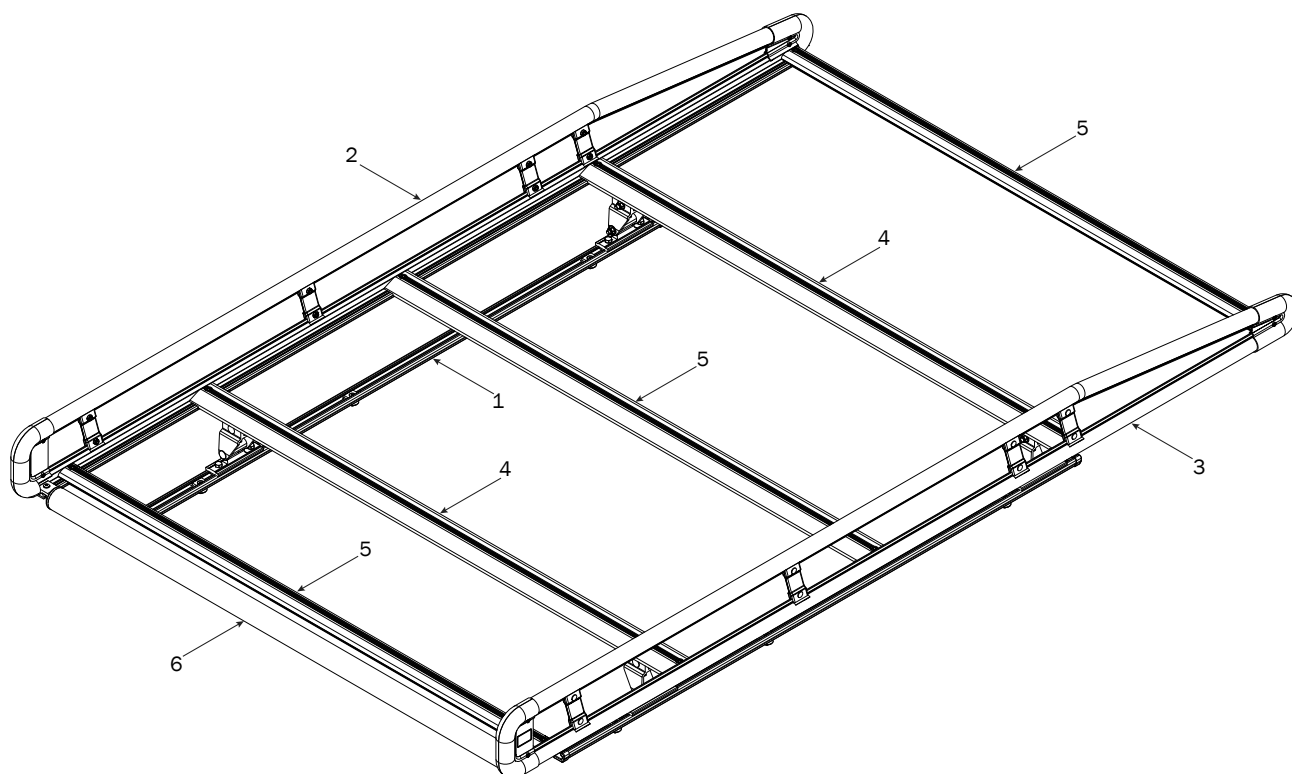

1—Channels (Qty 1)
With hardware



Channels (2X)

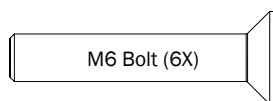

M6 Bolt (6X)

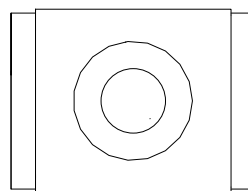

Connect Plate (6X)



M6 Nut (6X)



End Caps (4X)



Brackets (4X)

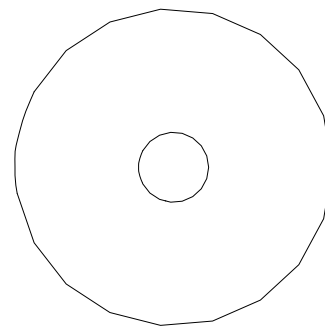

Fender Washer (6X)

2—Side Rail Assembly (Qty 1)
Left Hand, 84.00"

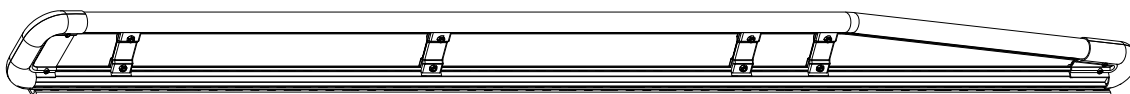

3—Side Rail Assembly (Qty 1)
Right Hand, 84.00"

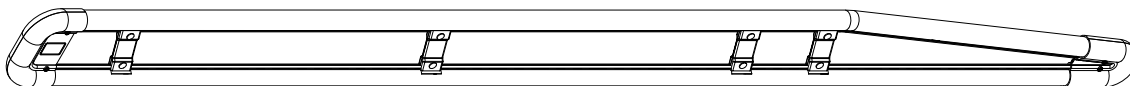

- 4—AluRack Construction Crossbar..... (Qty 3)
With hardware, 53.00"



- 5—AluRack Standard Crossbar (Qty 2)
With hardware, 53.00"



- 6—Roller Assembly (Qty 1)
With hardware, 53.00"



HKT-0080-Hardware Kit

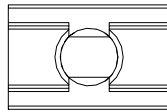

M8 Strip Nut (12X)

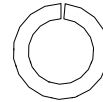

M8 Lock Washer (12X)

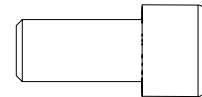

M8 Cap Head Bolt (12X)



Roller Holder (2X)



Roller Tube Pin (2X)

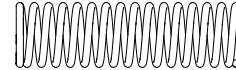

Roller Spring (2X)

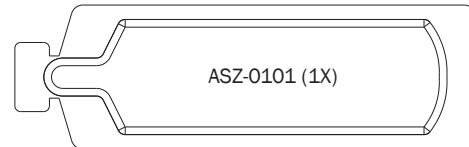

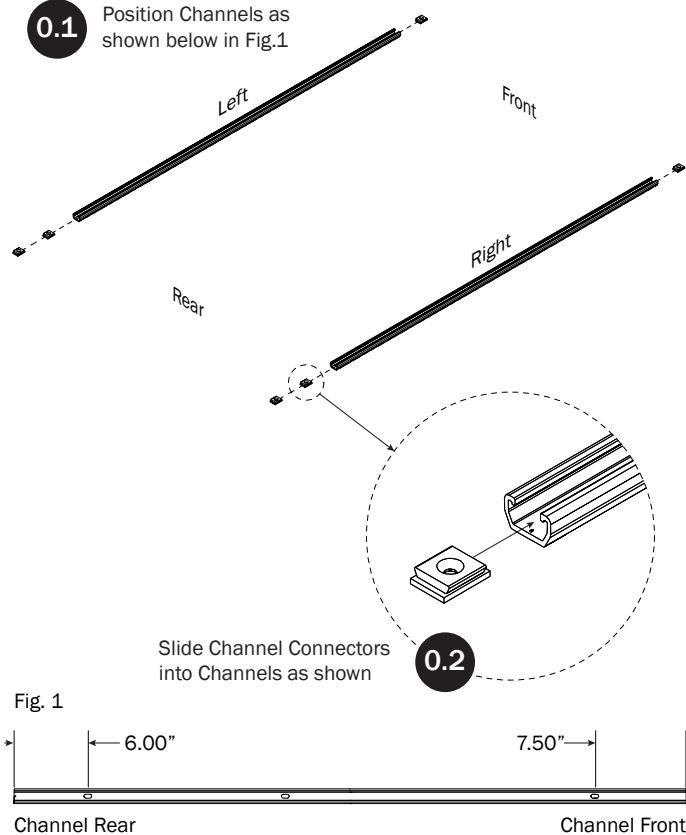
FBM-0008-A
CHANNELS TO ROOF**0.1** Position Channels as shown below in Fig.1

Slide Channel Connectors into Channels as shown

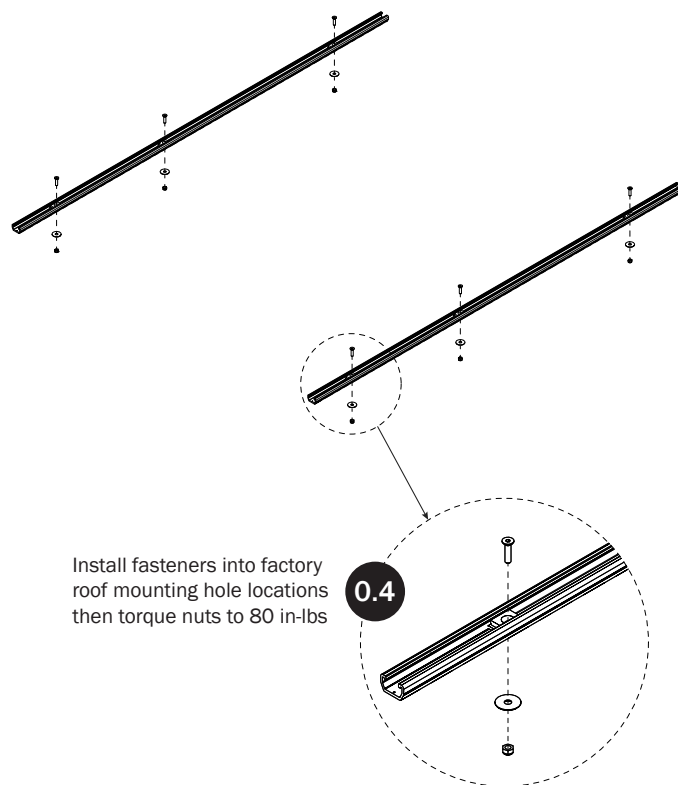
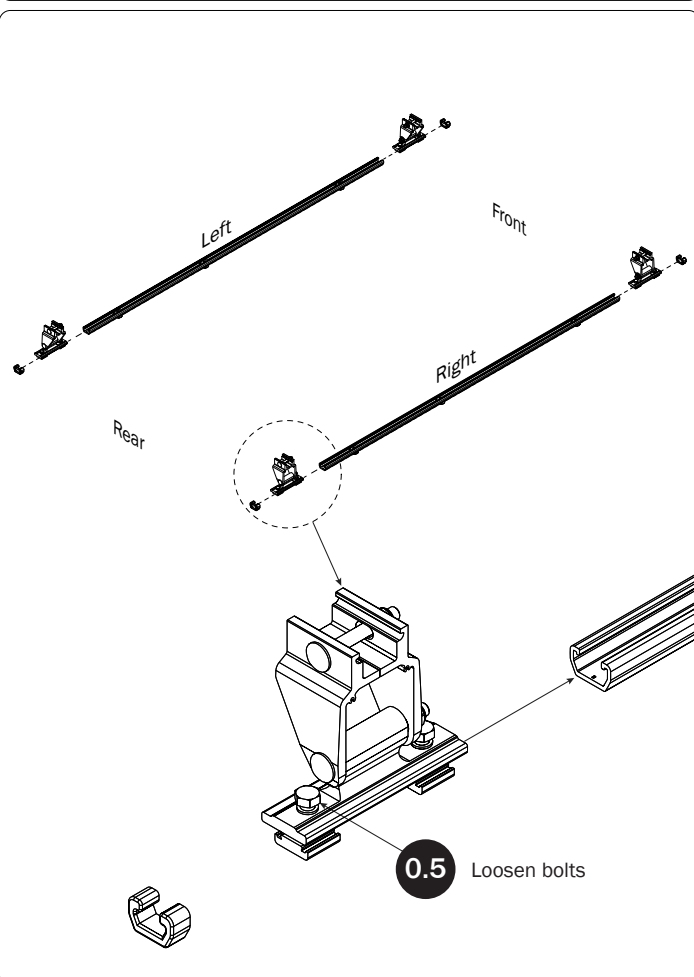
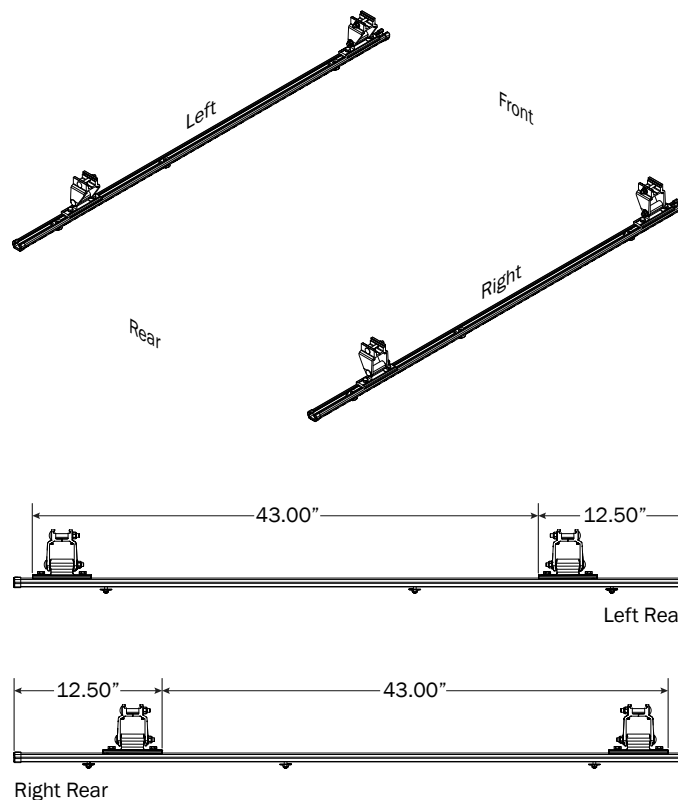
0.2**0.3** Install Channels into roof Channel grooves**0.4****0.6** Set to distances then torque Rear Bracket nuts to 90 in-lbs leaving Front Brackets loose until Step 6.5

CROSSBAR INSTALLATION

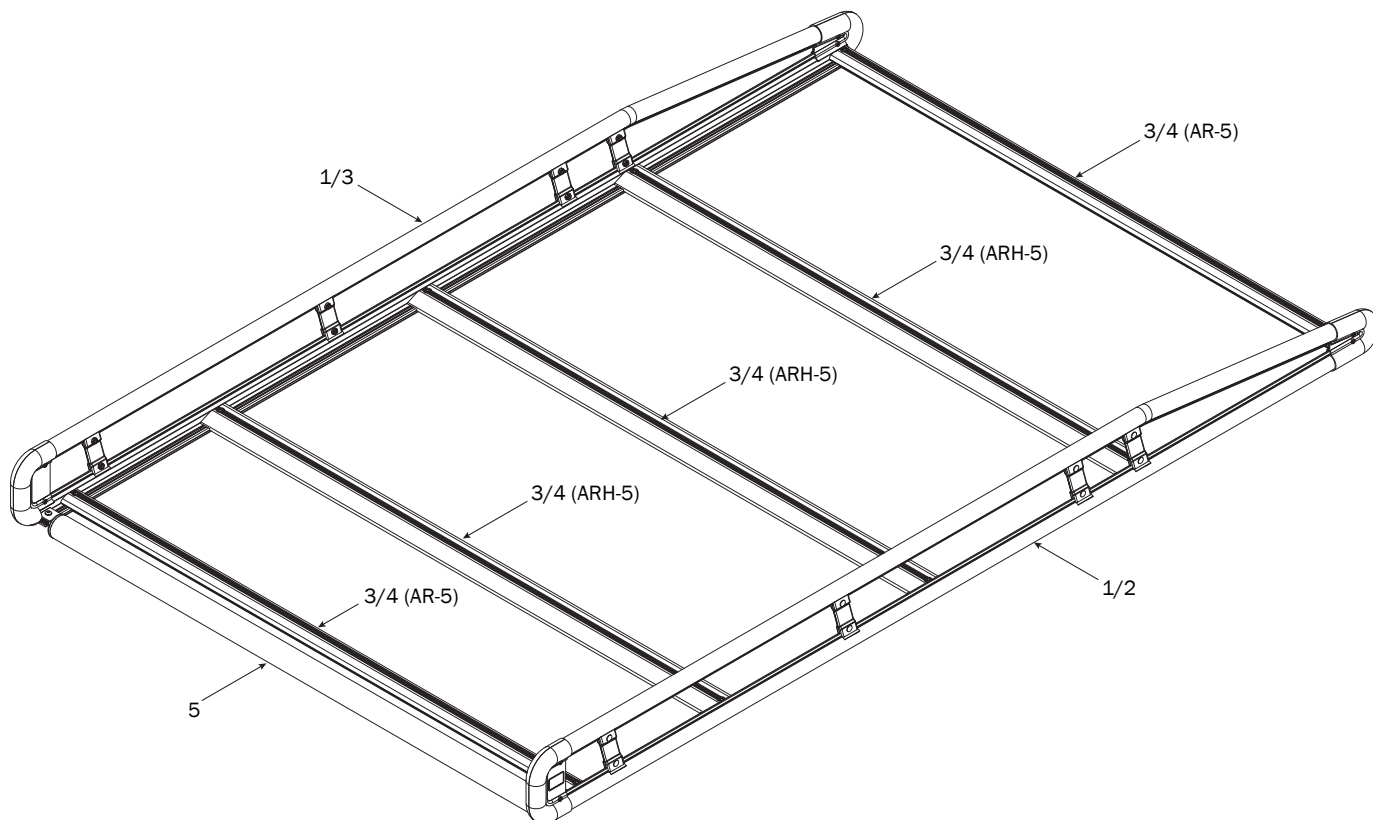

STRIP NUT ASSEMBLY

- 1 Insert Strip Nuts (5x) per side into Side Rails as shown

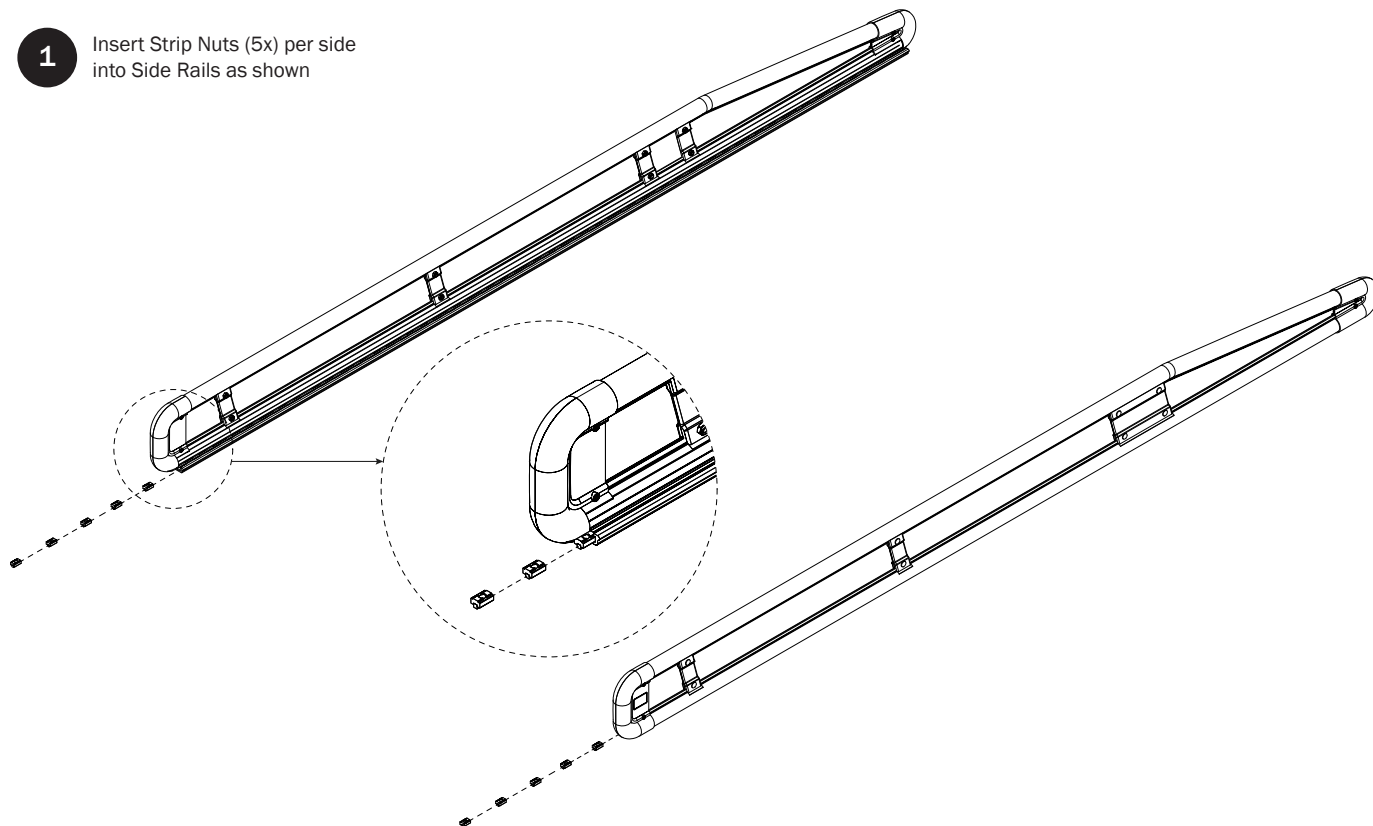

LEFT SIDE RAIL AND CROSSBARS

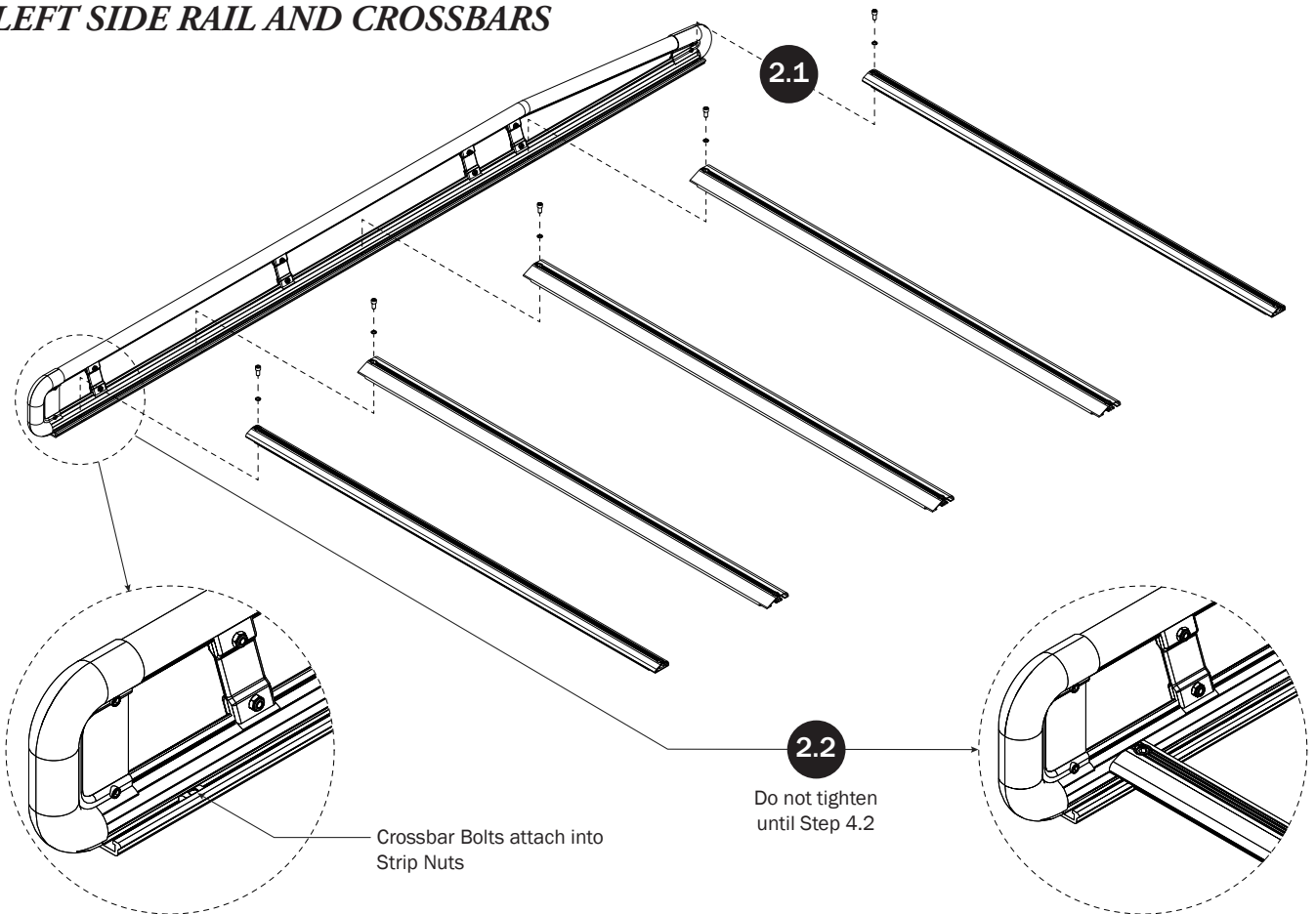

RIGHT SIDE RAIL AND CROSSBARS

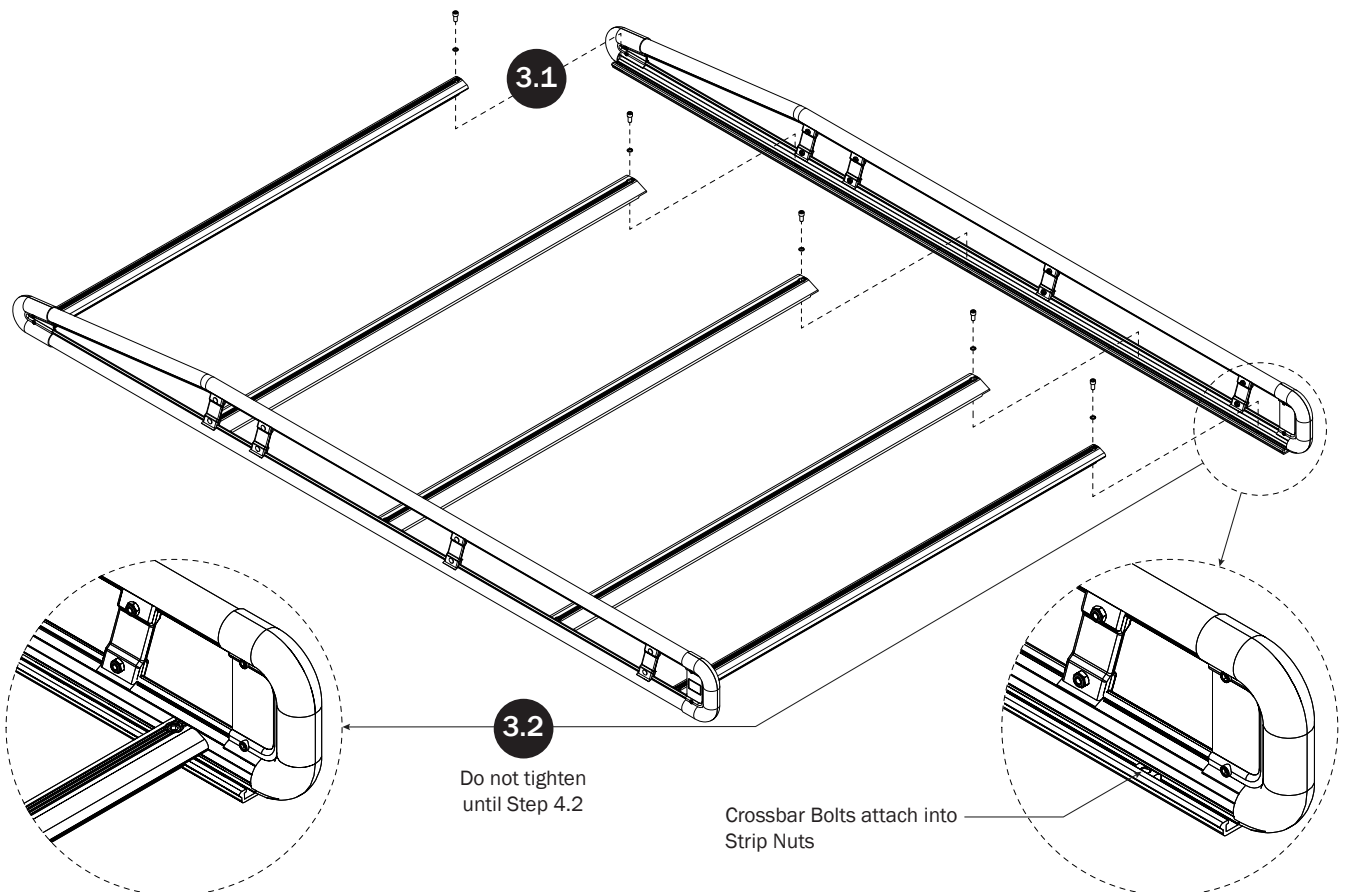

CROSSBAR ADJUSTMENT

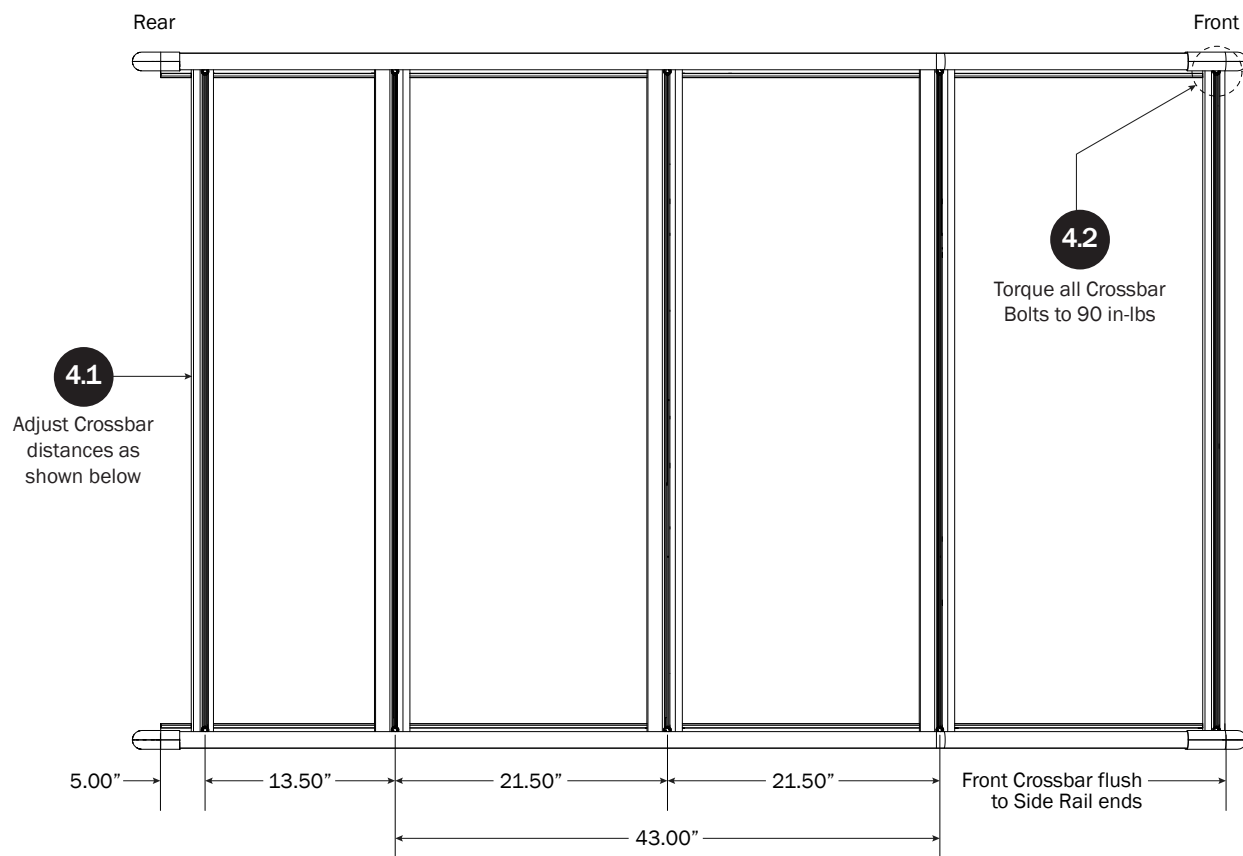

ROLLER ASSEMBLY

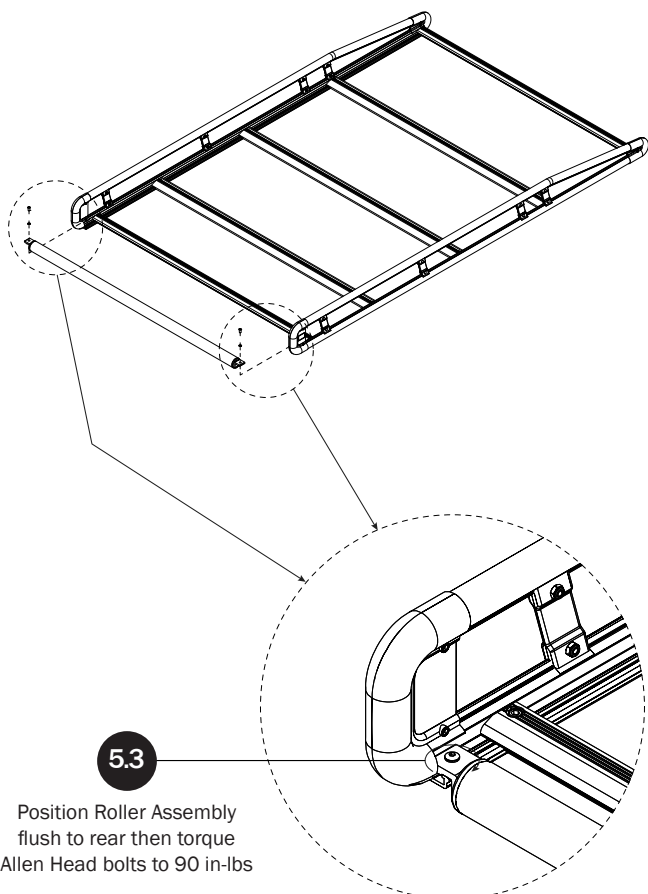
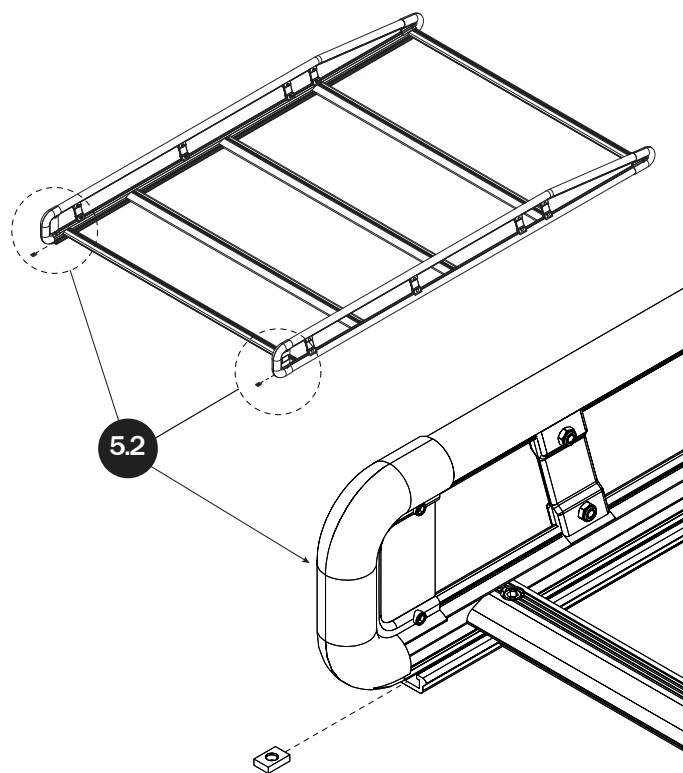
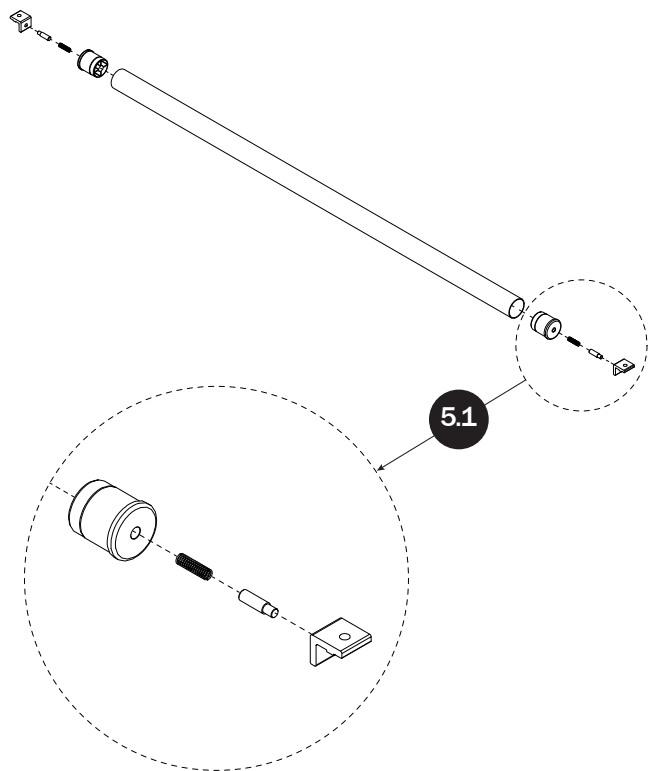

MOUNTING RACK TO CHANNELS

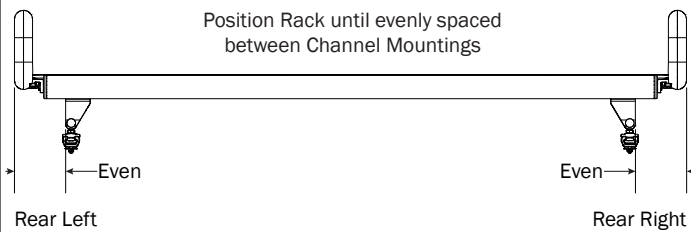
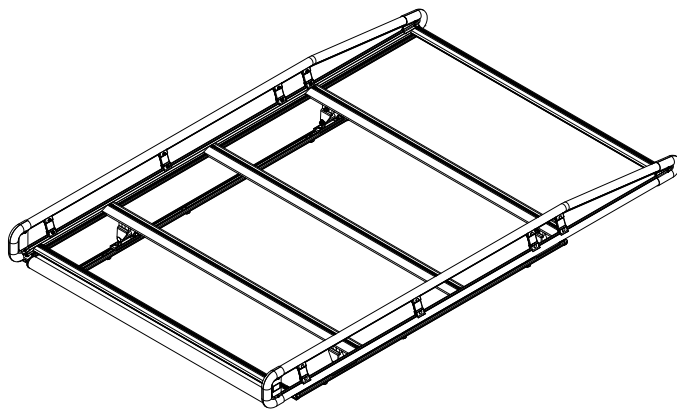
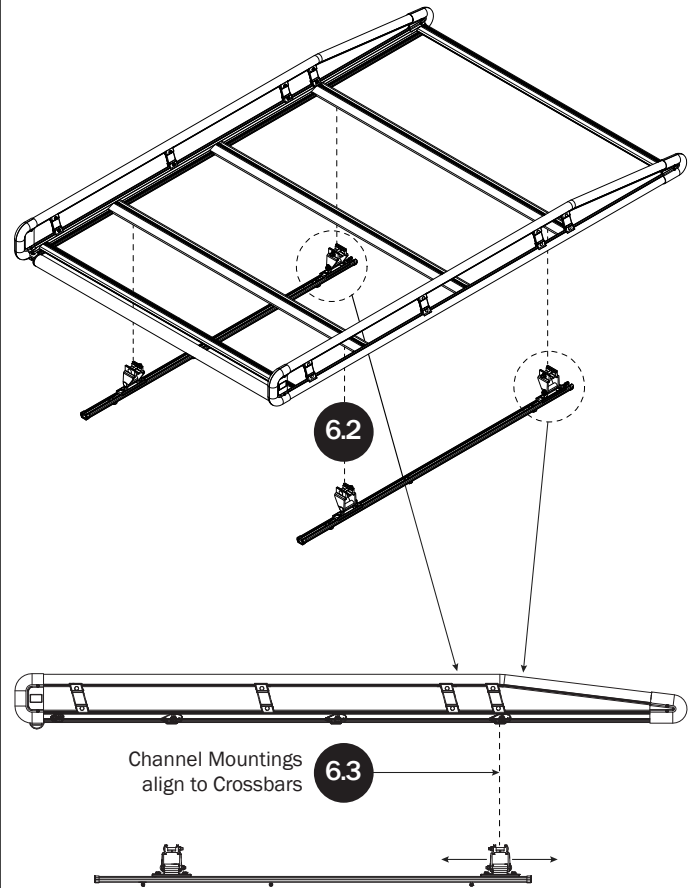
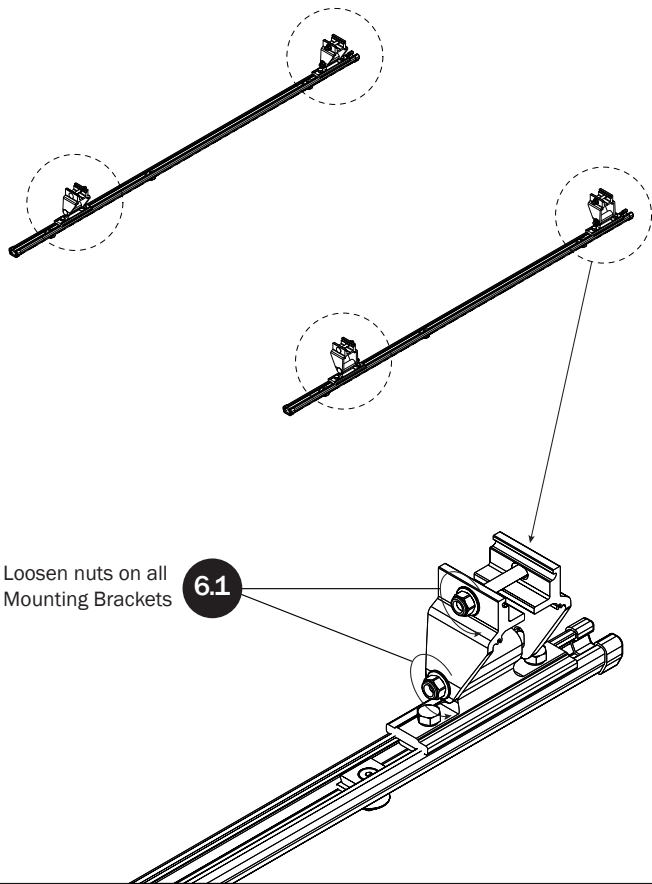

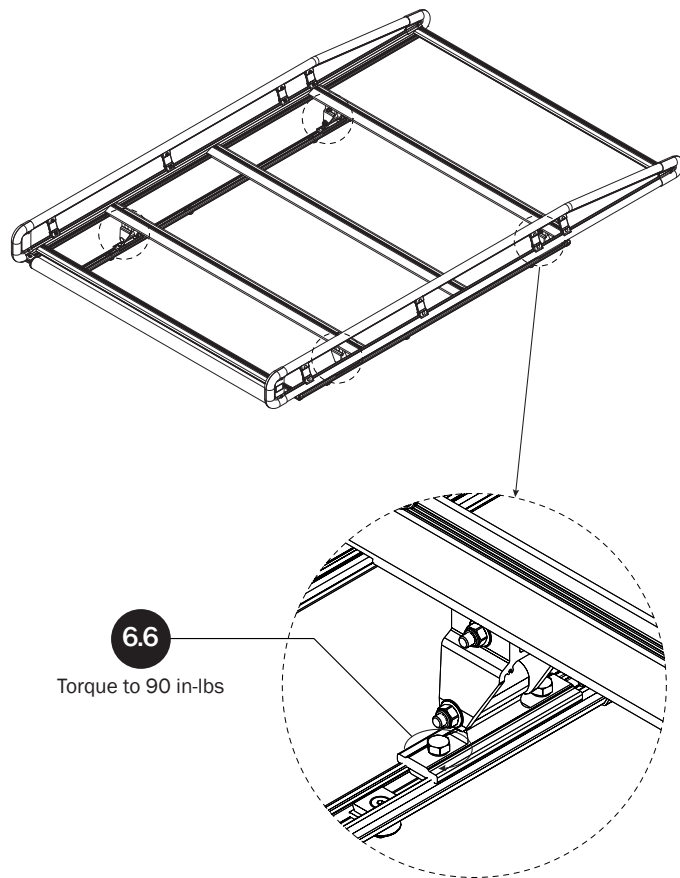

ADDITIONAL INFORMATION

For additional information regarding your AR1903 Ladder Rack, please visit the Prime Design website at: www.primedesign.net.

Using a QR code reader in your smart phone or tablet, read the QR Code shown below and follow the same steps as you would from your laptop or computer.

If you're viewing this document as an interactive PDF, you may simply click on the QR Code below to access the Prime Design website.

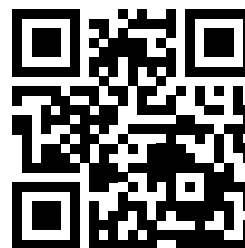

Page Intentionally Left Blank

