

PRIME DESIGN™

A Safe Fleet Brand

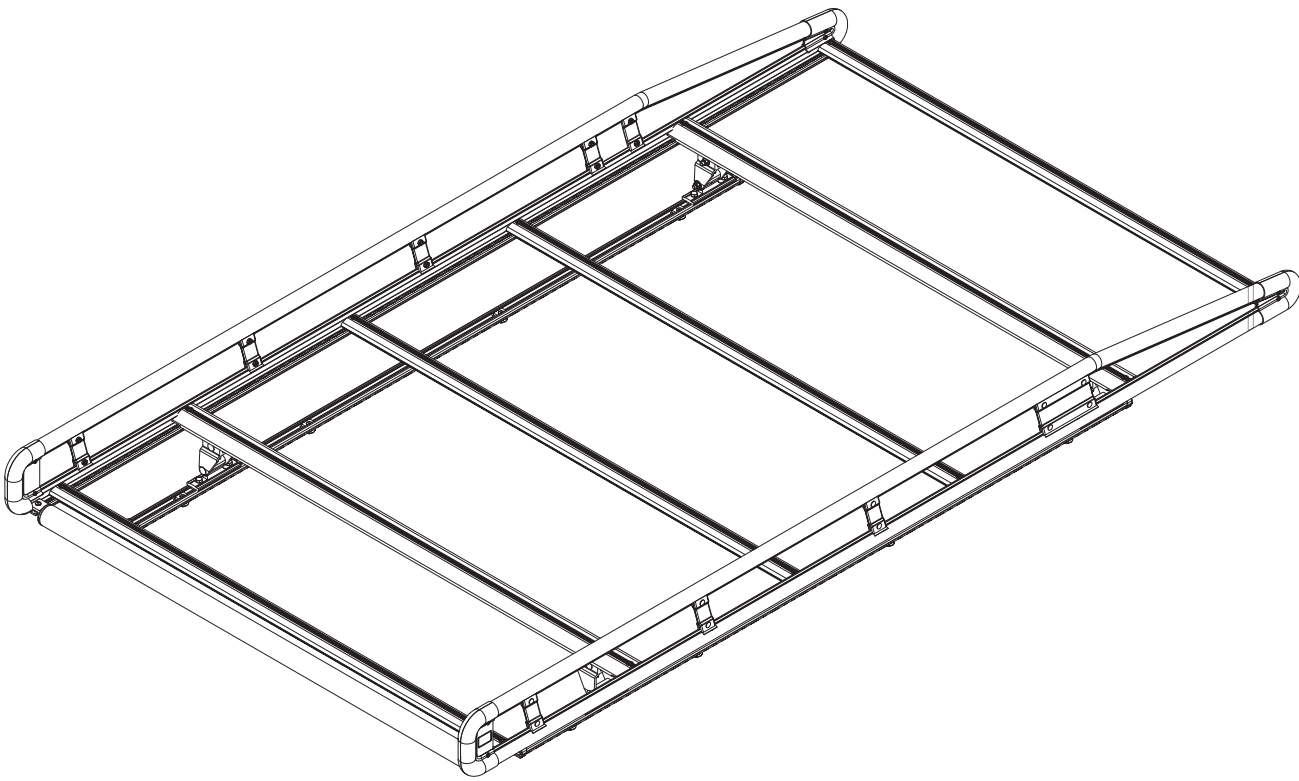

AR1904

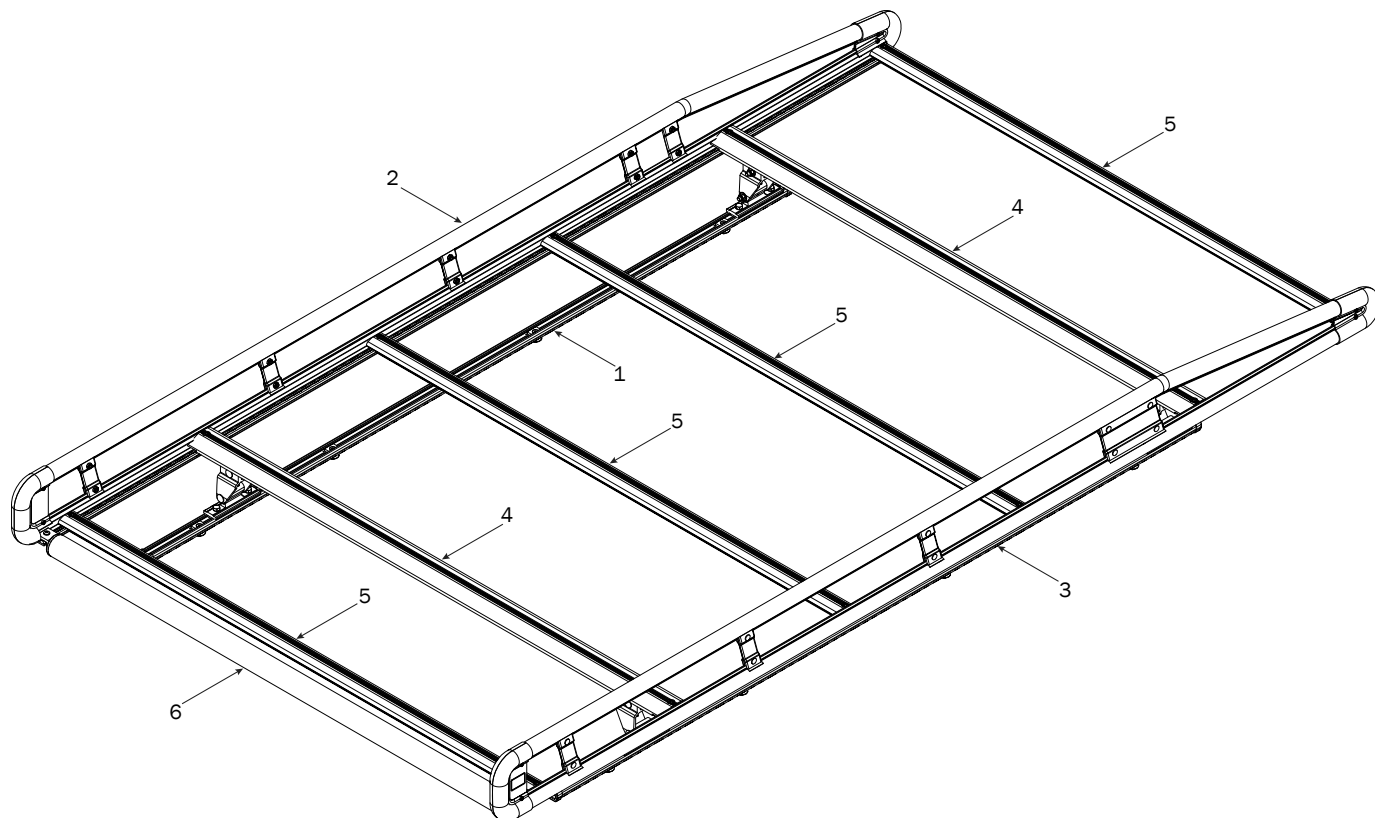

1—FBM-0009-A (Qty 1)
Channels with hardware

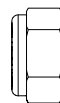
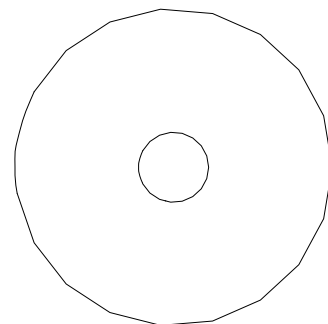
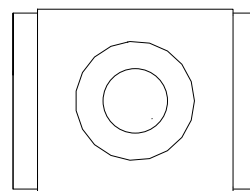
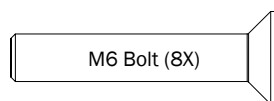

2—Side Rail Assembly (Qty 1)
Left Hand, 95.00"

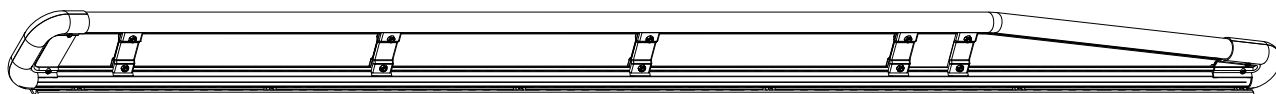

3—Side Rail Assembly (Qty 1)
Right Hand, 95.00"

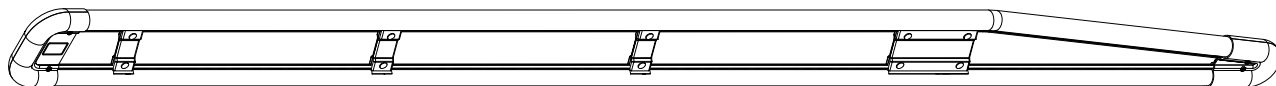

4—AluRack Construction Crossbar..... (Qty 2)
With hardware, 53.00"

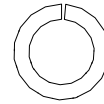

M8 Lock Washer (4X)

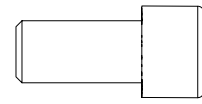

M8 Cap Head Bolt (4X)

5—AluRack Standard Crossbar (Qty 4)
With hardware, 53.00"

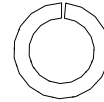

M8 Lock Washer (8X)

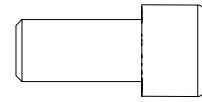

M8 Cap Head Bolt (8X)

6—Roller Assembly..... (Qty 1)
With hardware, 53.00"

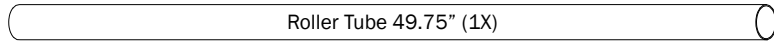

Roller Holder (2X)



Roller End Cap (2X)

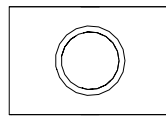

M8 Strip Nut (2X)

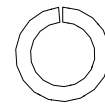

M8 Lock Washer (2X)



M8 Allen Head Bolt (2X)

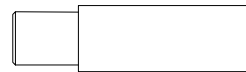

Roller Tube Pin (2X)

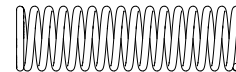

Roller Spring (2X)

7—Anti-Seize (Qty 1)

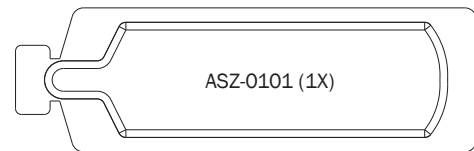

FBM-0009-A CHANNELS TO ROOF

- 1.1** Position Channels as shown below in Fig.1

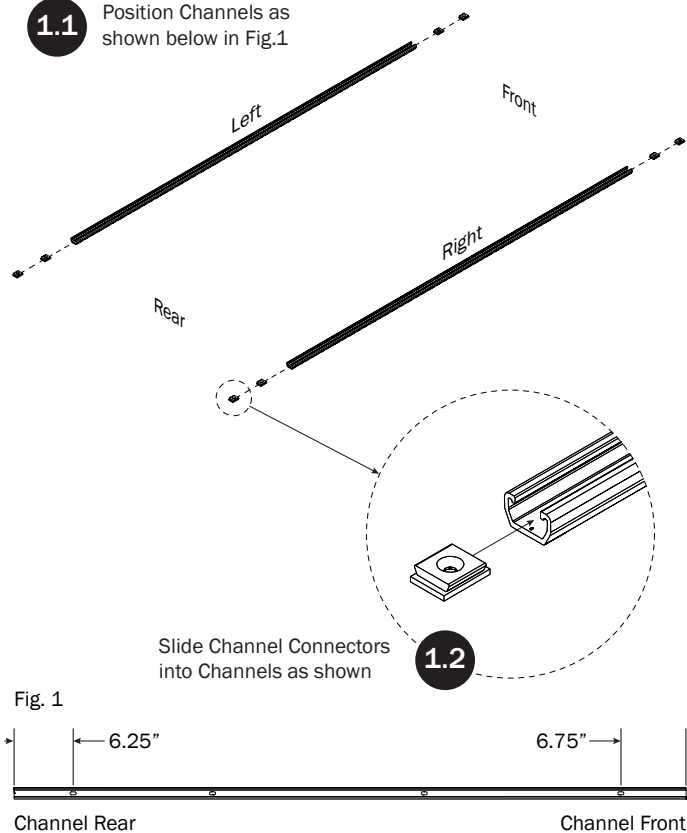

- 2.1** Install Channels into roof Channel grooves

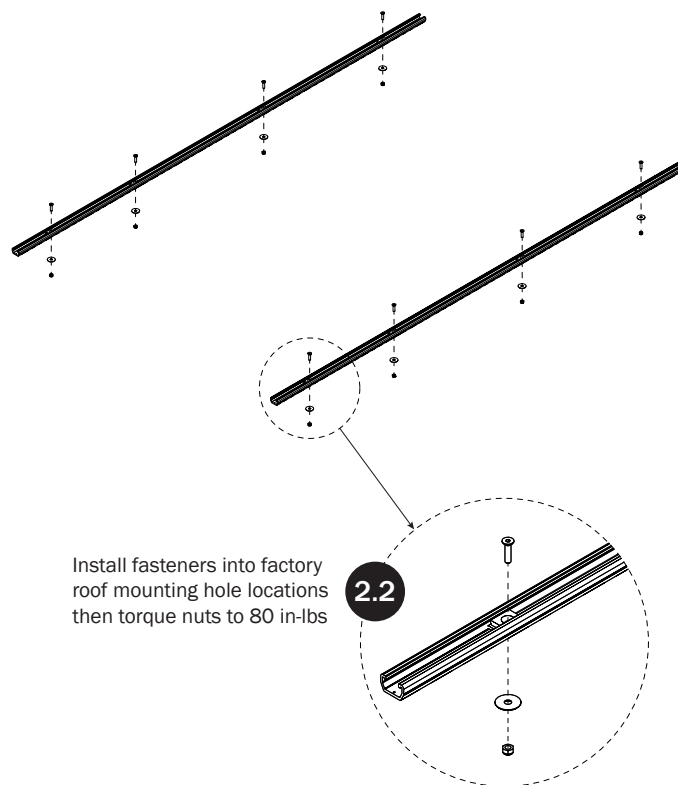

- 4** Set to distances then torque Rear Bracket nuts to 90 in-lbs leaving Front Brackets loose until Step 5.6

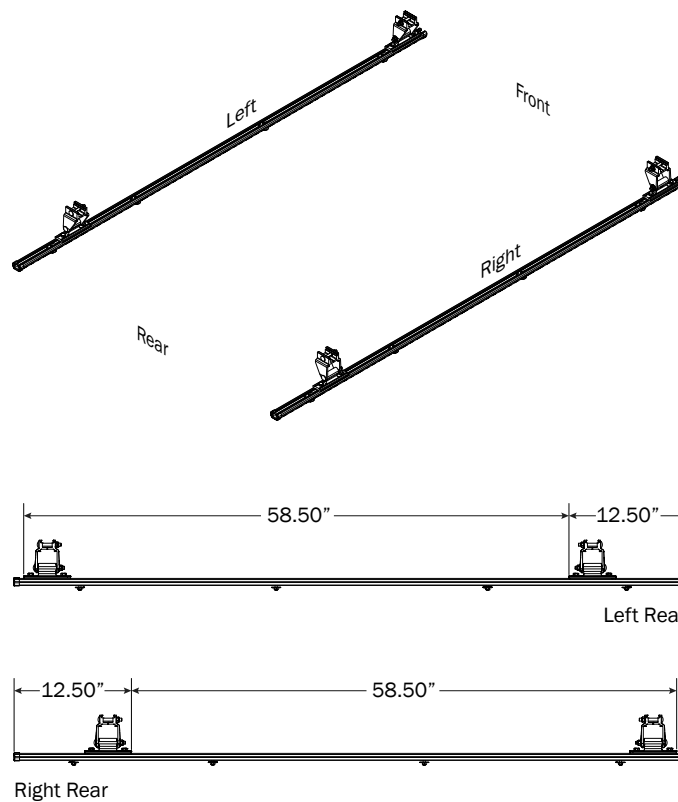

- 3** Loosen bolts

CROSSBAR INSTALLATION

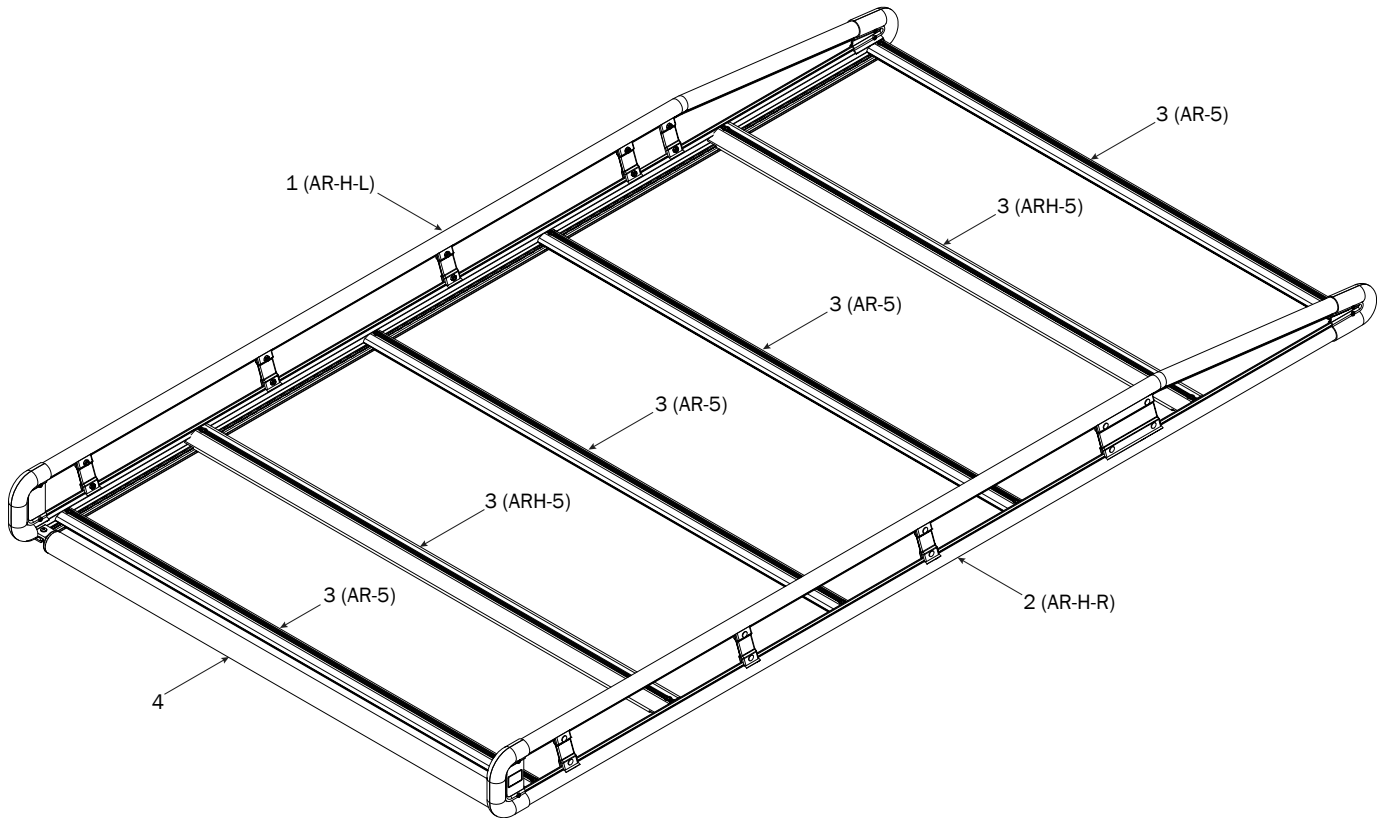

LEFT SIDE RAIL AND CROSSBARS

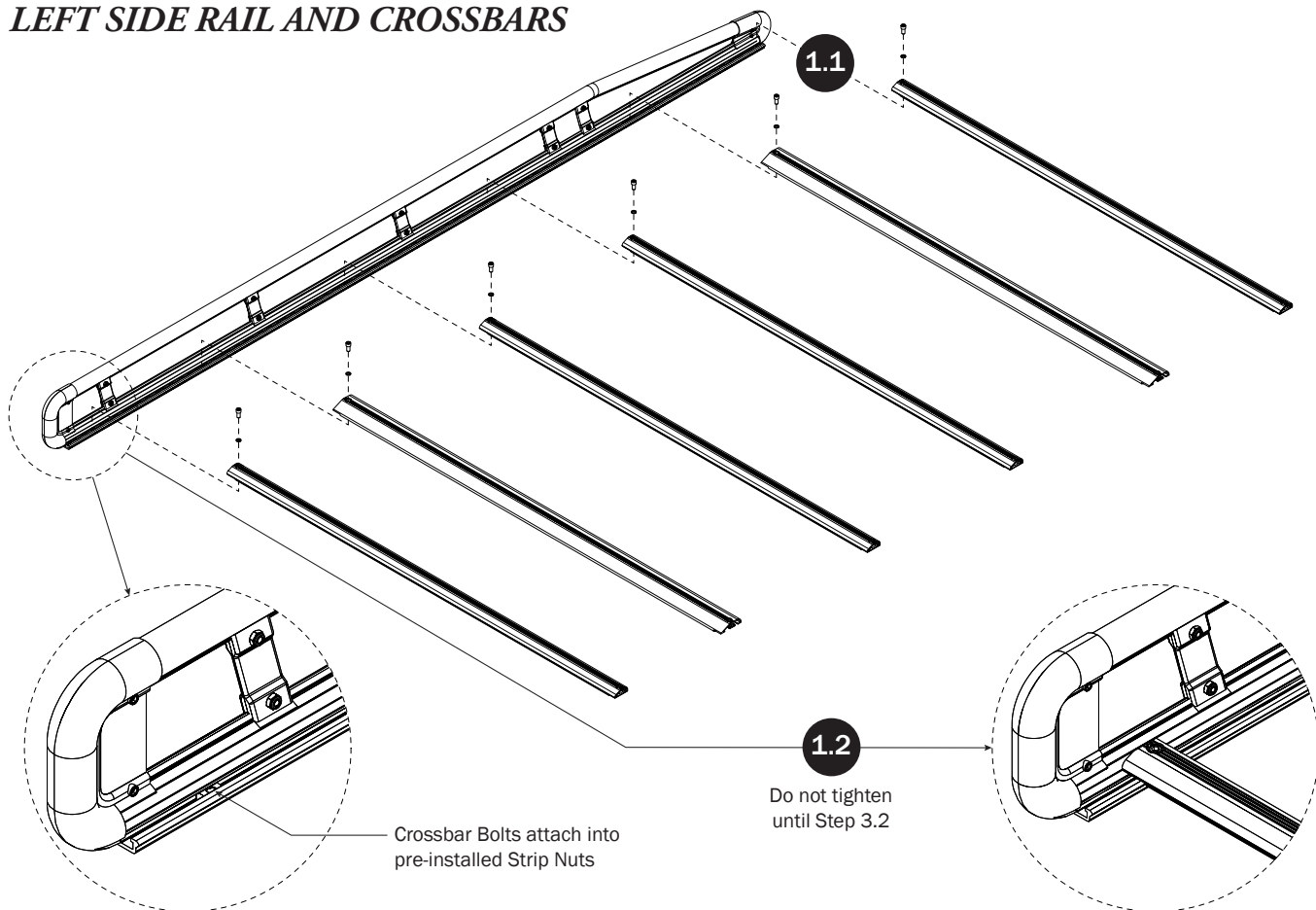

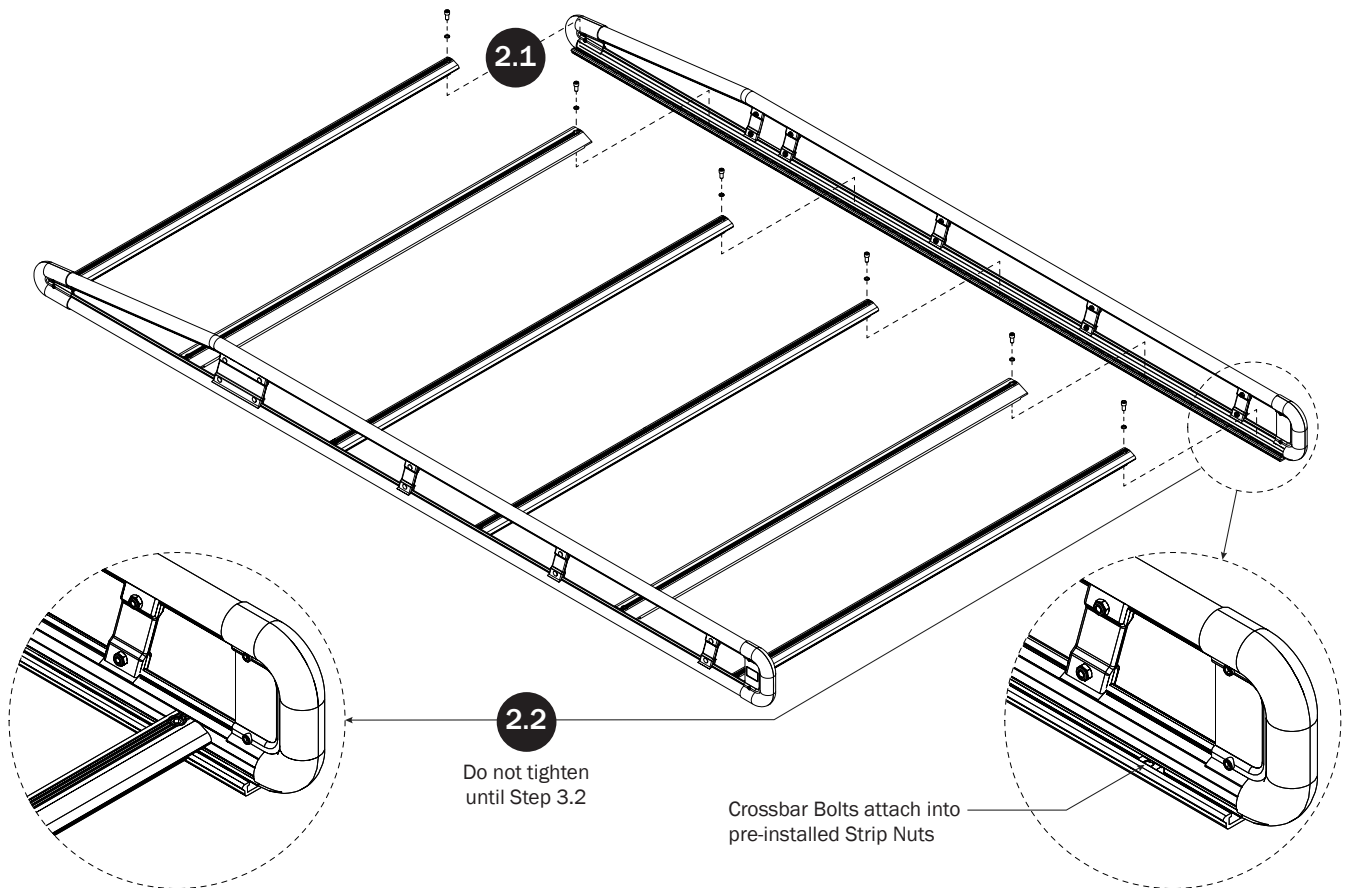
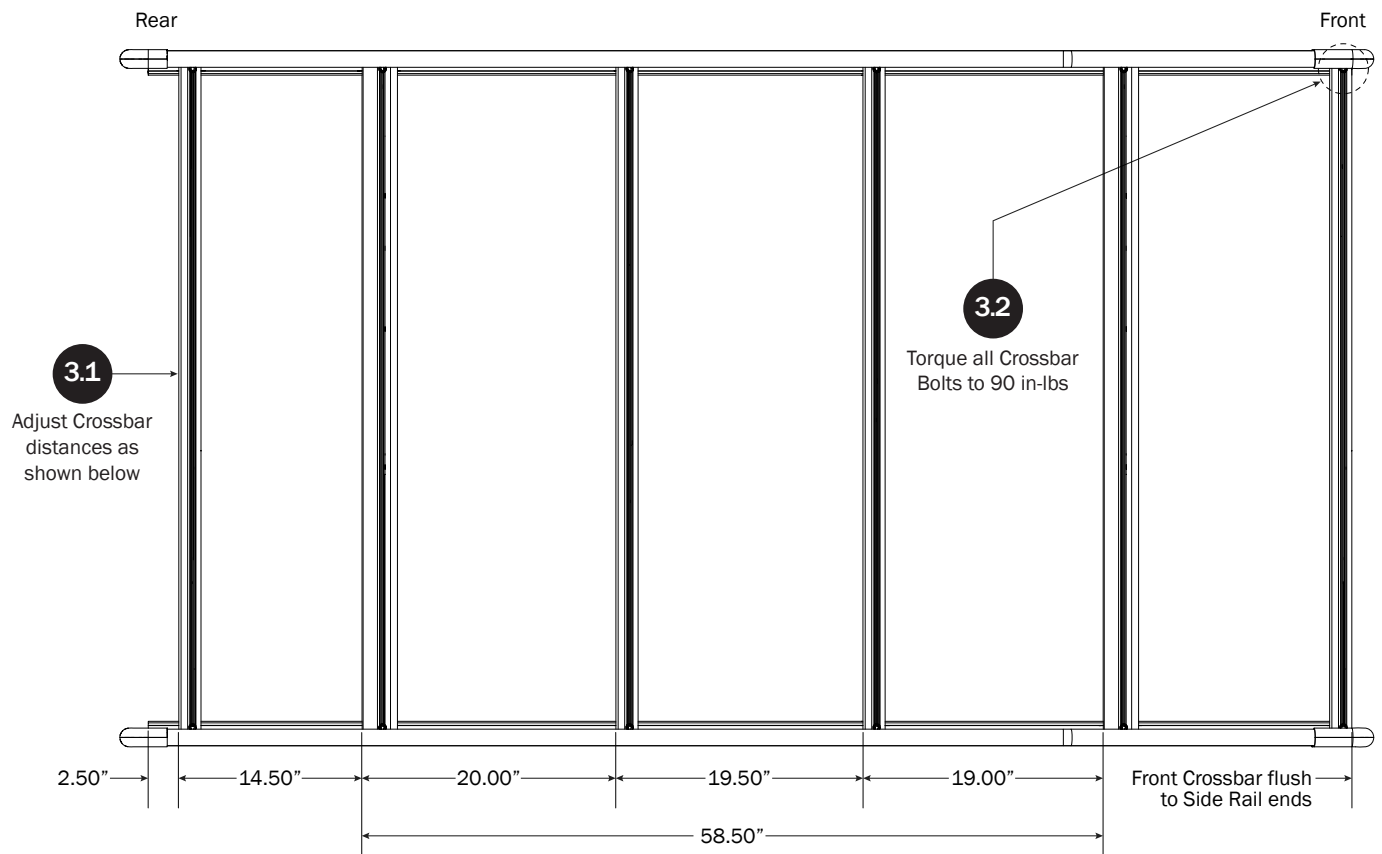
RIGHT SIDE RAIL AND CROSSBARS**CROSSBAR ADJUSTMENT**

ROLLER ASSEMBLY

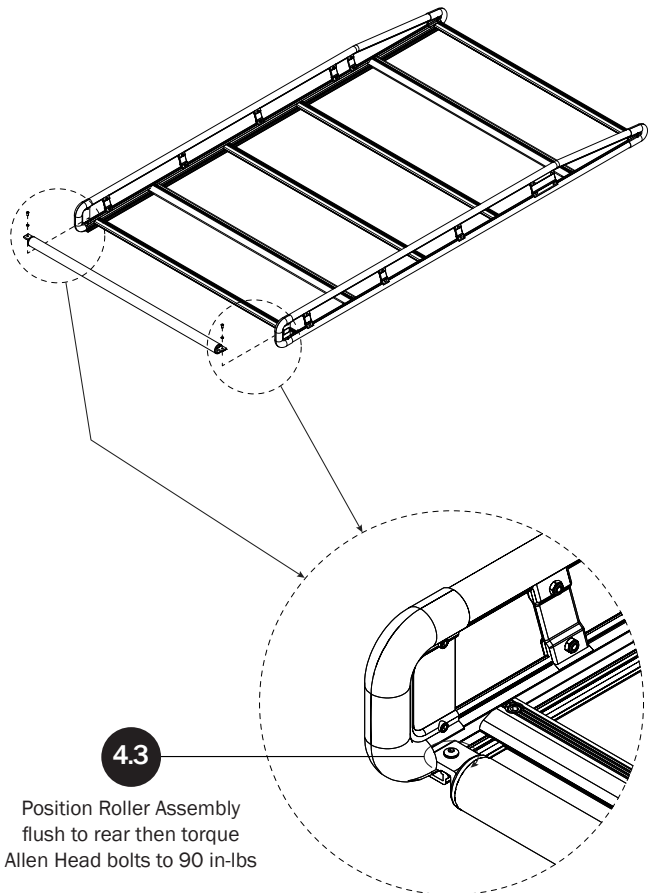
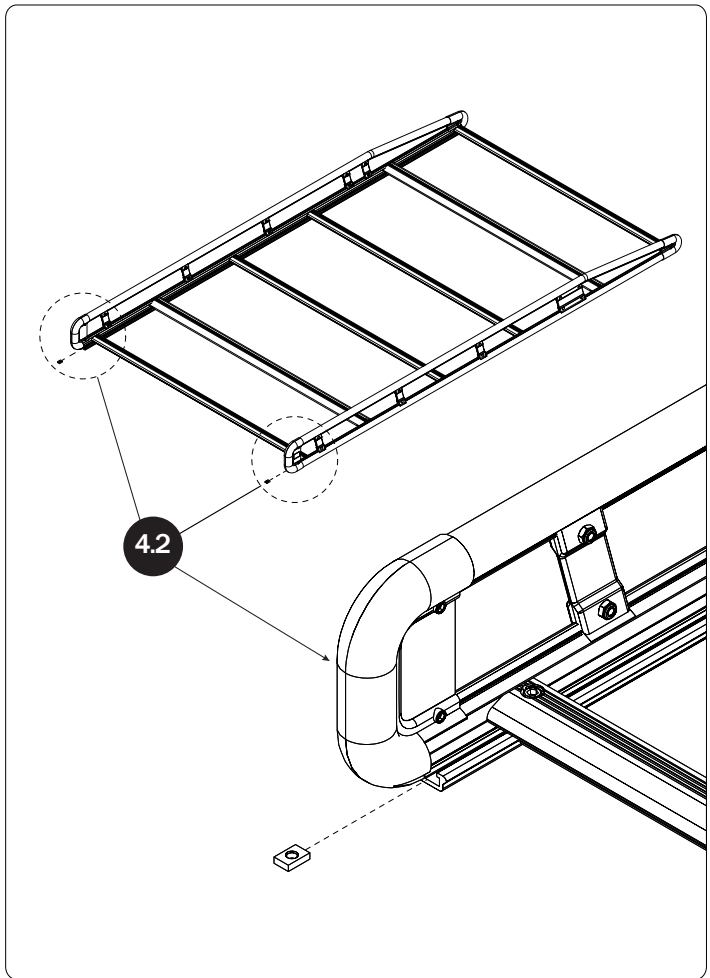
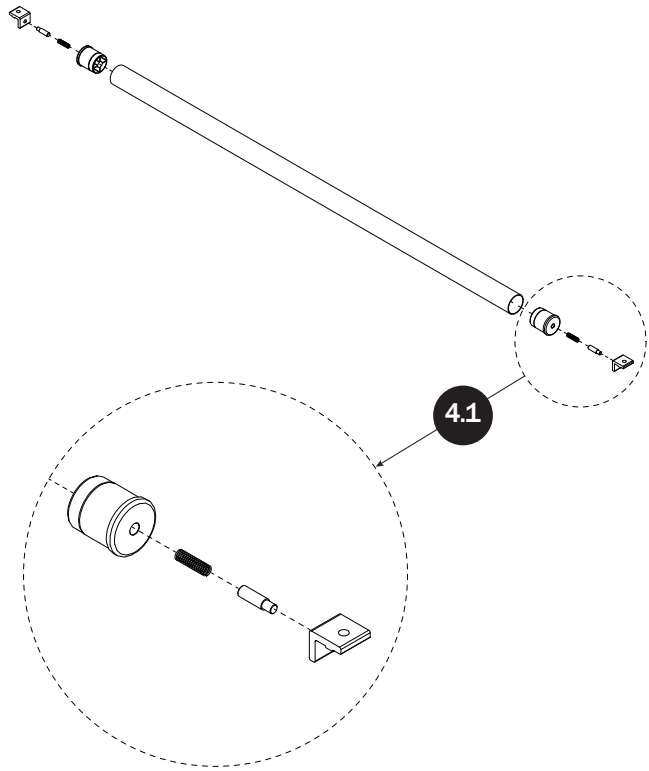

MOUNTING RACK TO CHANNELS

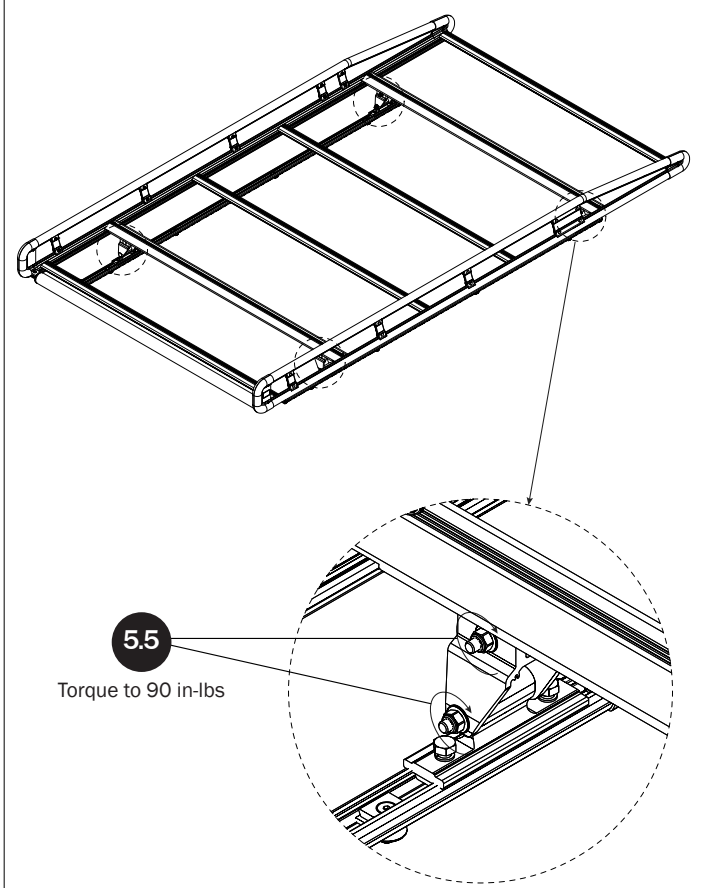
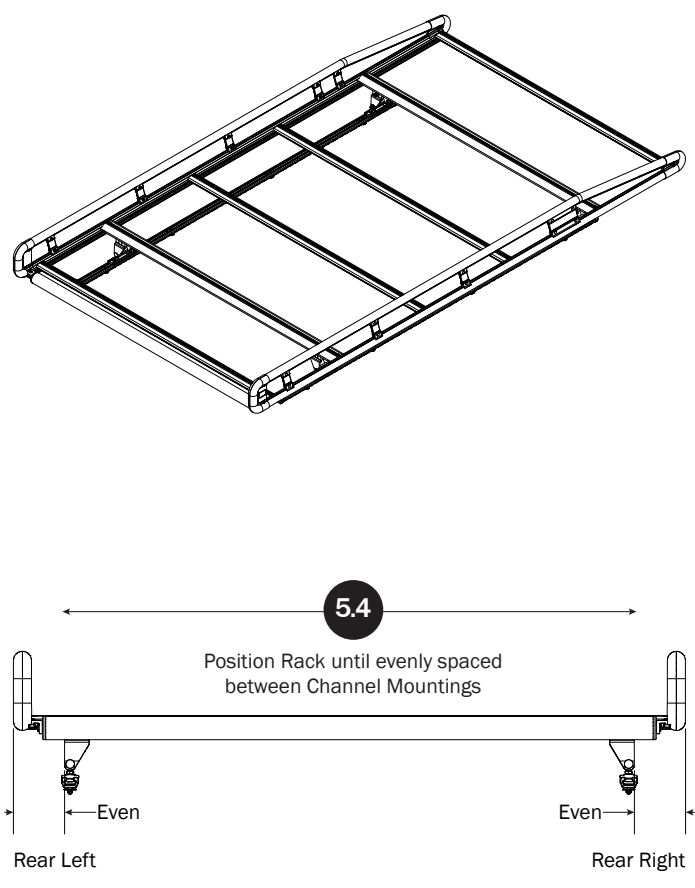
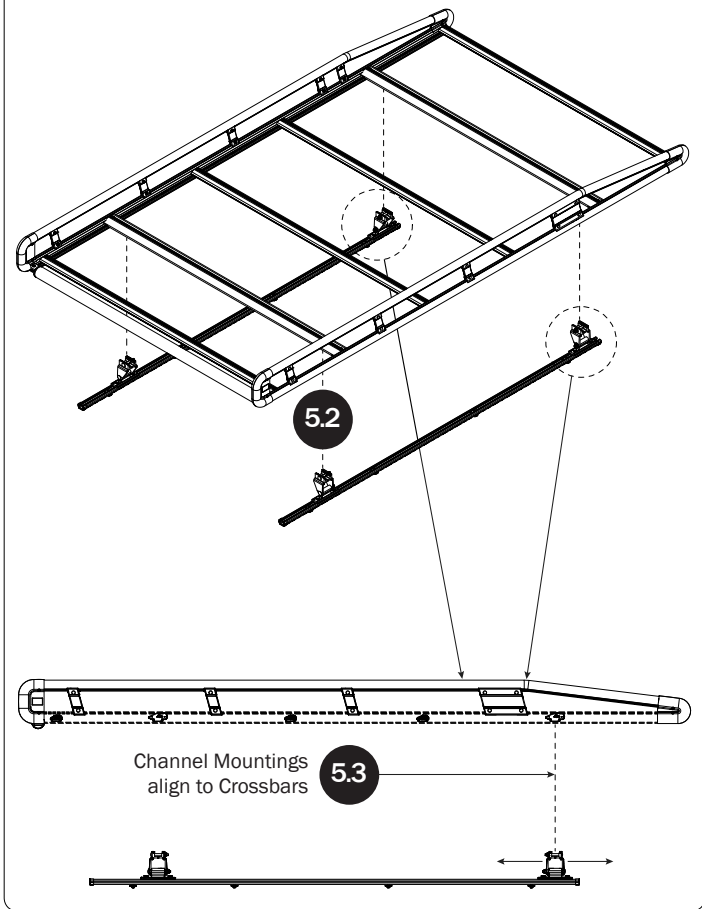
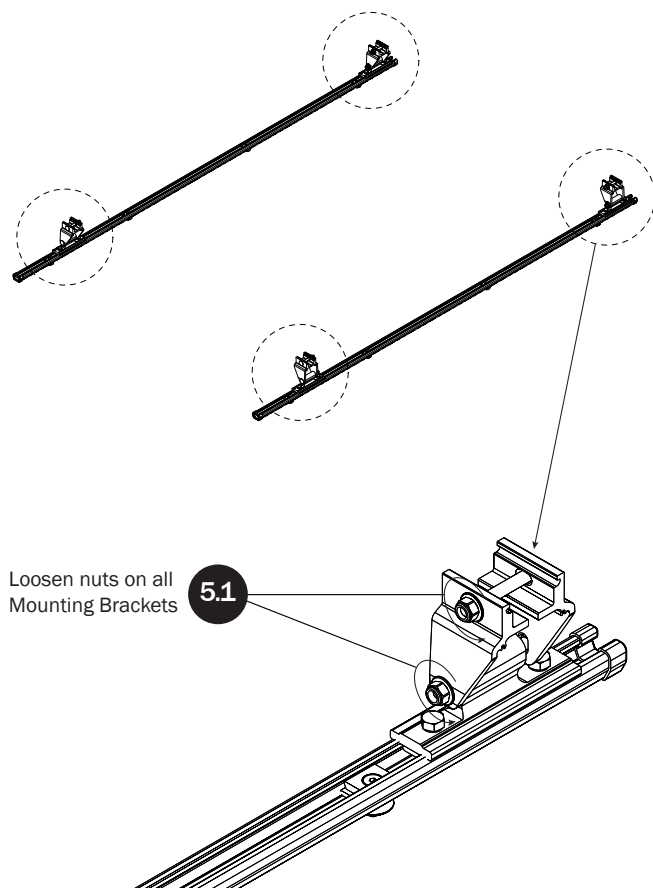

ADDITIONAL INFORMATION

For additional information regarding your AR1904 Ladder Rack, please visit the Prime Design website at: www.primedesign.net.

Using a QR code reader in your smart phone or tablet, read the QR Code shown below and follow the same steps as you would from your laptop or computer.

If you're viewing this document as an interactive PDF, you may simply click on the QR Code below to access the Prime Design website.

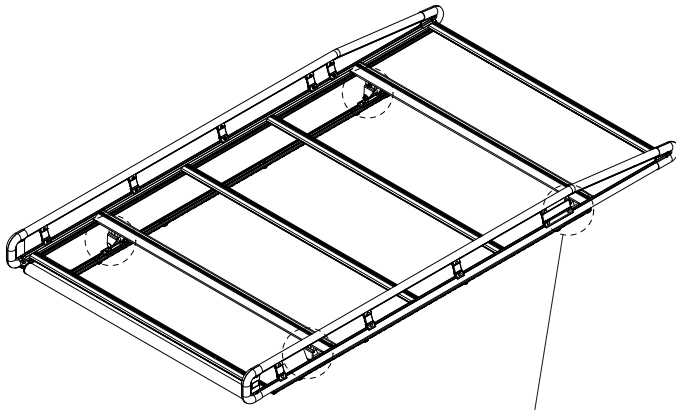
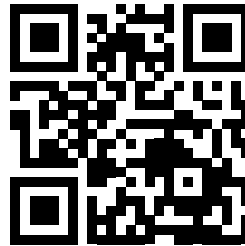
5.6

Torque to 90 in-lbs

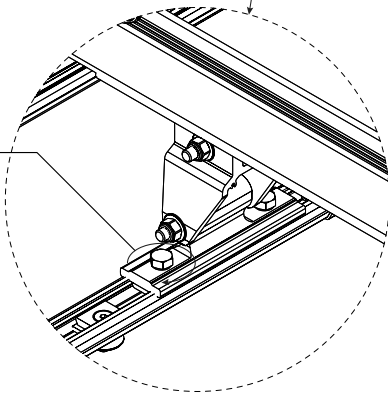

Page Intentionally Left Blank

Page Intentionally Left Blank

