

PRIME DESIGN™

A Safe Fleet Brand

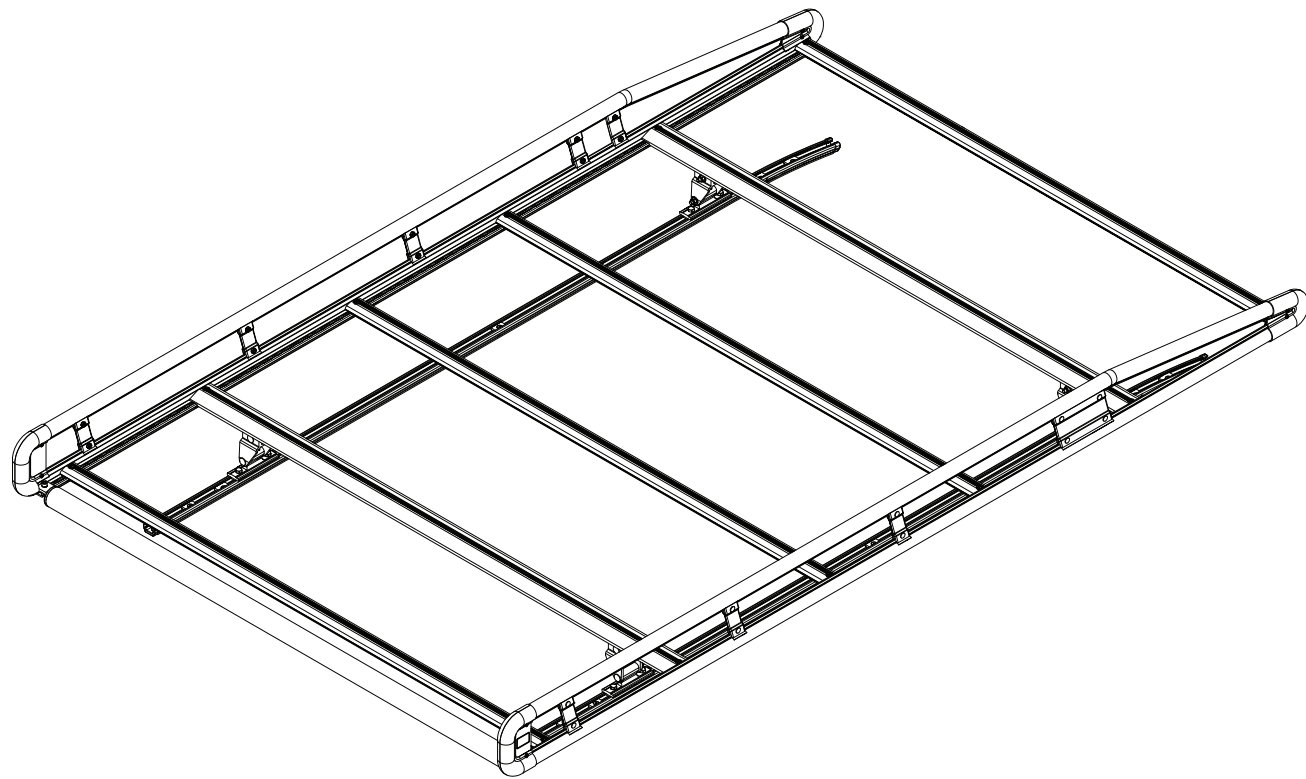

AR1927

CONTENTS OVERVIEW

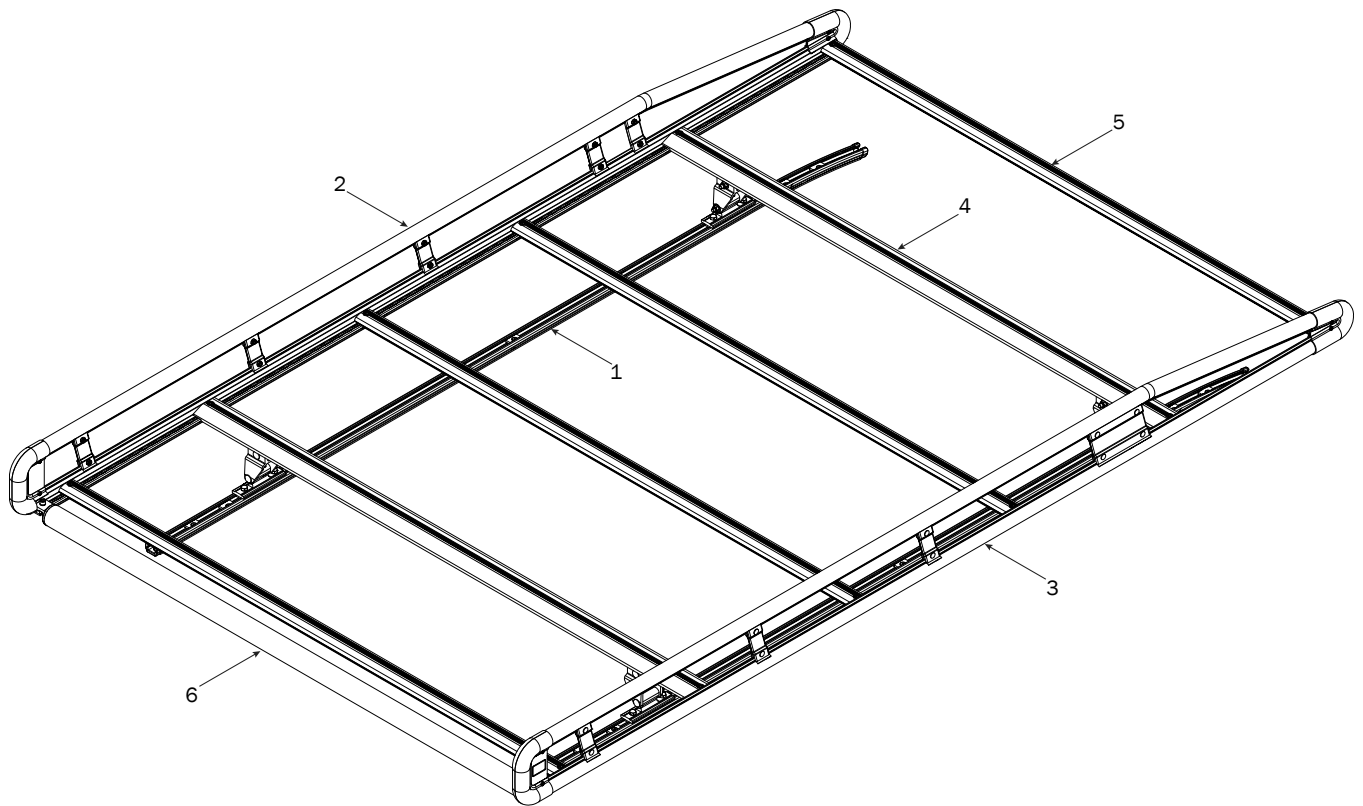

1—FBM-0060 (Qty 1)
Channels with hardware



Left Channel (1X)



Right Channel (1X)



End Caps (4X)



Brackets (4X)

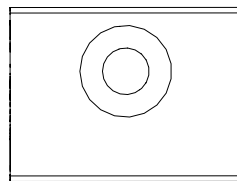

Channel Connector Offset (6X)

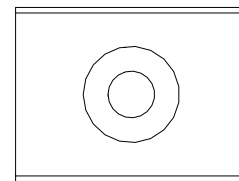

Channel Connector (4X)

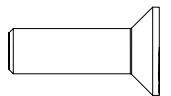

M6 Bolt (10X)

2—Side Rail Assembly (Qty 1)
Left Hand, 95.00"

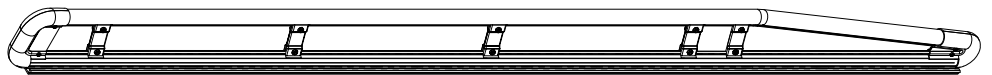

3—Side Rail Assembly (Qty 1)
Right Hand, 95.00"

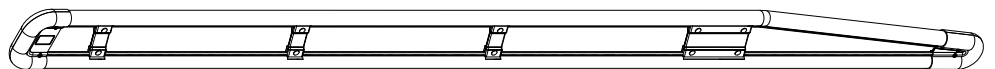

4—AluRack Standard Crossbar (Qty 2)
With hardware, 59.00”

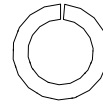
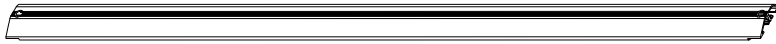

M8 Lock Washer (4X)

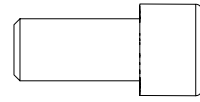

M8 Cap Head Bolt (4X)

5—AluRack Construction Crossbar..... (Qty 4)
With hardware, 59.00”

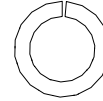

M8 Lock Washer (8X)

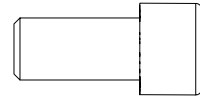

M8 Cap Head Bolt (8X)

6—Roller Assembly (Qty 1)
With hardware, 59.00”

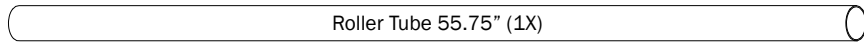

Roller Holder (2X)



Roller End Cap (2X)

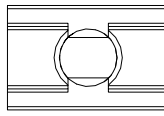

M8 Strip Nut (2X)

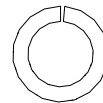

M8 Lock Washer (2X)

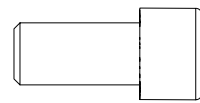

M8 Cap Head Bolt (2X)



Roller Tube Pin (2X)

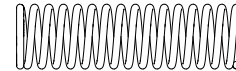

Roller Spring (2X)

7—Anti-Seize (Qty 1)

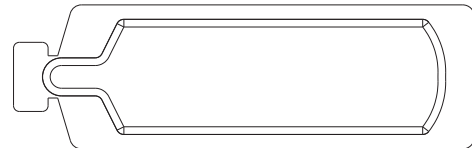

FBM-0060
CHANNELS TO ROOF

0.1 Position Channels as shown below.

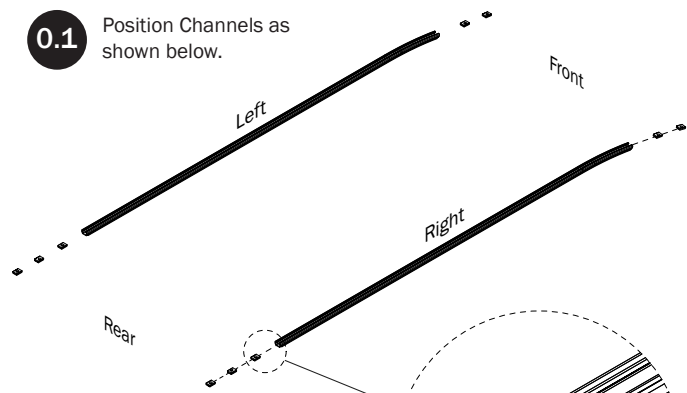

Slide the offset Connectors into the Channels noting the Channel's hole patterns.

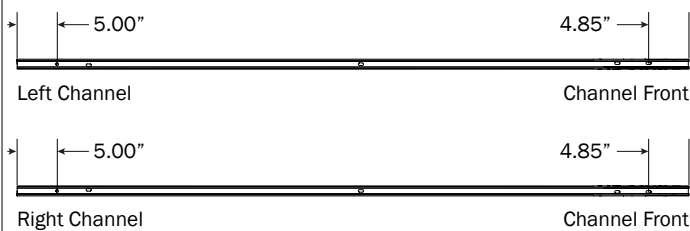
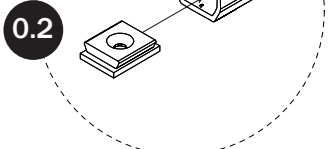

0.3 Install Channels onto roof.

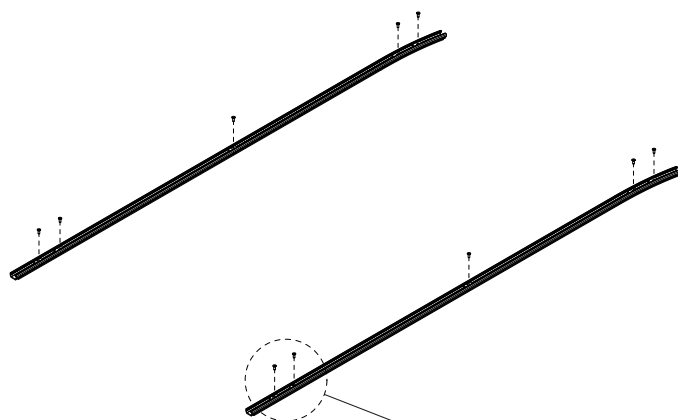

0.4

Install fasteners into factory roof rail mounting locations. Torque to 90 in-lbs

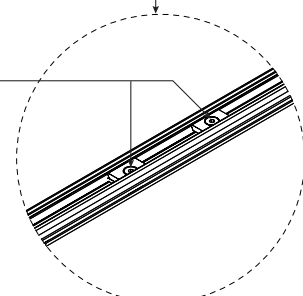

0.6 Set to distances then torque bracket nuts to 90 in-lbs

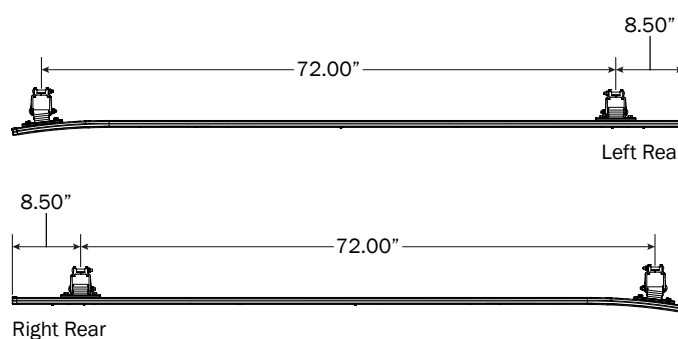
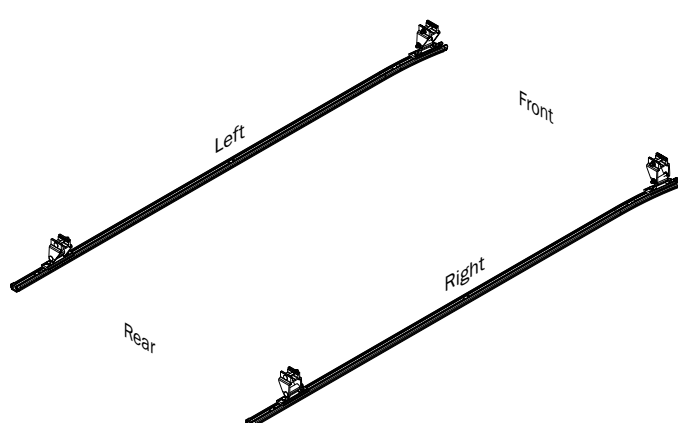
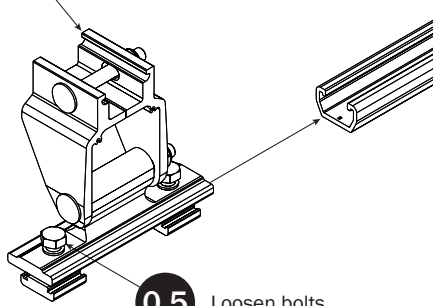
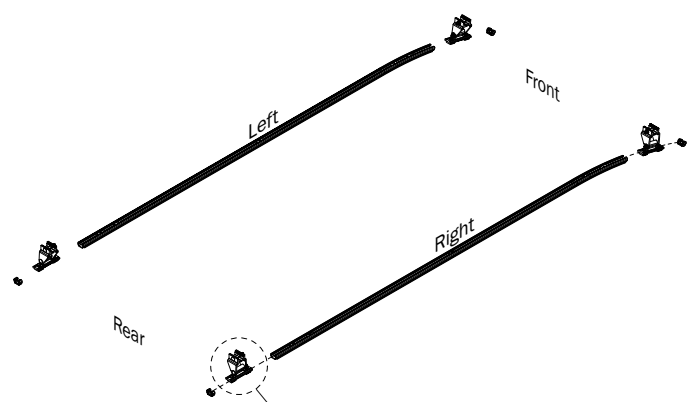

ALURACK ASSEMBLY SEQUENCE

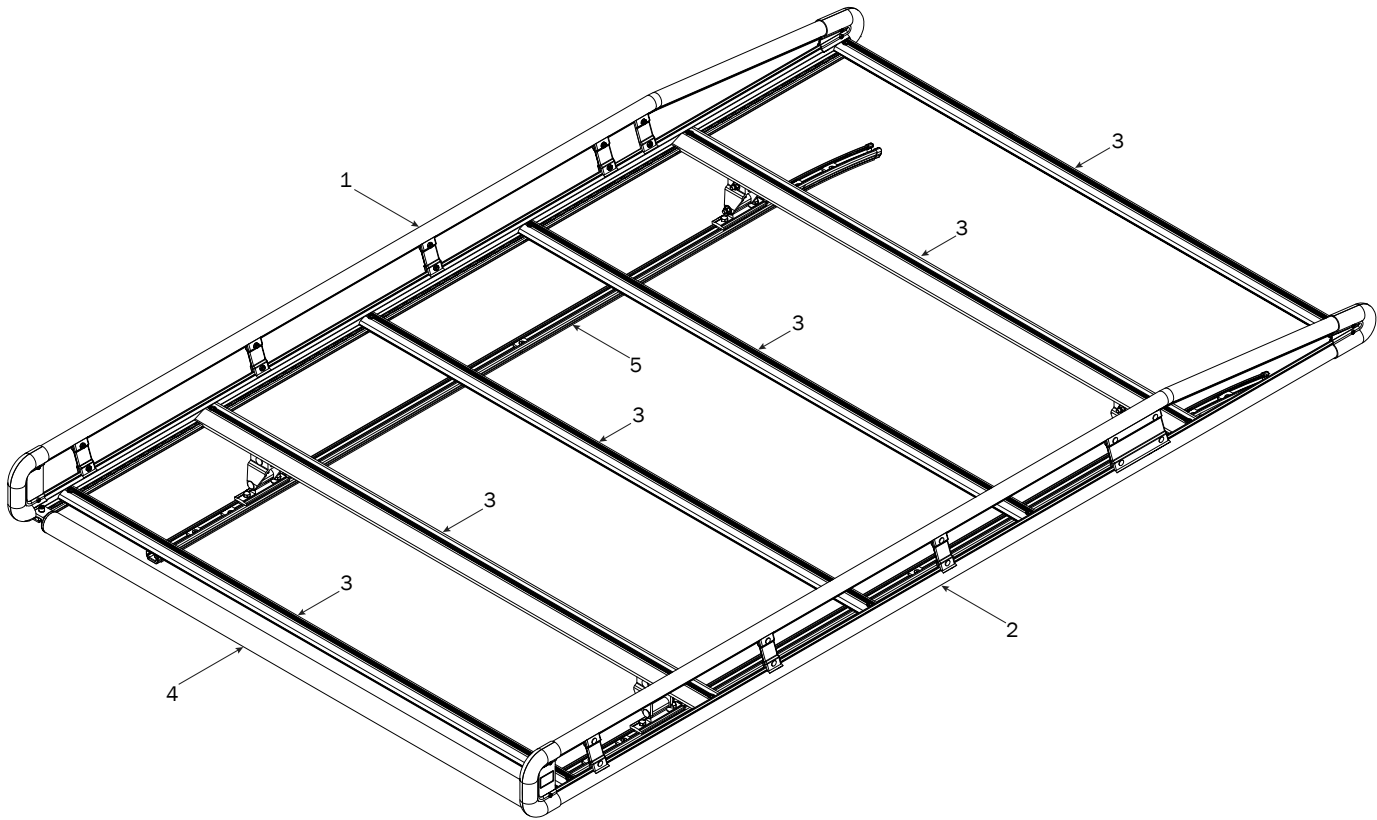

LEFT SIDE RAIL AND CROSSBARS

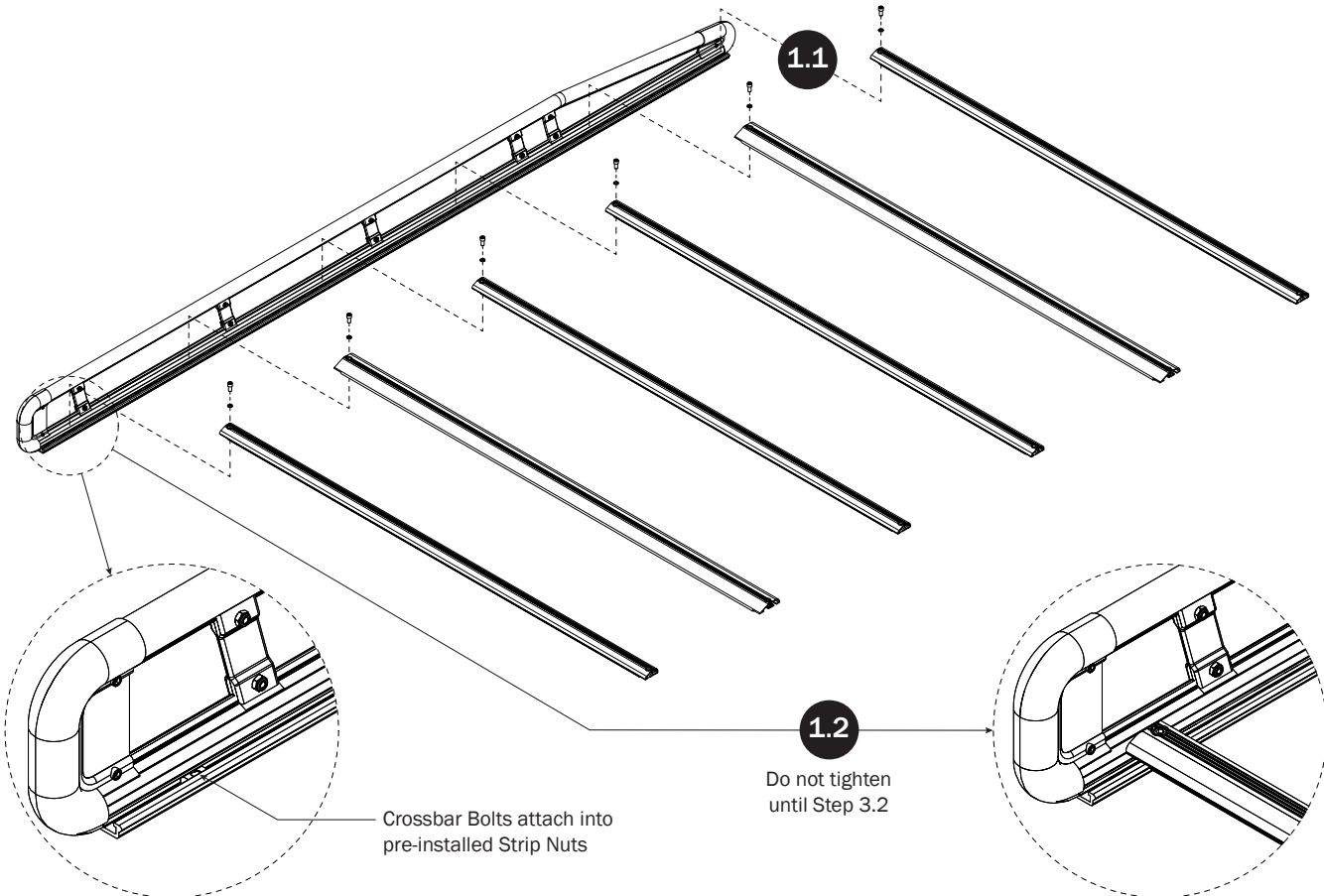

RIGHT SIDE RAIL AND CROSSBARS

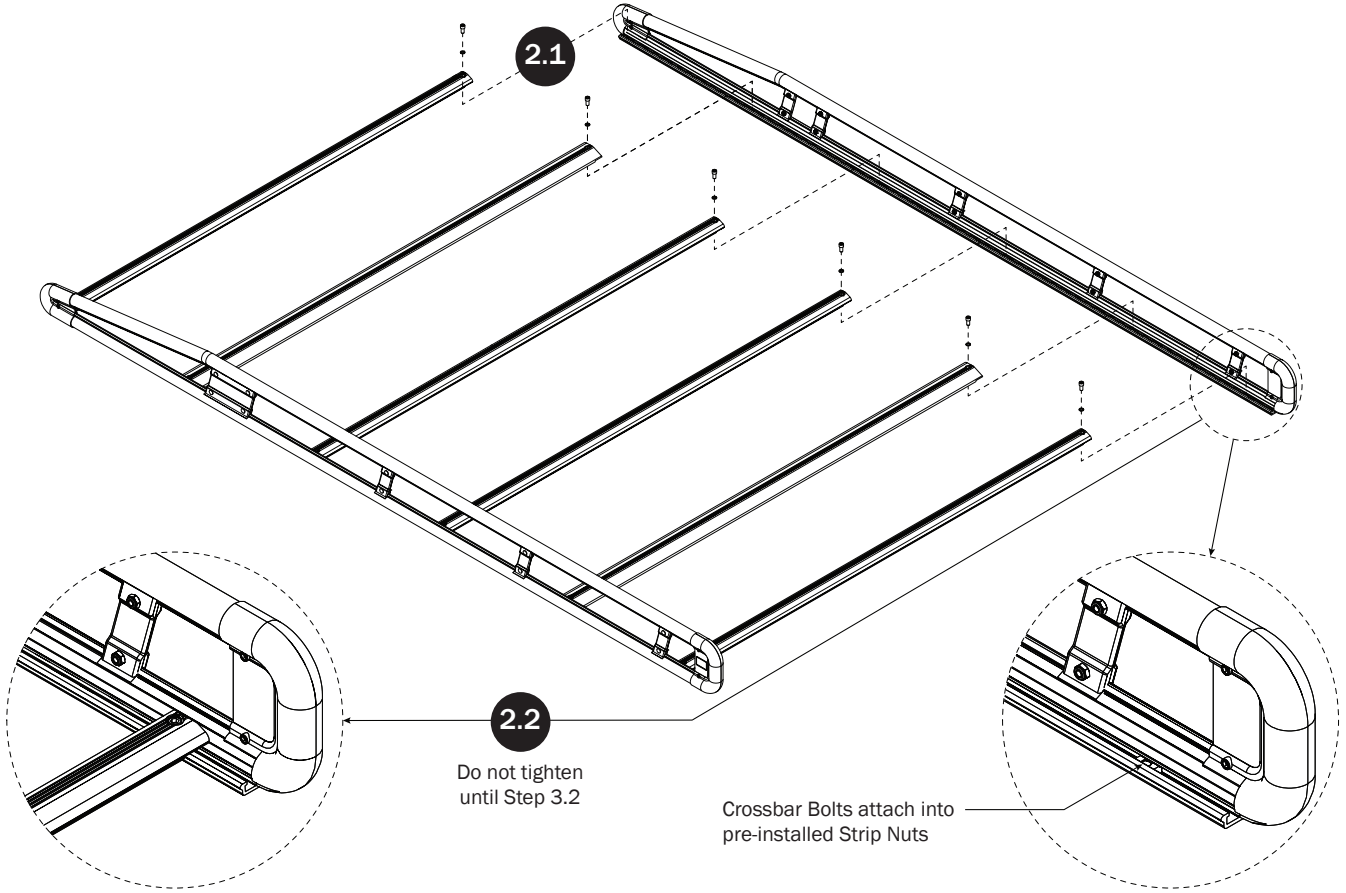

CROSSBAR ADJUSTMENT

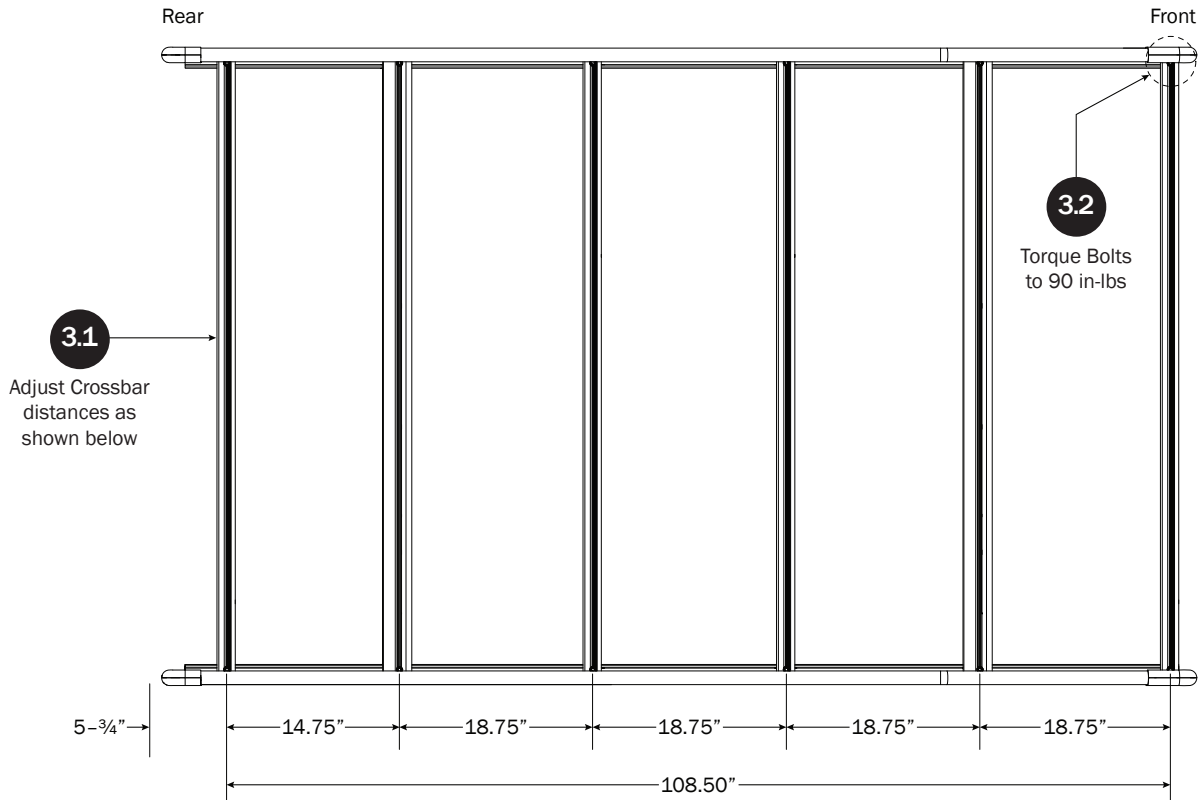

ROLLER ASSEMBLY

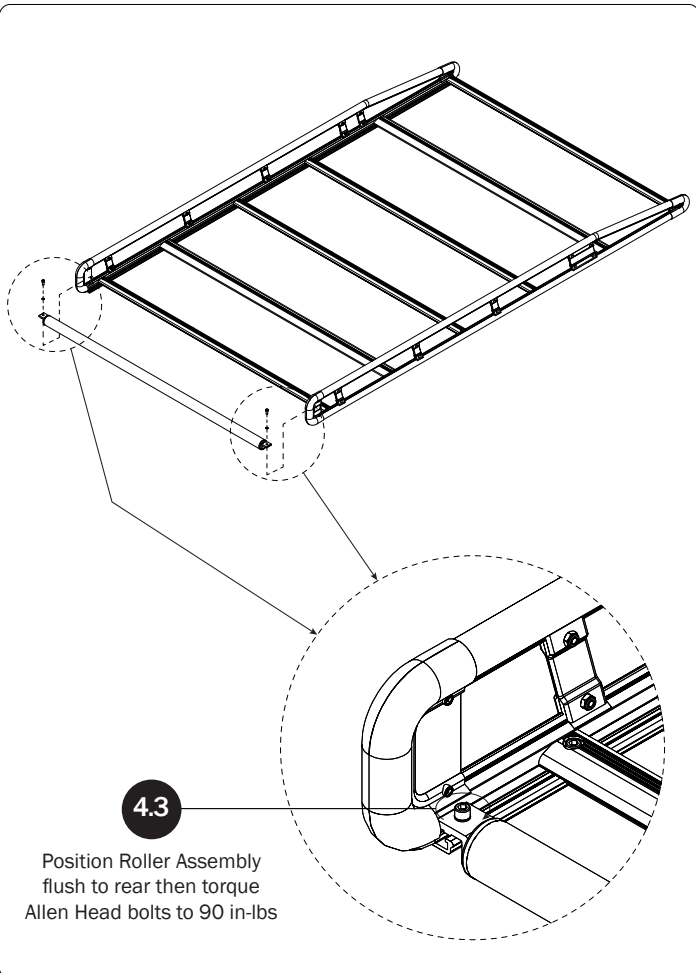
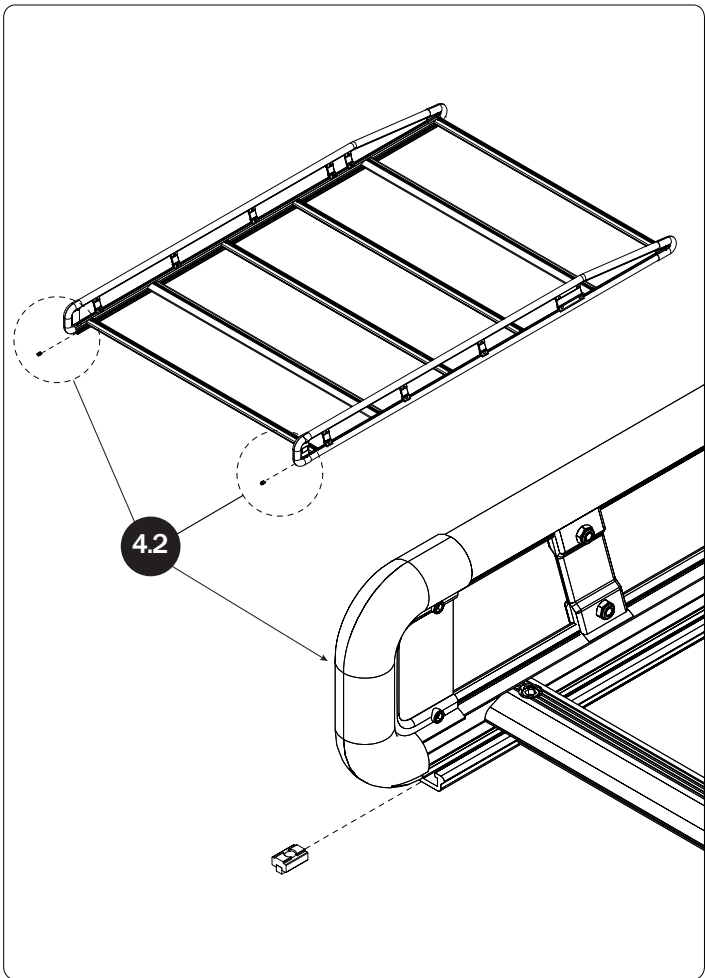
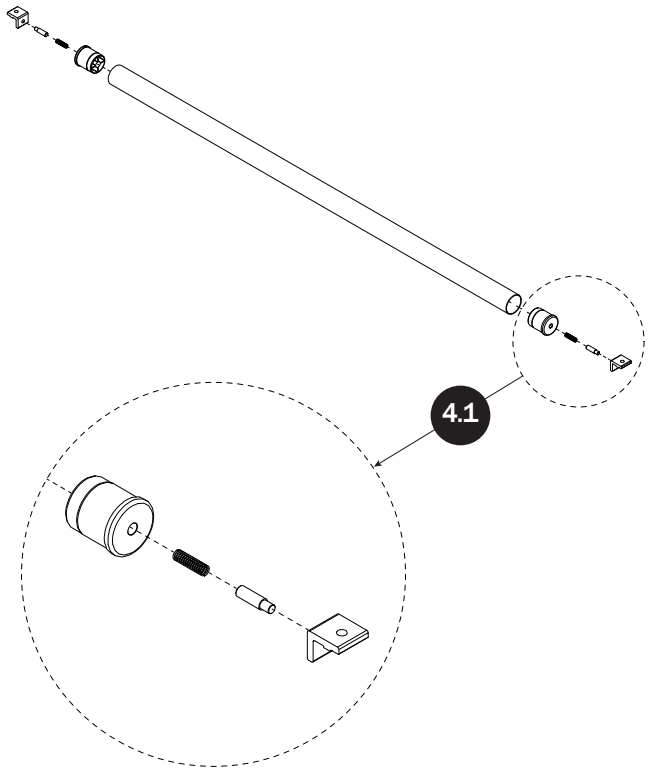

MOUNTING RACK TO CHANNELS

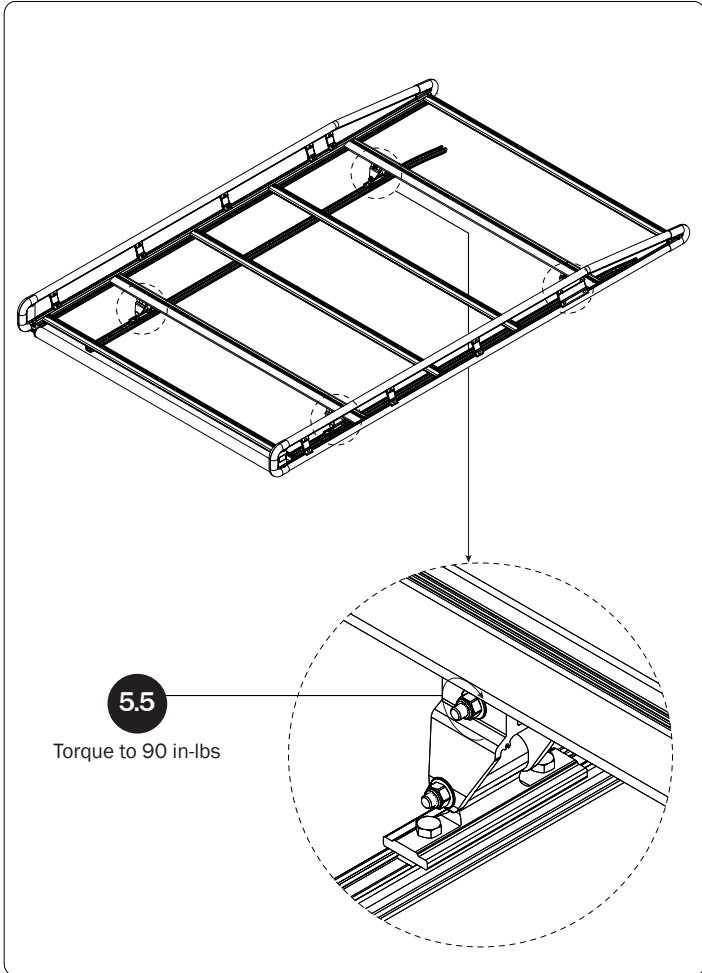
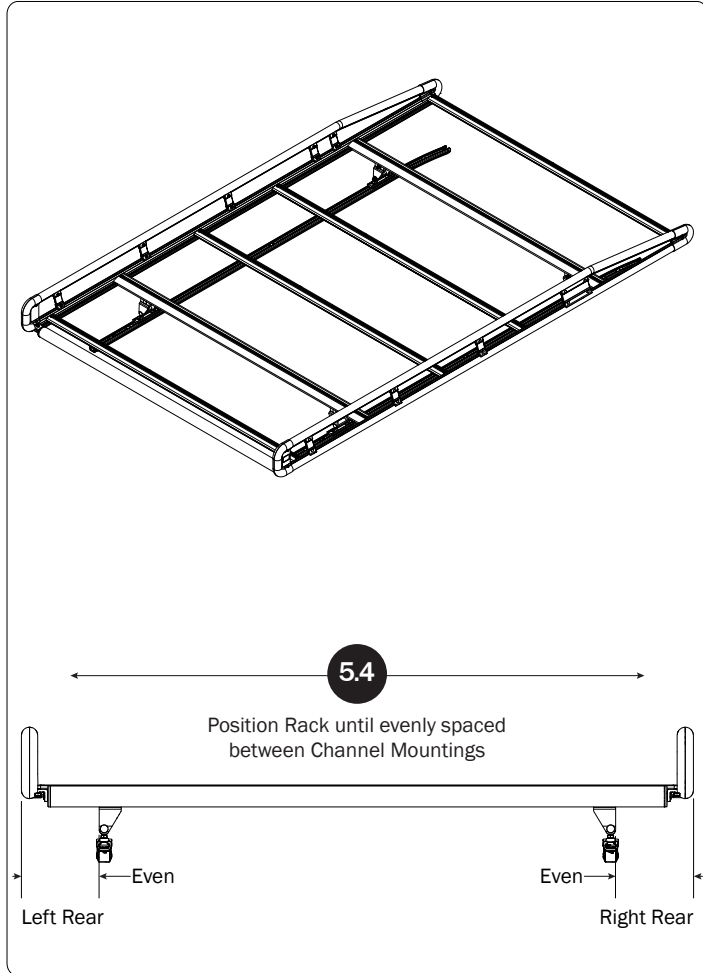
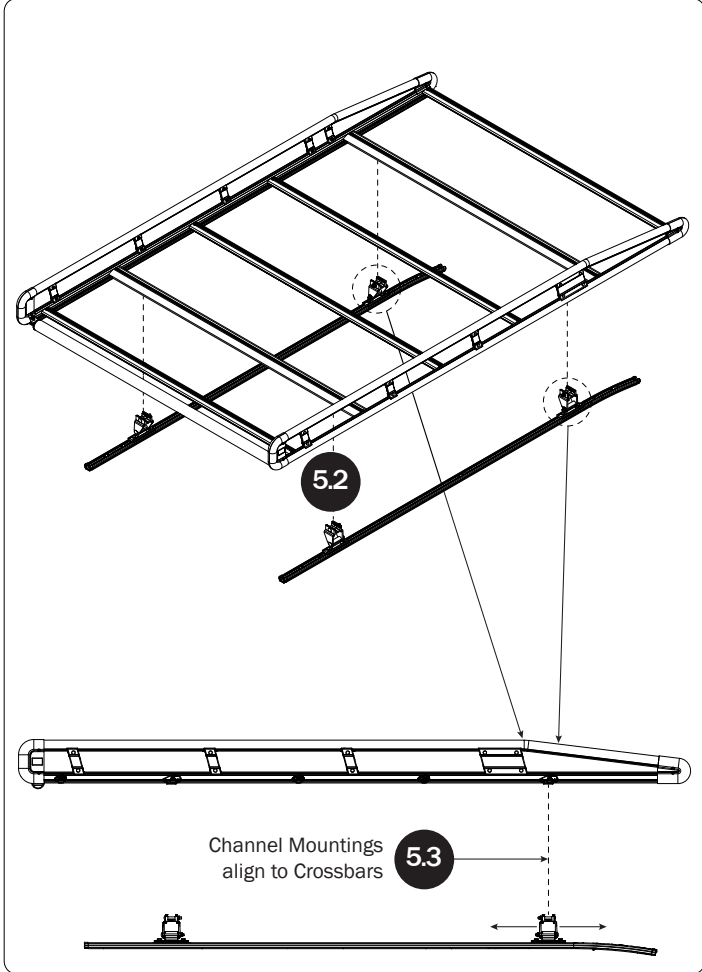
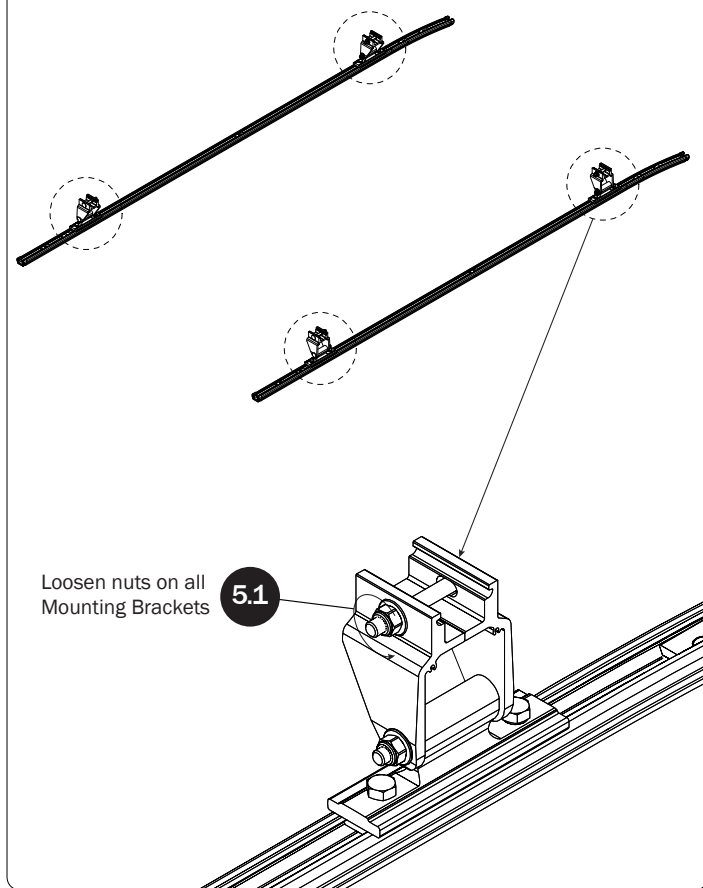

ADDITIONAL INFORMATION

For additional information regarding your AR1927 Ladder Rack, please visit the Prime Design website at: www.primedesign.net.

Using a QR code reader in your smart phone or tablet, read the QR Code shown below and follow the same steps as you would from your laptop or computer.

If you're viewing this document as an interactive PDF, you may simply click on the QR Code below to access the Prime Design website.

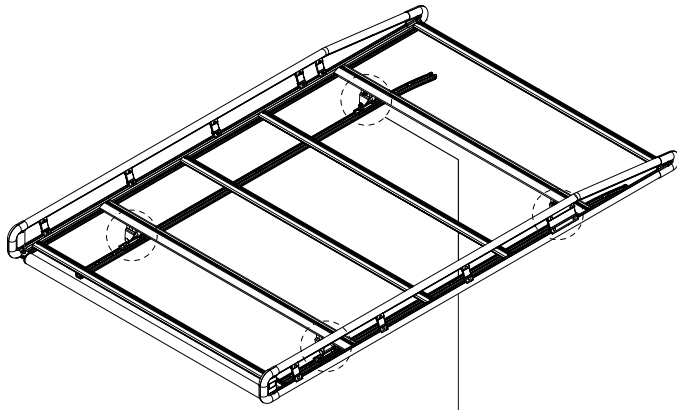
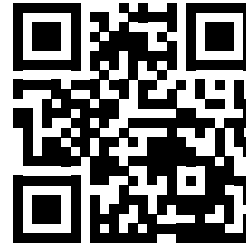
**5.6**

Torque to 90 in-lbs

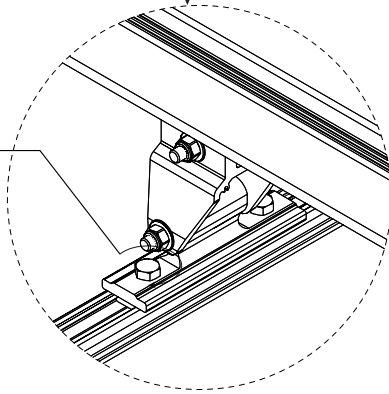

Page Intentionally Left Blank

Page Intentionally Left Blank

