

PRIME DESIGN™

A Safe Fleet Brand

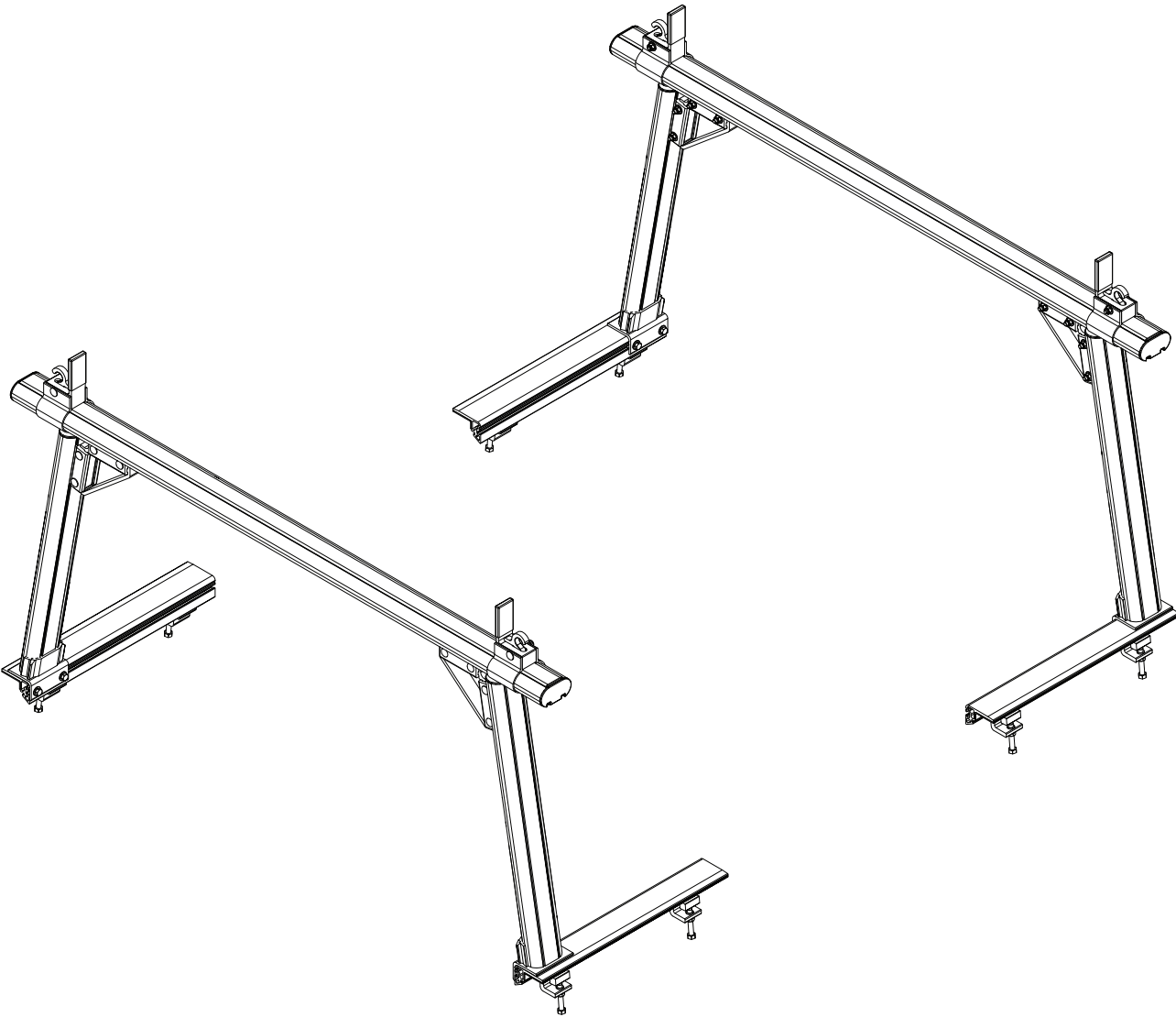

PTR

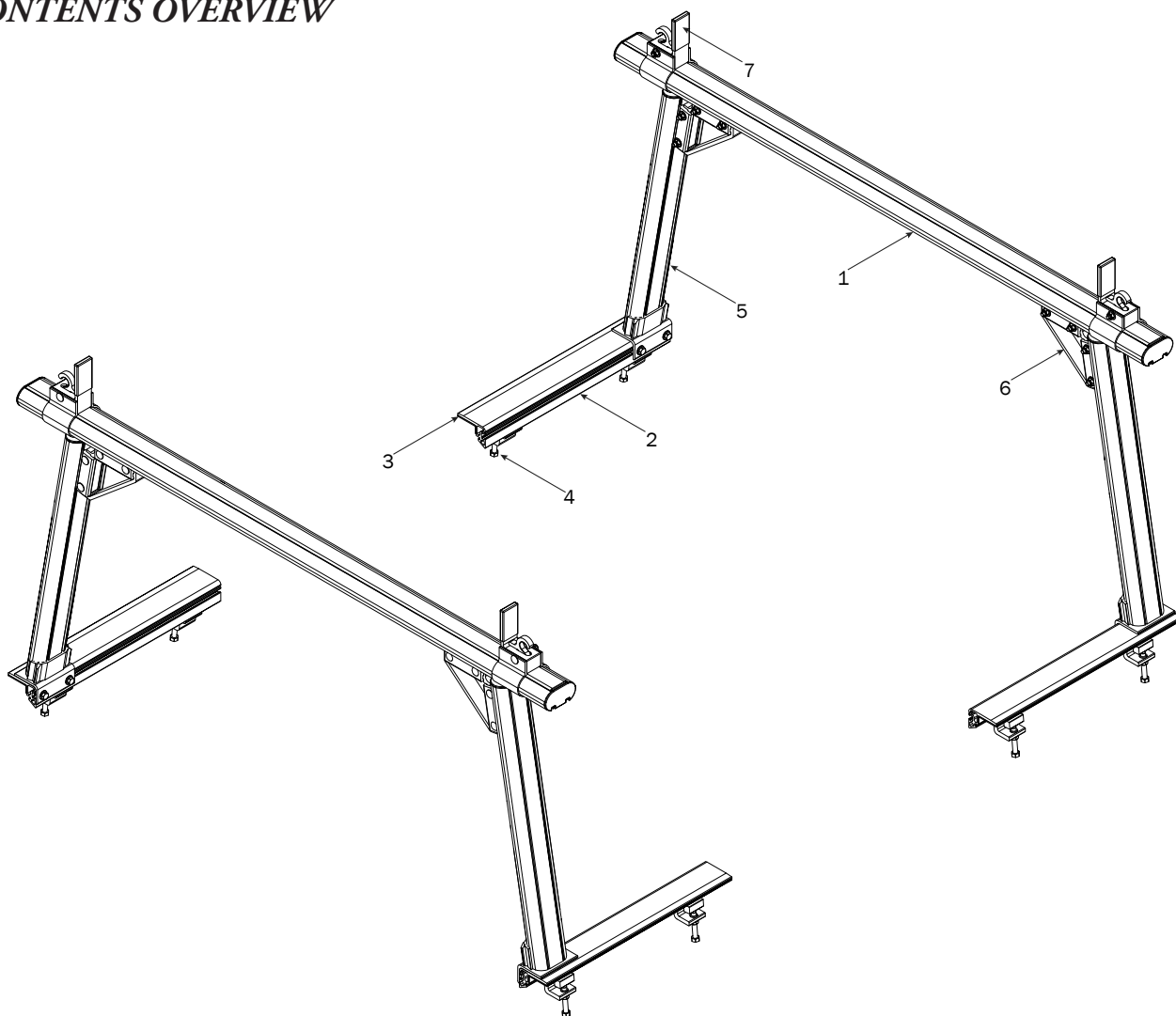

- 1—PTR Crossbars with End Caps (Qty 2)
57.00"

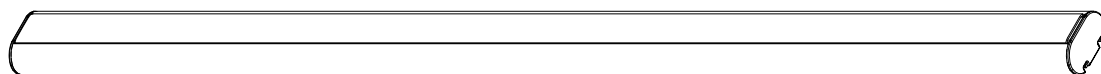

- 2—PTR Mounting Rail (Qty 4)
Raw, 20.00"

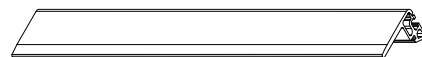

- 3—PTR Bed Rail Padding..... (Qty 4)
PVC, 20.00"

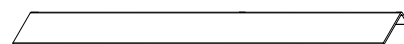

- 4—PTR Tube Foot Clamp..... (Qty 8)

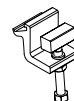

5—PTR Rack Leg with Black End Caps (Qty 4)
25.50"

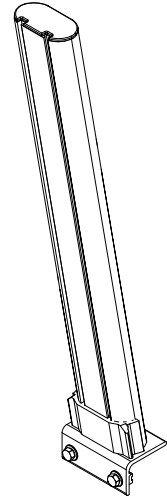

5—PTR Crossbar/Leg Connector Assambly (Qty 4)

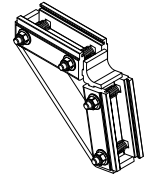

7—PTR Ladder Stop Assy with Black Caps (Qty 4)

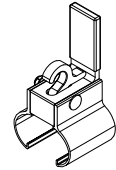

PTR1 ASSEMBLY SEQUENCE

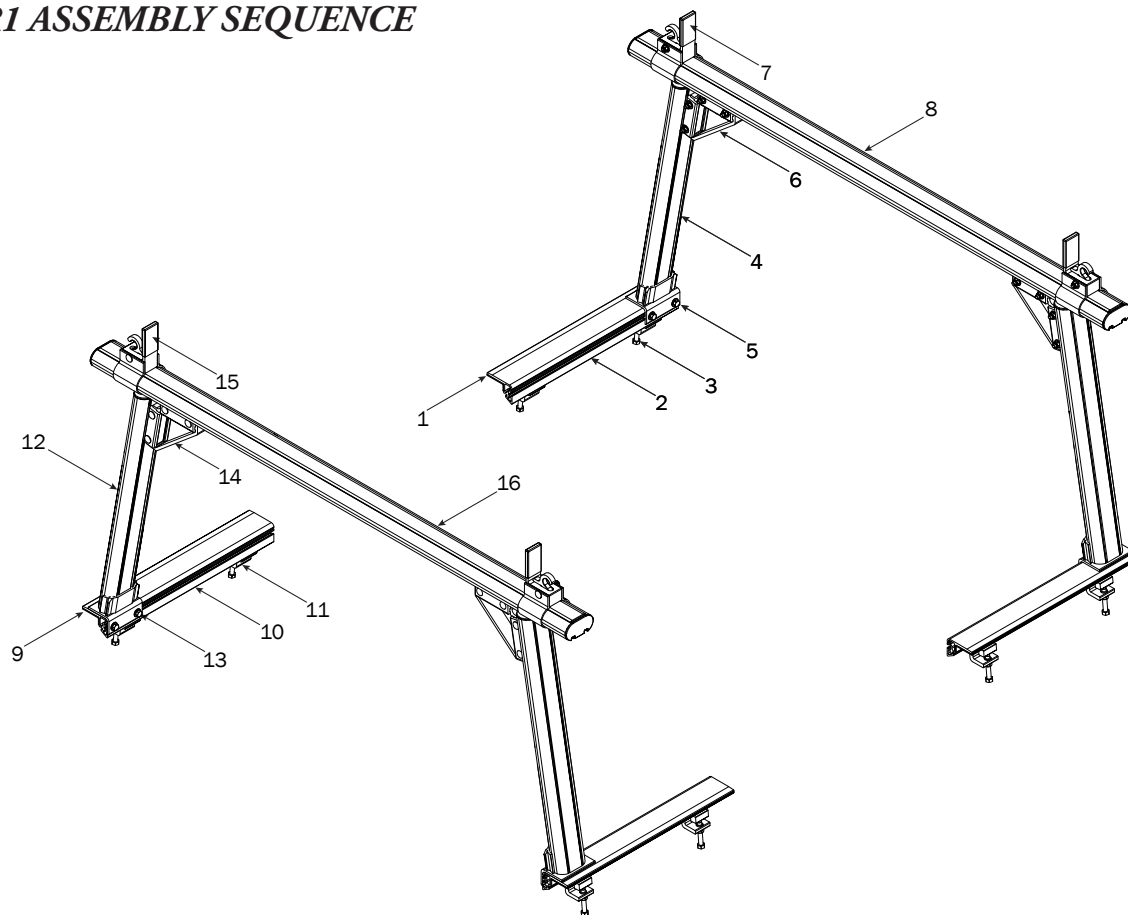

- 1** Place the PTR Foot Pad onto the truck's bed rail.

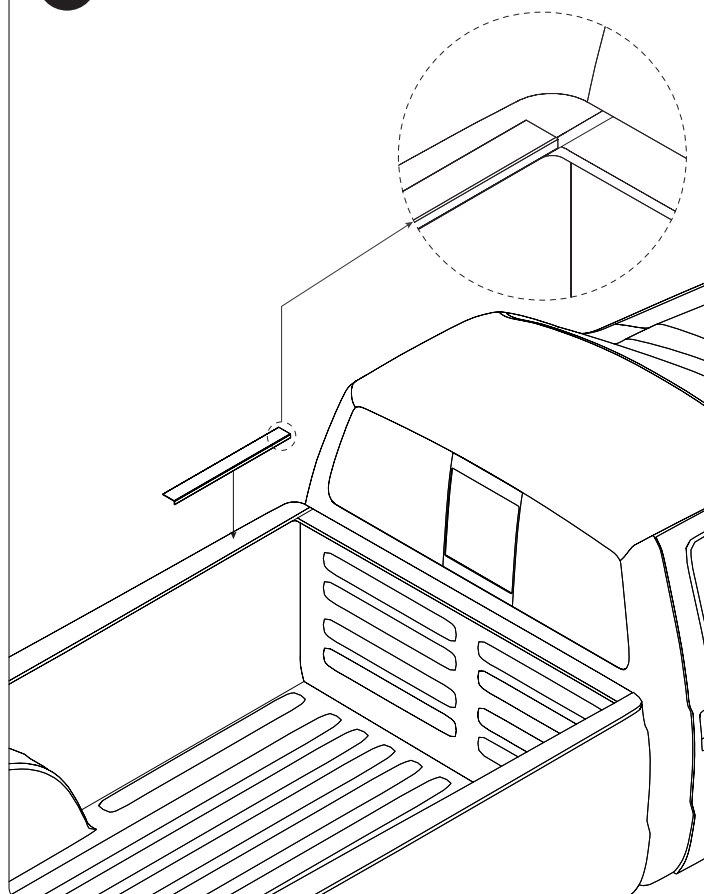

- 2** Place the PTR Tube Foot on top of the bed rail Foot Pad.

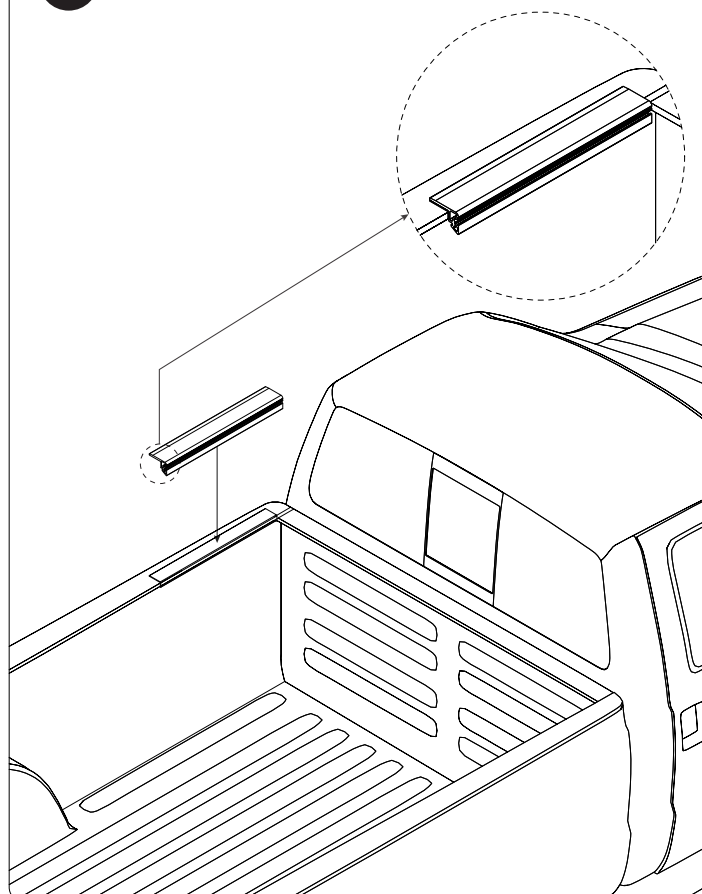

- 3.1** Set Clamps according to Step 3.2 before sliding onto PTR Tube Foot.

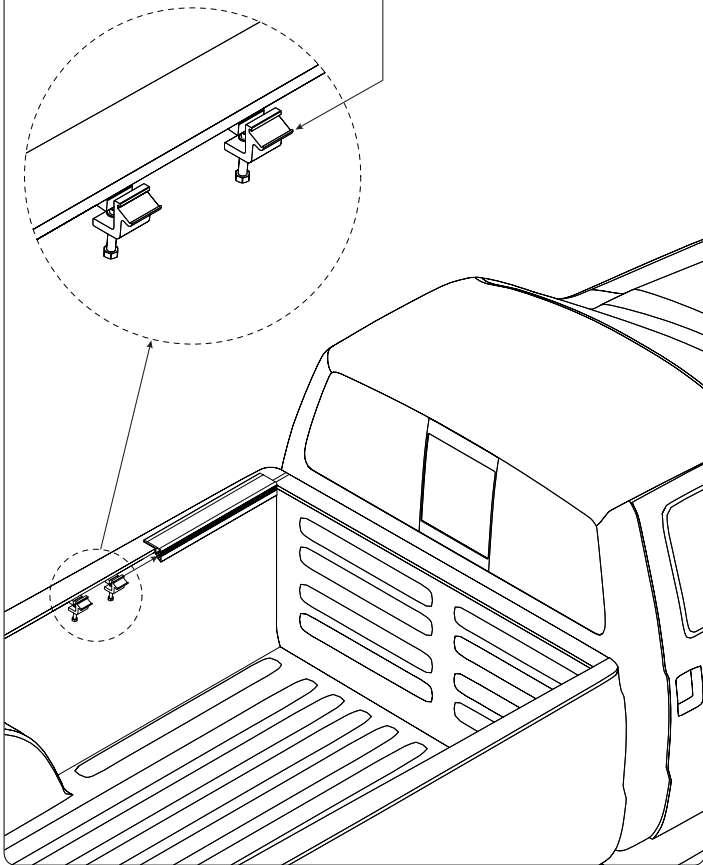

- 3.2** Place Truck Clamp Pad on threaded end of the Tube Foot Clamp Bolt. The Truck Clamp Pad has an offset hole. Set Clamp Pad according to Figures E or F.

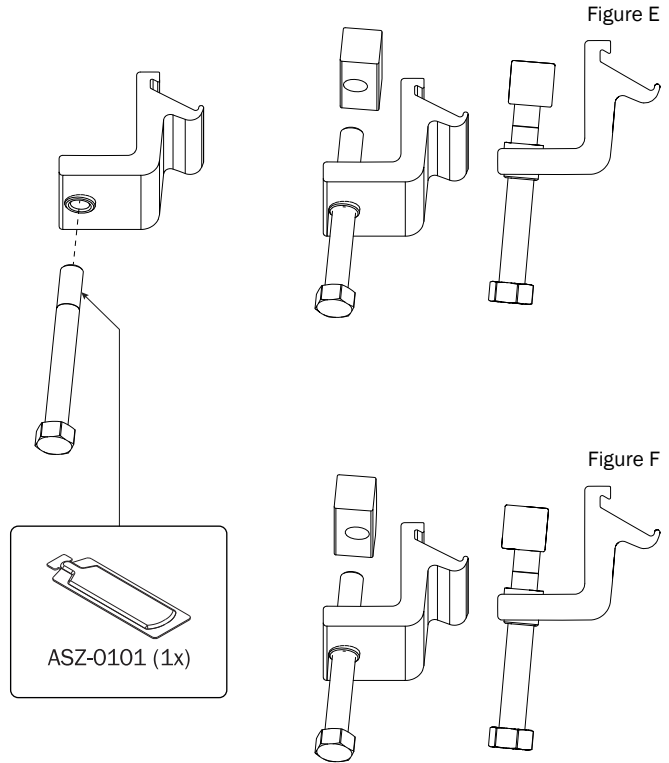

For most applications, the thick side of the Truck Clamp Pad should face inward toward the Tube Foot Clamp as shown in Figure E.

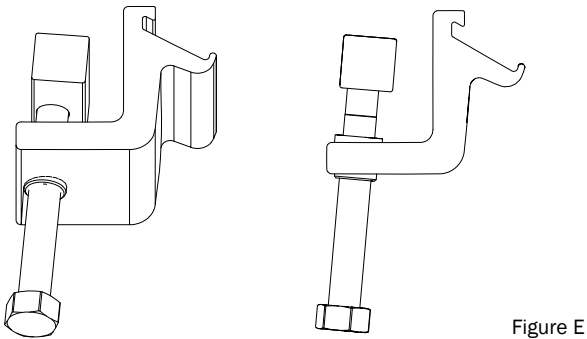

Figure E

Position the Truck Clamp Pad to Figure F if extra clearance is required for a properly seated installation.

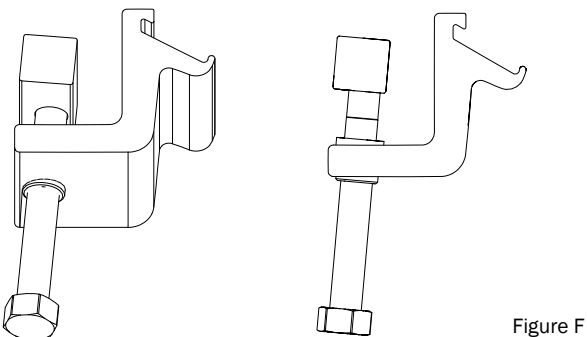
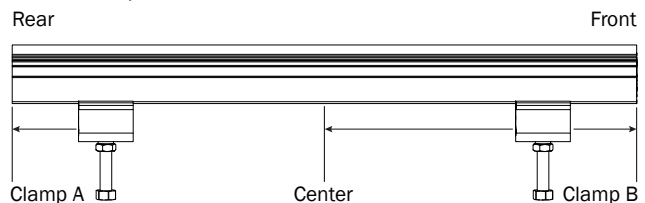
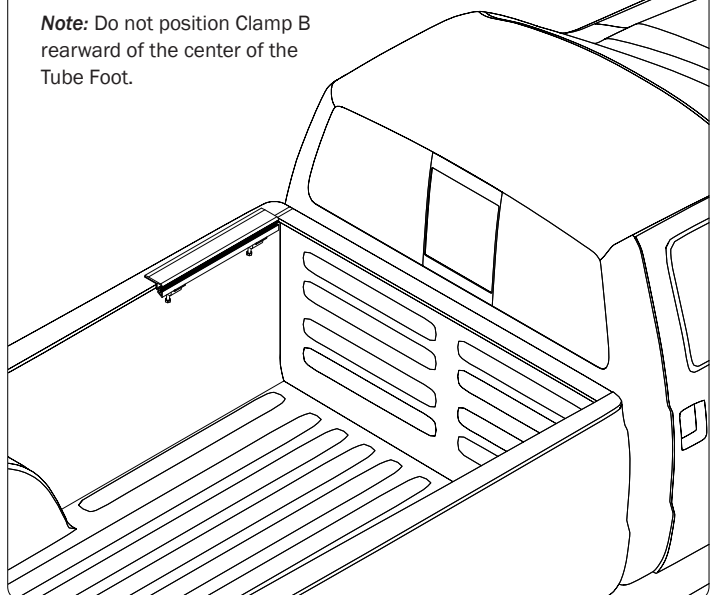

Figure F

- 3.3** Whenever possible, it's preferred to place the Clamps on the thickest metal sections of the bed rail. Place Clamp A as far rearward as possible while still on double wall. Place Clamp B as far forward as possible while still on double wall. Torque Clamp Bolts to 120 in-lbs.



Note: Do not position Clamp B rearward of the center of the Tube Foot.



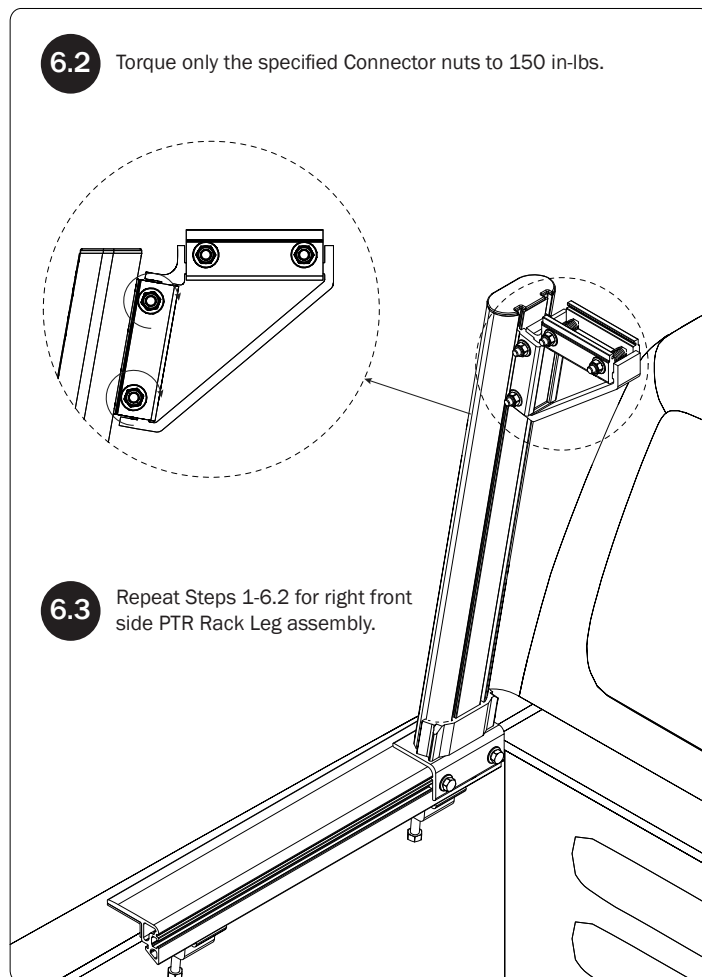
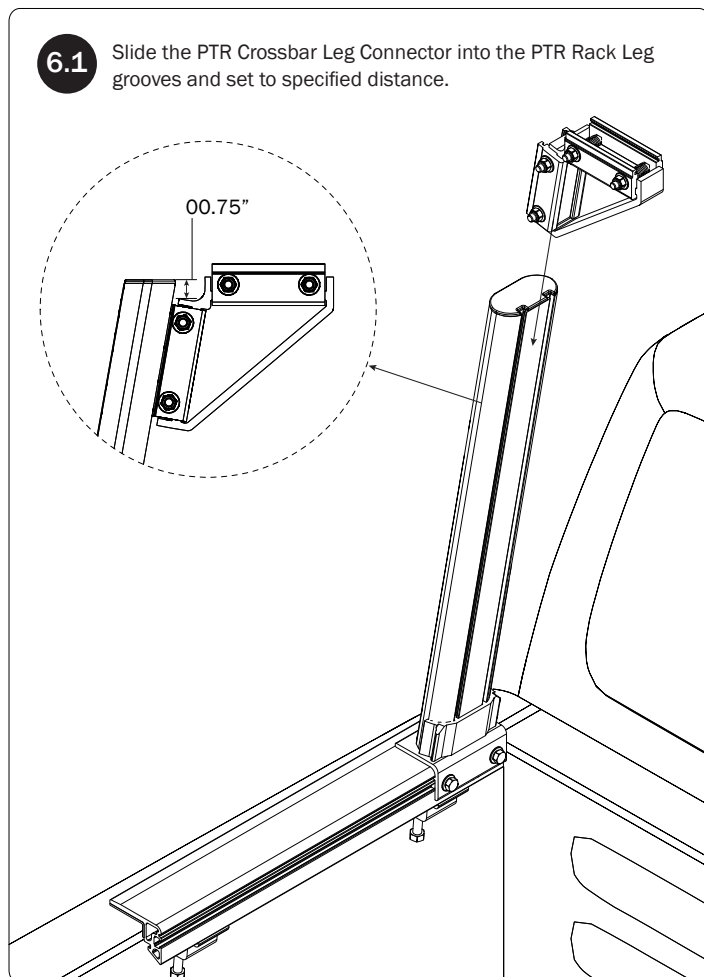
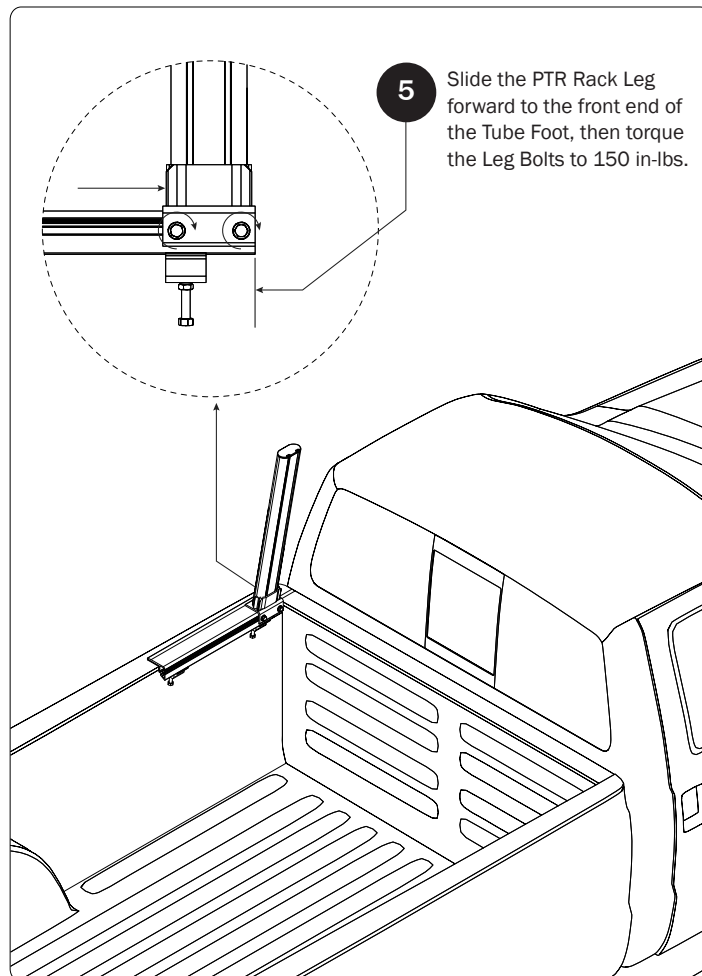
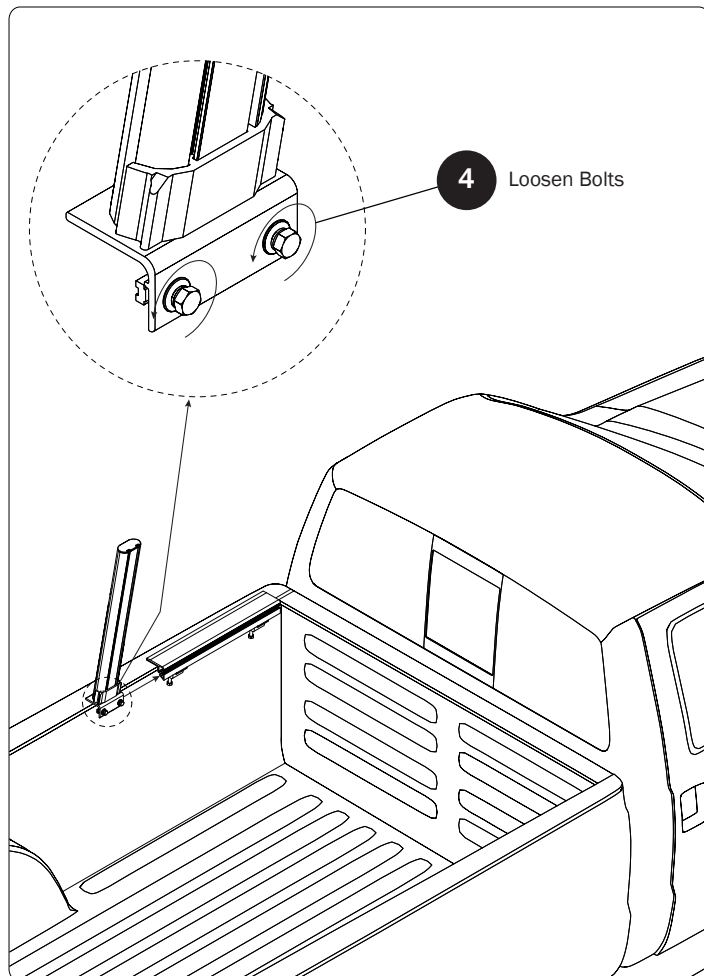

7

Unlock Ladder Stops, then slide onto Crossbar. Place Ladder Stops inward approximately 18" to allow for Crossbar to PTR Rack Leg installation.

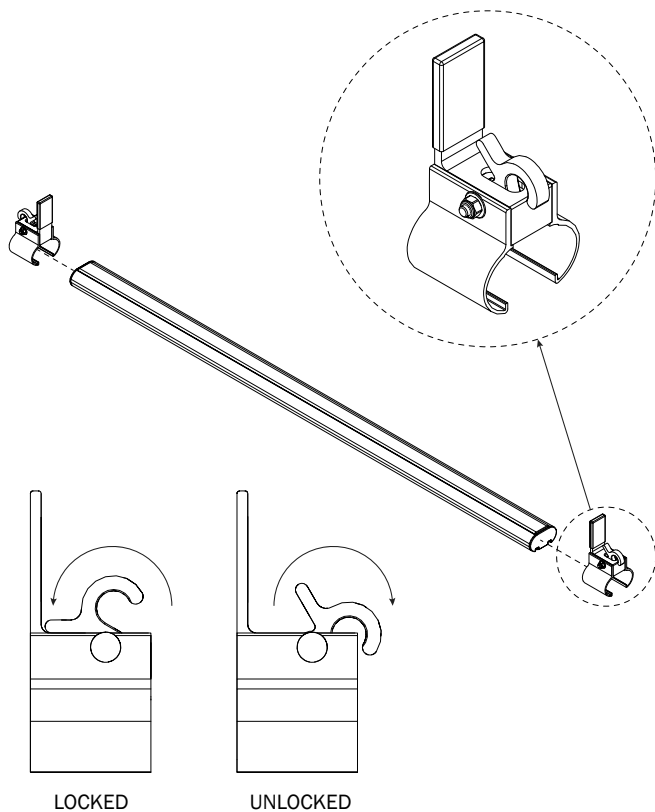

8.1

Place the Crossbar onto the PTR Rack Leg Connectors.

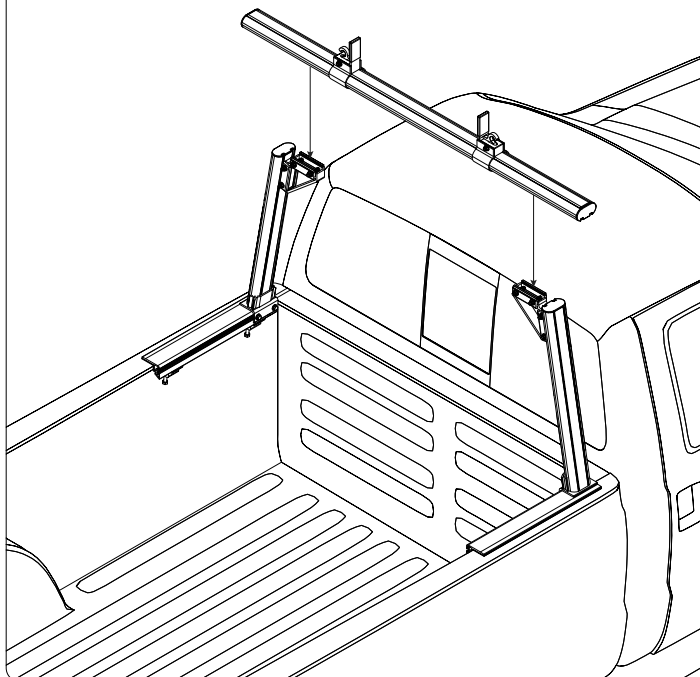

8.2

Center the Crossbar onto the PTR Rack Legs as shown.

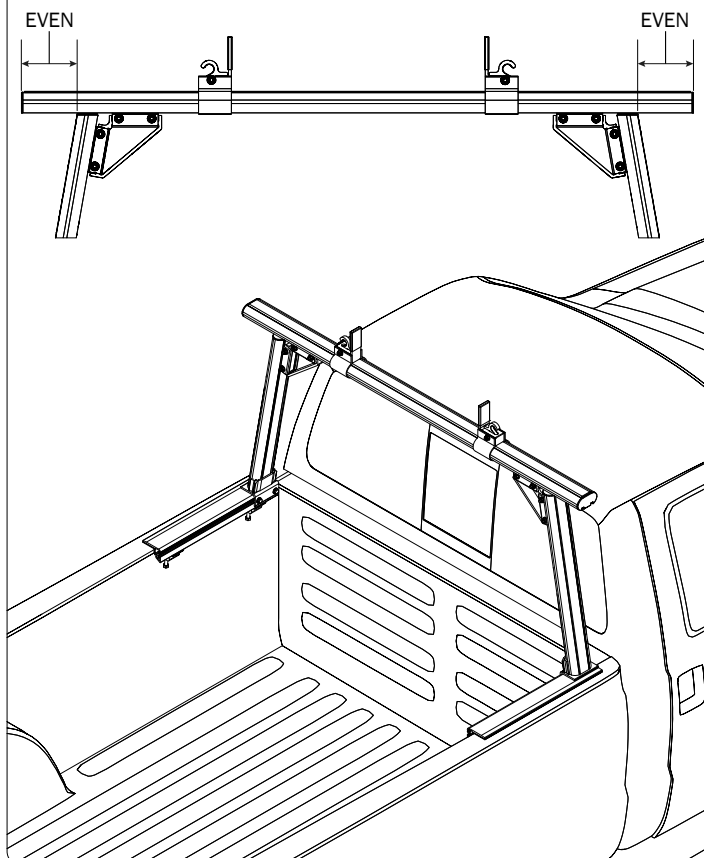

8.3

Torque nuts to 150 in-lbs.

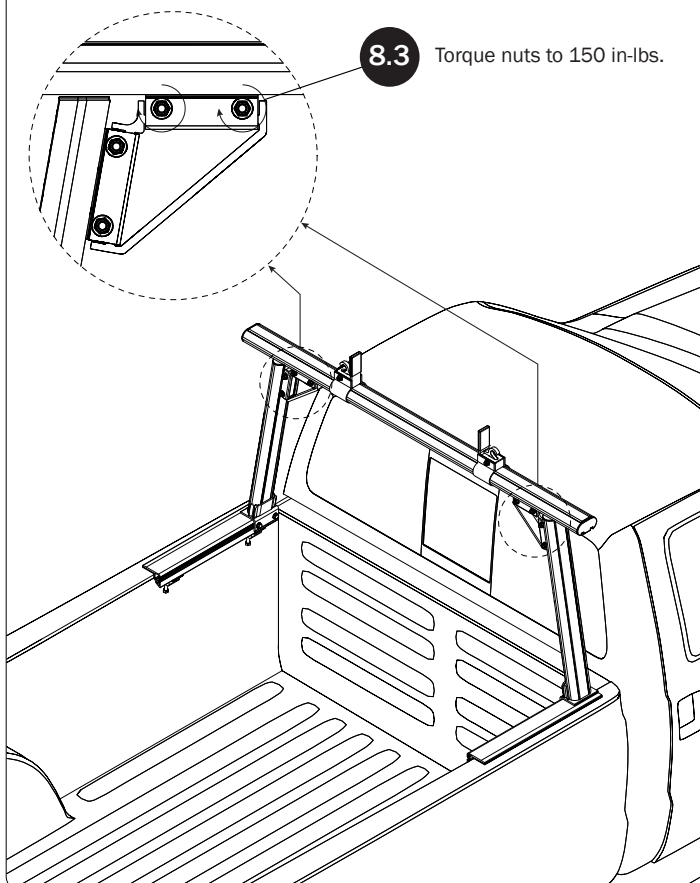

- 9** Place the Foot Pad onto the truck's bed rail.

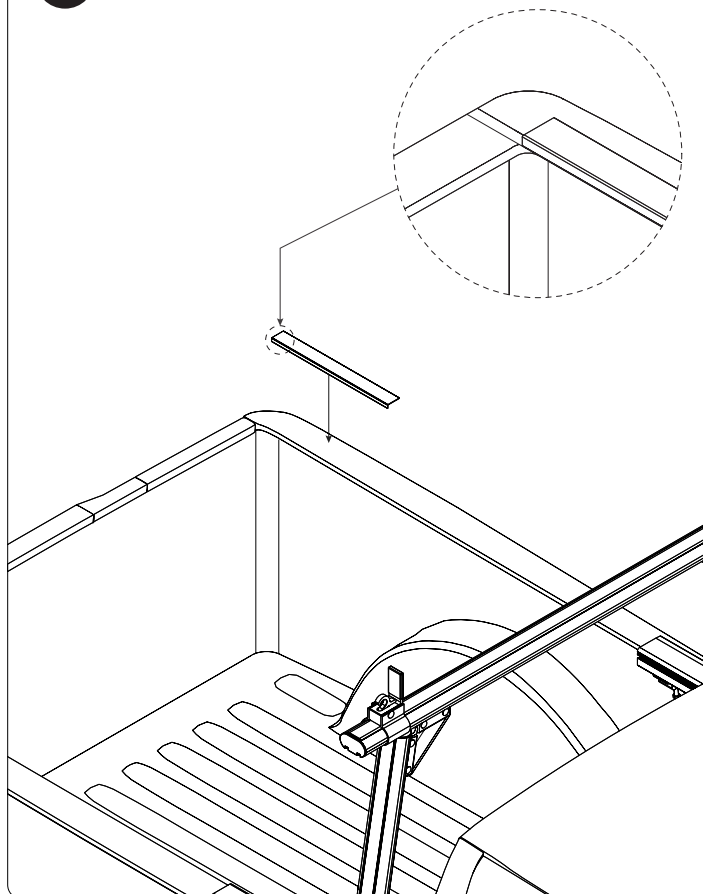

- 10** Place the PTR Tube Foot on top of the bed rail Foot Pad.

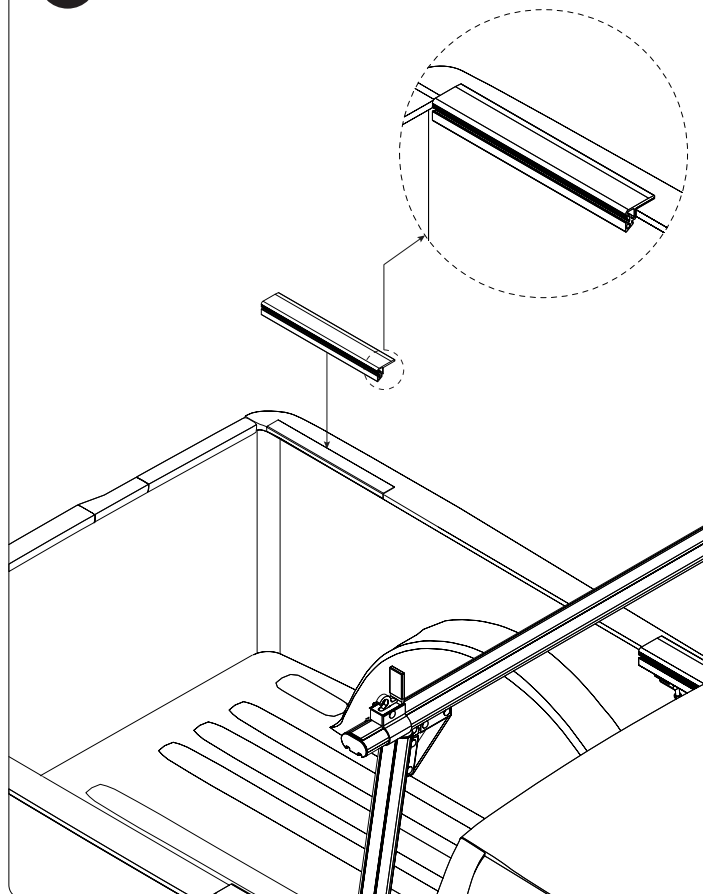

11.1

Set Clamps according to Step 11.2 before sliding onto PTR Tube Foot.

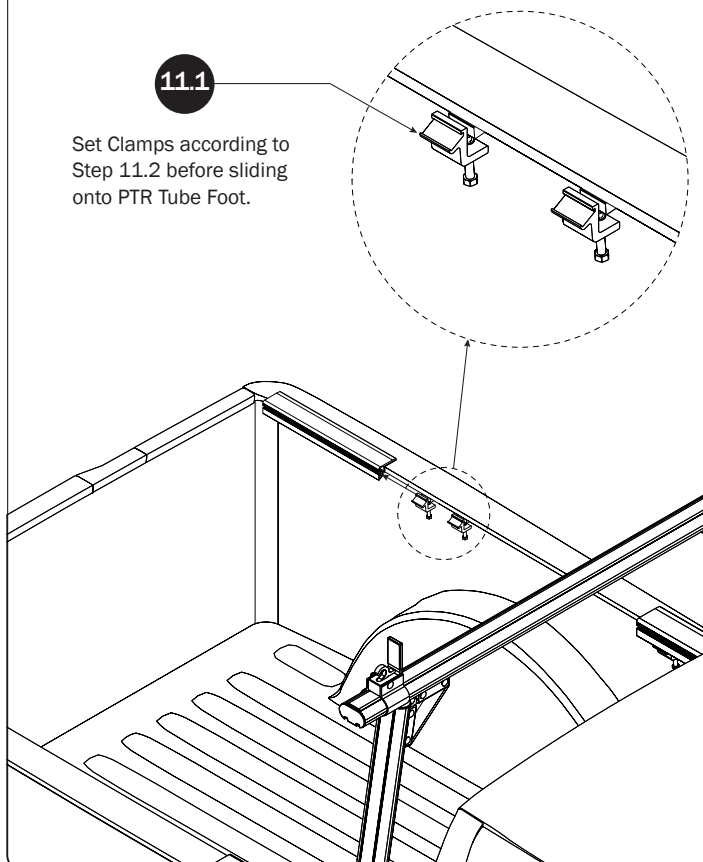

- 11.2** Place Truck Clamp Pad on threaded end of the Tube Foot Clamp Bolt. The Truck Clamp Pad has an offset hole. Set Clamp Pad according to Figures E or F.

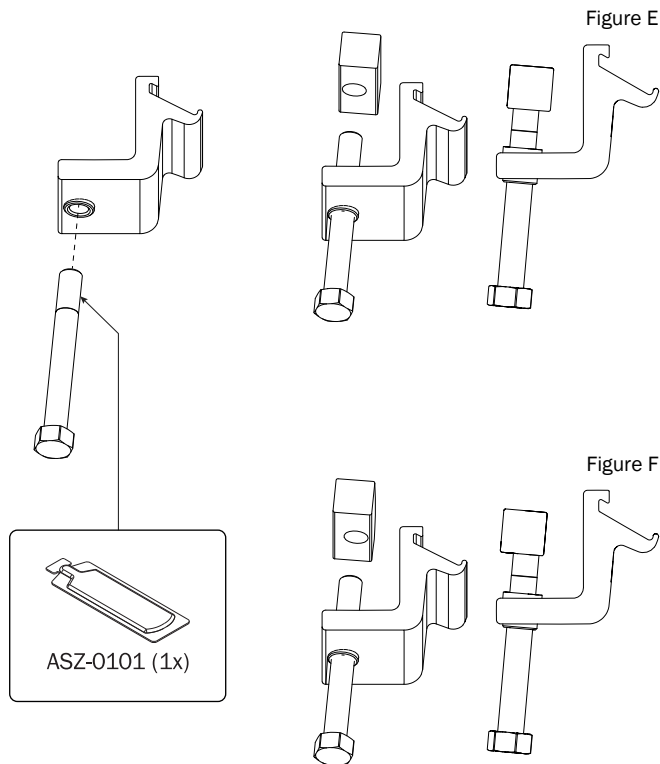

For most applications, the thick side of the Truck Clamp Pad should face inward toward the Tube Foot Clamp as shown in Figure E.

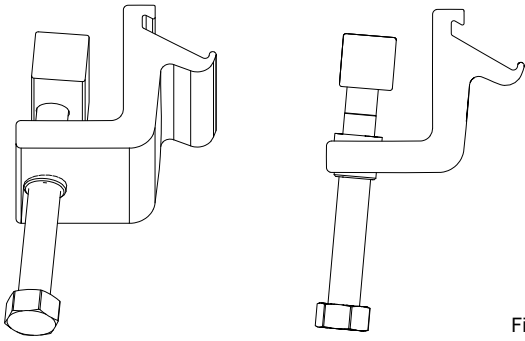

Figure E

Position the Truck Clamp Pad to Figure F if extra clearance is required for a properly seated installation.

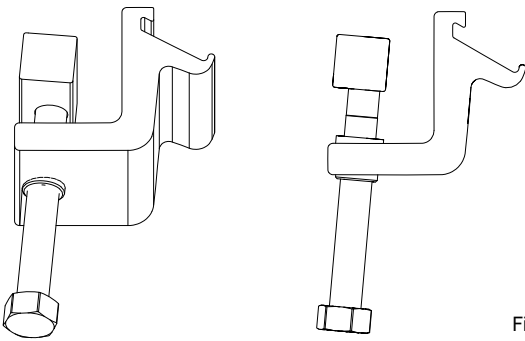
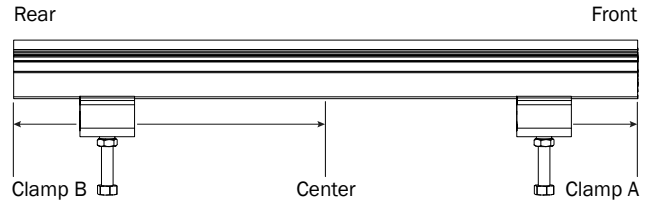

Figure F

11.3

Whenever possible, it's preferred to place the Clamps on the thickest metal sections of the bed rail. Place Clamp A as far forward as possible while still on double wall. Place Clamp B as far rearward as possible while still on double wall. Torque Clamp Bolts to 120 in-lbs.



Note: Do not position Clamp B rearward of the center of the Mounting Foot.

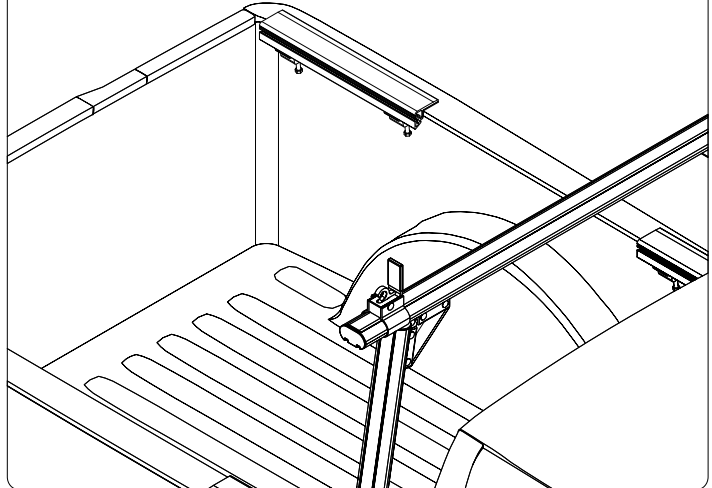

12

Loosen Bolts

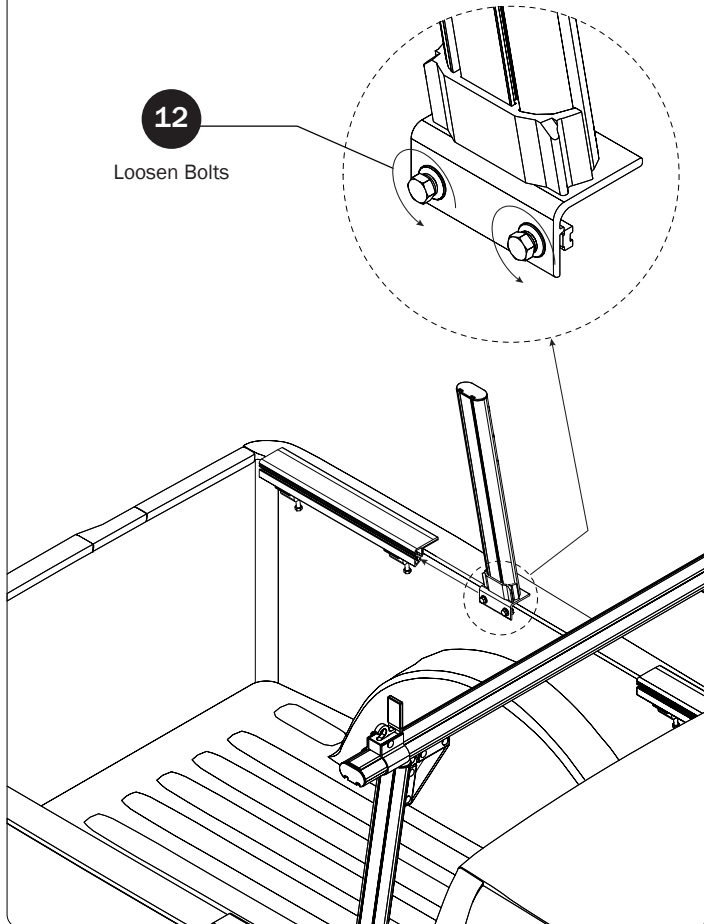

13

Slide the PTR Rack Leg forward to the front end of the Tube Foot, then torque the Rack Leg Bolts to 150 in-lbs.

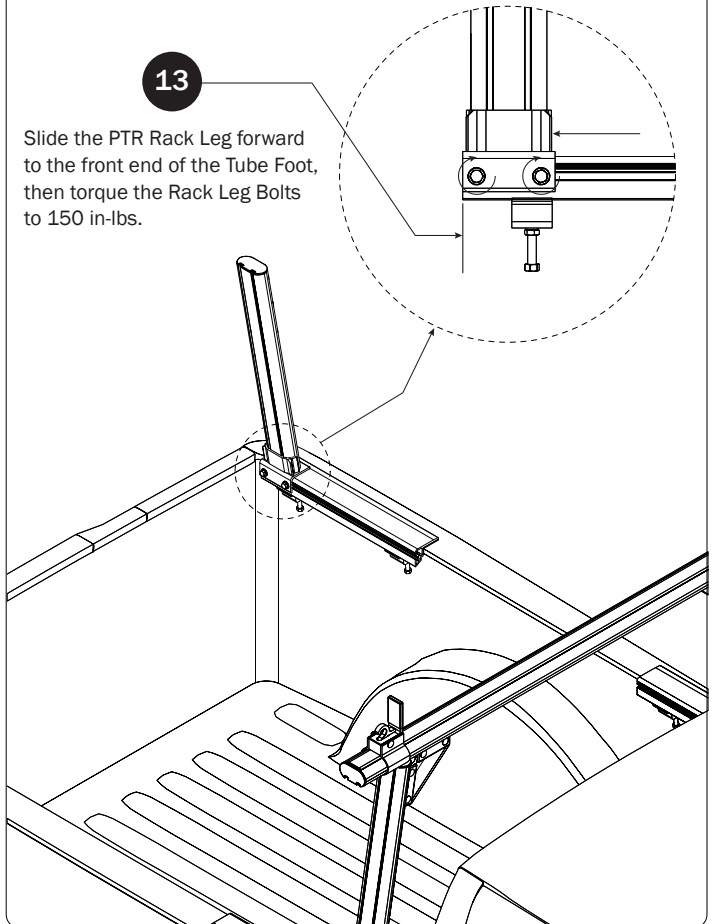

- 14.1** Slide the PTR Crossbar Leg Connector into the PTR Rack Leg grooves and set to specified distance.

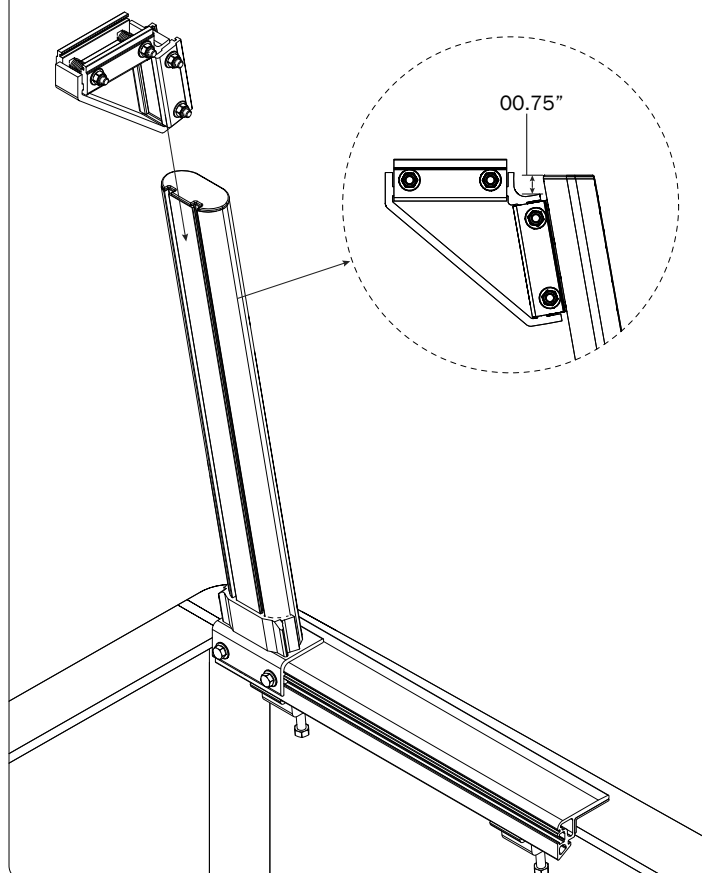

- 14.2** Torque only the specified Connector nuts to 150 in-lbs.

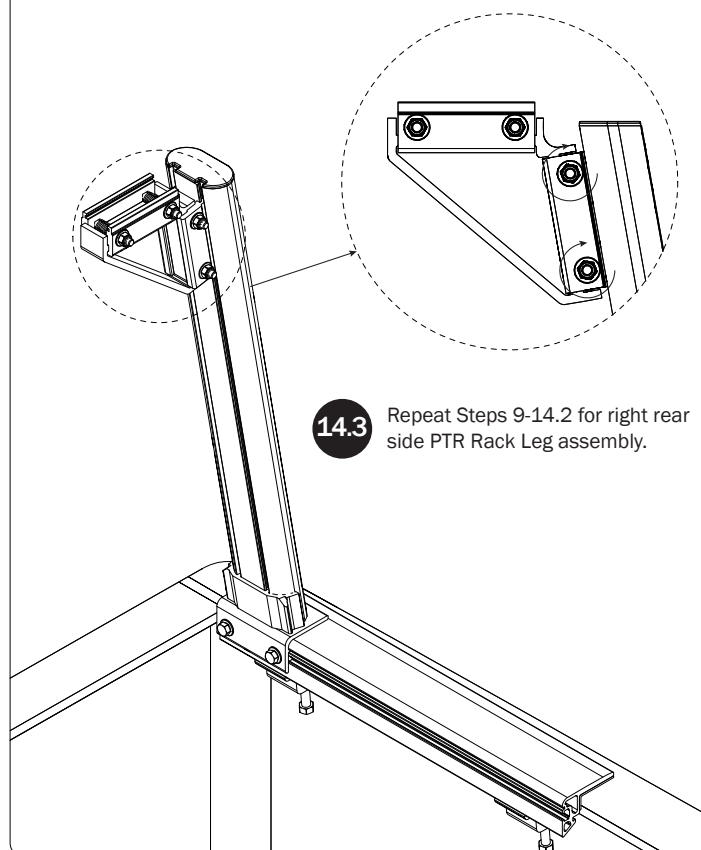

- 14.3** Repeat Steps 9-14.2 for right rear side PTR Rack Leg assembly.

- 15** Unlock Ladder Stops, then slide onto Crossbar. Place Ladder Stops inward approximately 18" to allow for Crossbar to PTR Rack Leg installation.

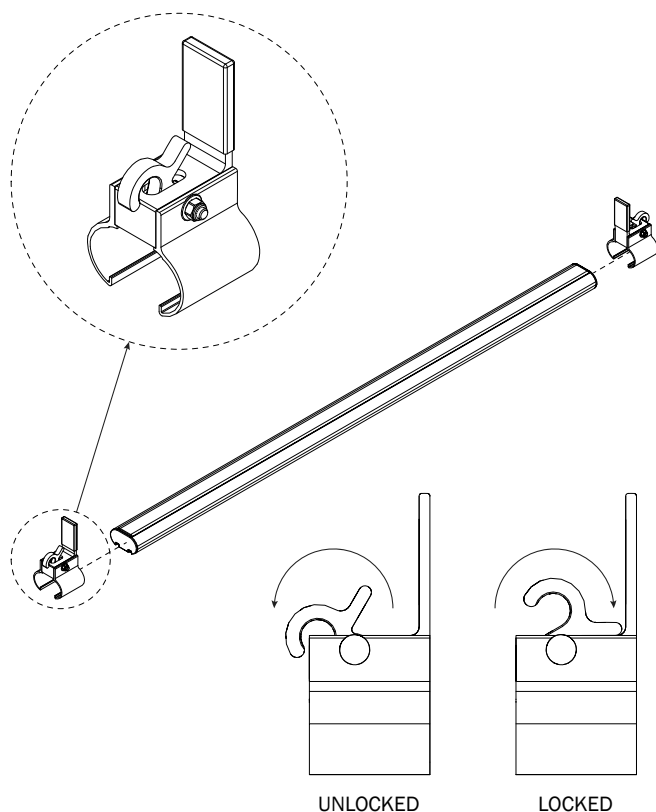

- 16.1** Place the Crossbar onto the PTR Rack Leg Connectors.

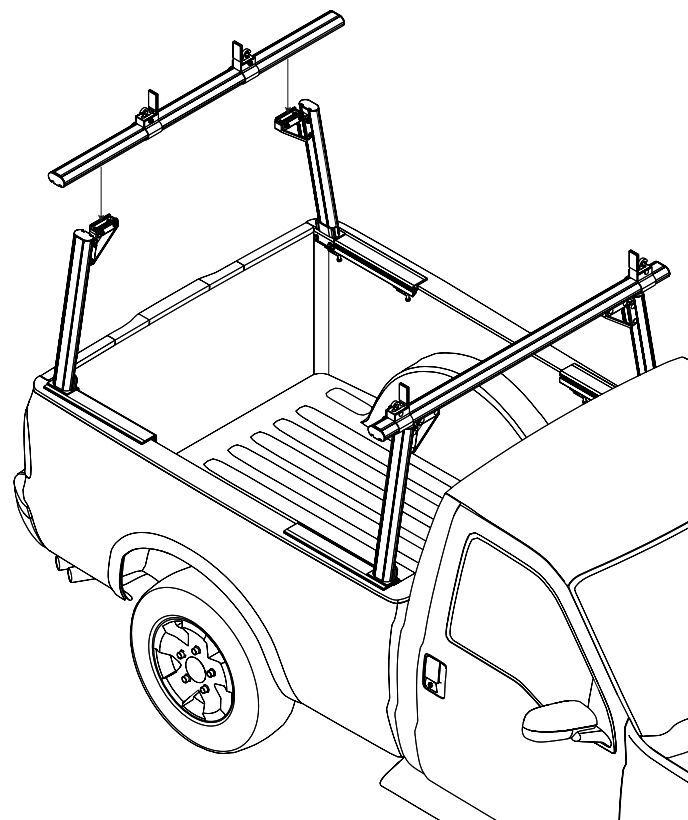

- 16.2** Center the Crossbar onto the PTR Rack Legs as shown.

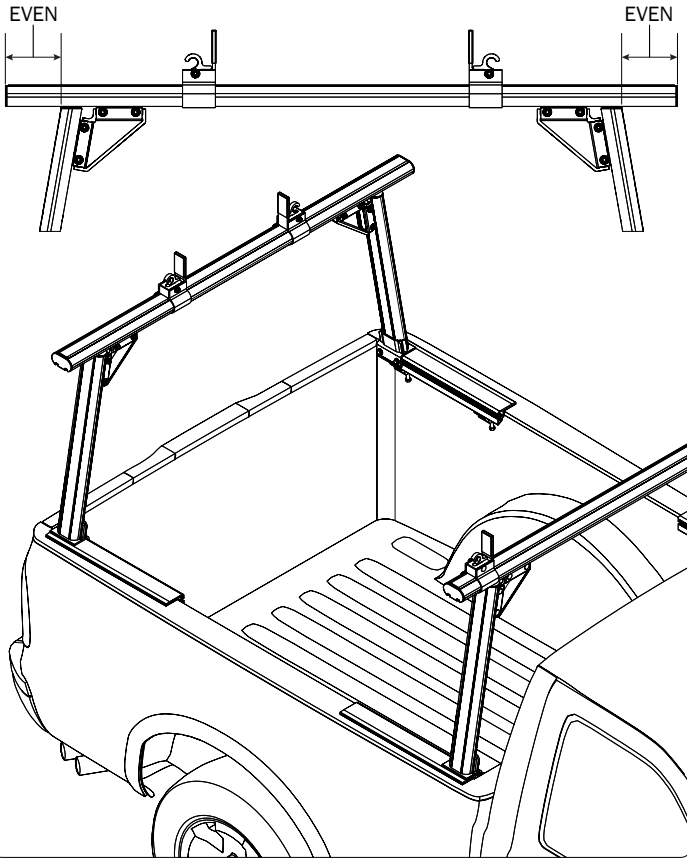

- 16.3**

Torque nuts to 150 in-lbs.

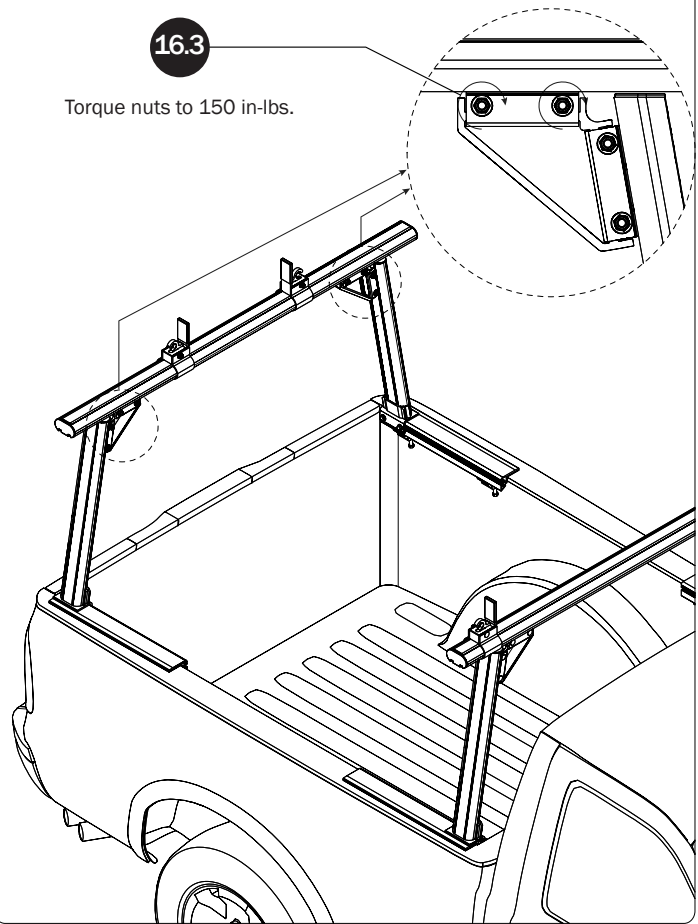

- 17.1** Perform final torque value check for all Tube Foot Clamp Bolts ensuring they are set to 120 in-lbs.
- 17.2** Perform final torque value check for all Leg and Connector Bolts ensuring they are set to 150 in-lbs.
- 17.3** Adjust Ladder Stops on Crossbars to accommodate materials handling.

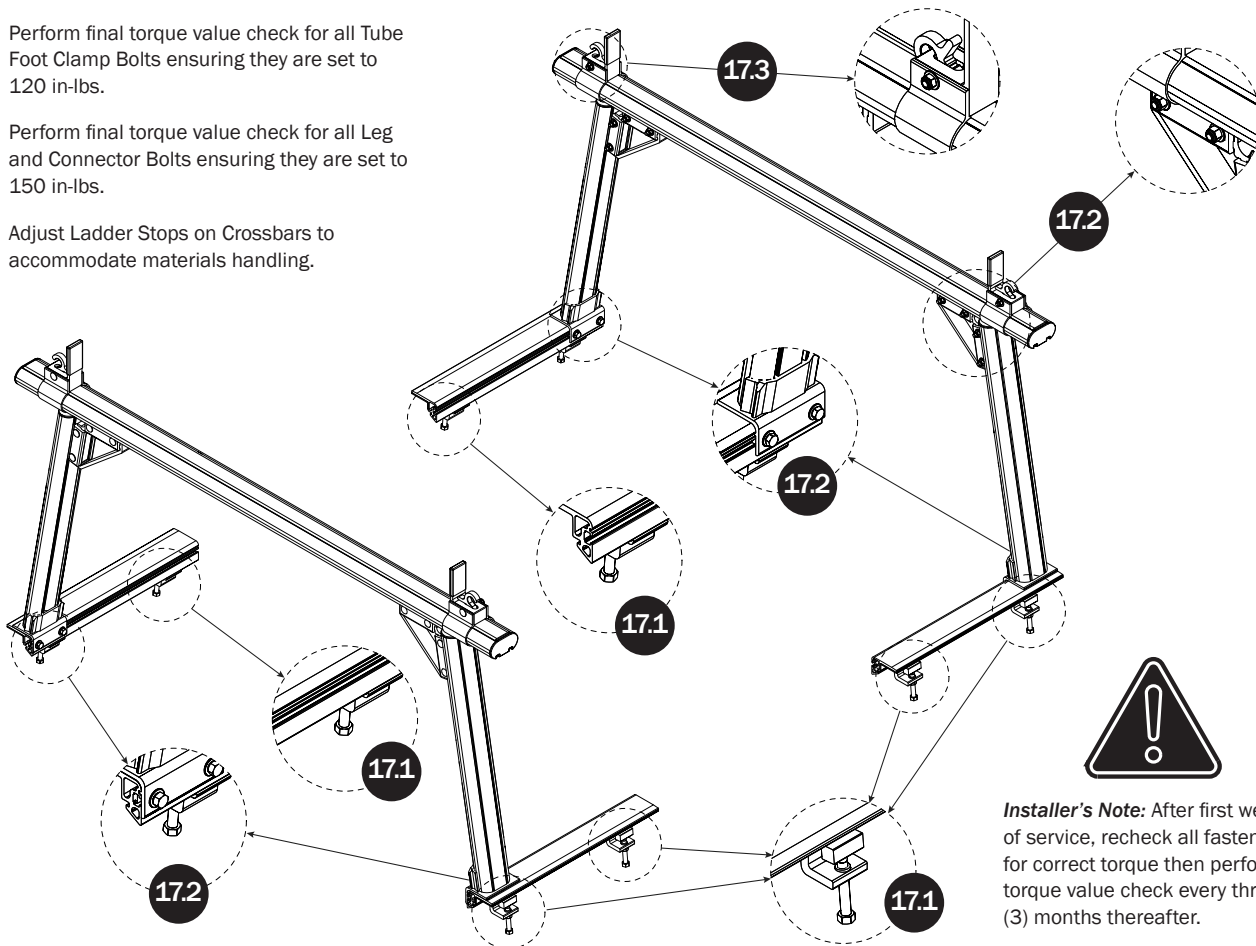

Installer's Note: After first week of service, recheck all fasteners for correct torque then perform torque value check every three (3) months thereafter.

END USER NOTIFICATION: ACCEPTABLE RACK CONFIGURATIONS



Attention End User!

The following installations are to show acceptable configurations of this PTR (Professional Truck Rack).



Entire Rack with front and rear rack assemblies 100% intact.

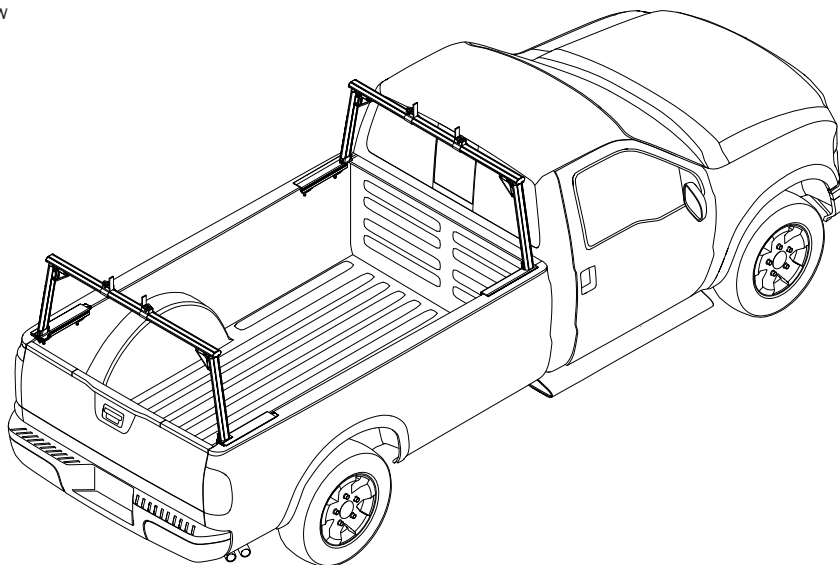

Rack with front rack assembly intact. Rear PTR Leg and Crossbar removed leaving Rear Tube Feet still installed on the bed rails.

Reinstallation of rear PTR Rack requires a simple sliding of the rear PTR Rack Legs and Crossbar as a unitized assembly.

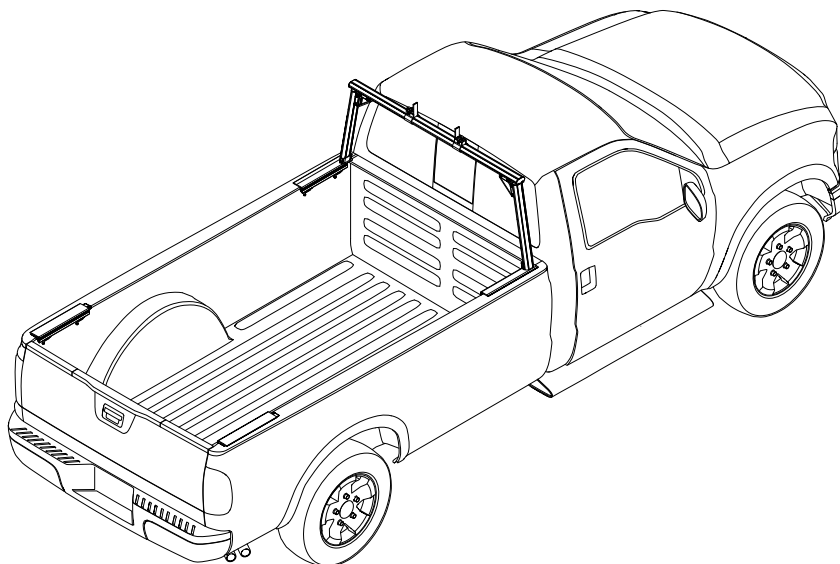

Never operate the vehicle with the rear Crossbar removed. Lack of Crossbar support may result in damage to the truck's bed rails and/or loss of the PTR Rack Legs and Tube Feet w/Pads.

