

PRIME DESIGN™

A Safe Fleet Brand

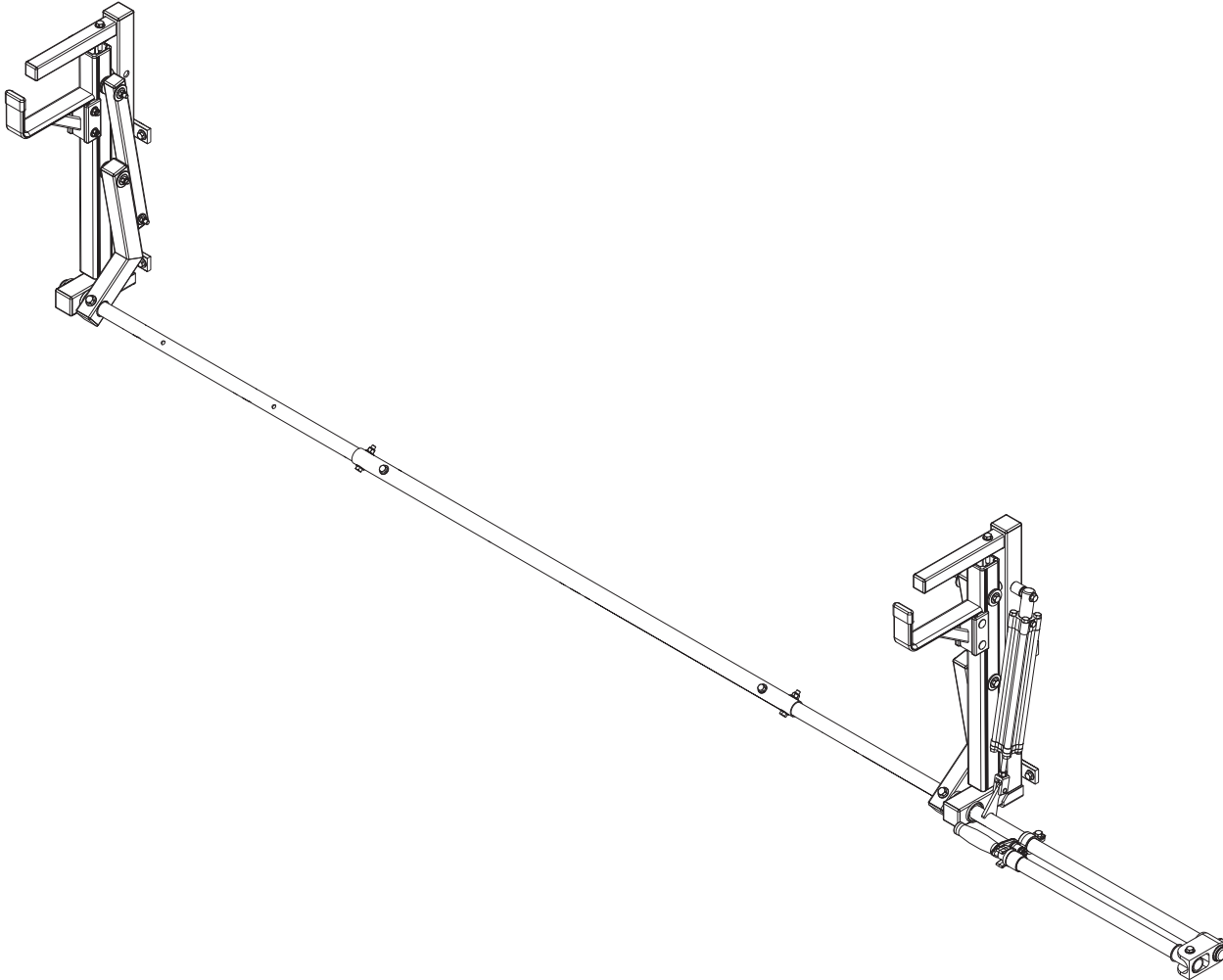

1152 UVX

CONTENTS OVERVIEW

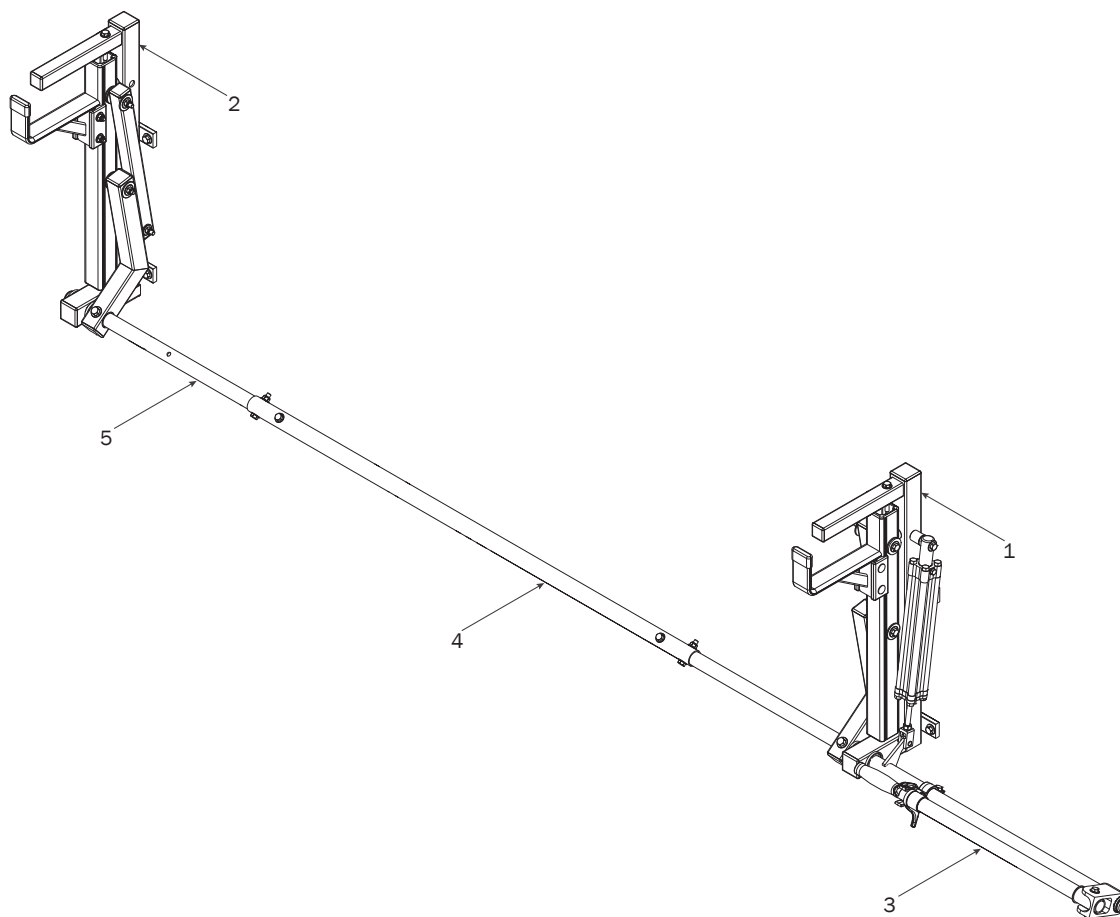

1—Rear Rotation Assembly..... (Qty 1)

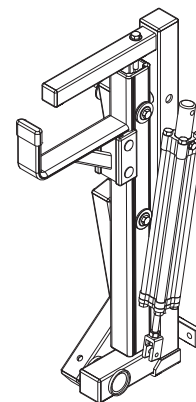

2—Front Rotation Assembly..... (Qty 1)

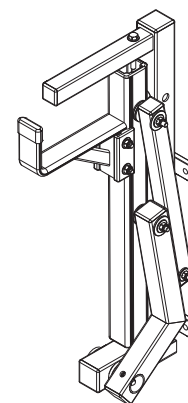

3—Rear Drive Shaft..... (Qty 1)
Left Hand, 50.00"

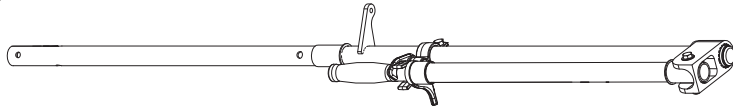

4—Connecting Bar..... (Qty 1)
48.00"



5—Front Drive Shaft..... (Qty 1)
B Version, 35.75"

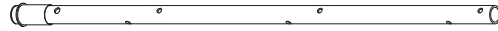

HKT-8102-Rotation Hardware Kit

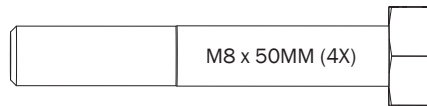

M8 x 50MM (4X)

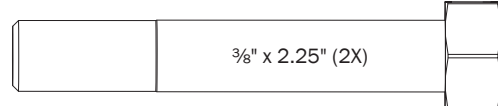

3/8" x 2.25" (2X)



Cotter Pin (1X)



Clevis Pin (1X)



M8 Lock Nut (4X)

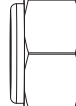

3/8" Lock Nut (2X)

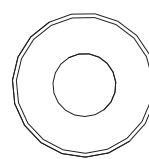

5/16" Flat Washer (8X)

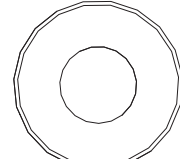

3/8" Flat Washer (4X)

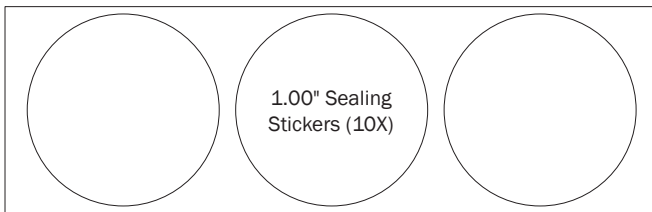

1.00" Sealing
Stickers (10X)



Anti-Seize (1X)



Lubricant (1X)

Mounting Hardware

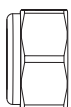

M8 Lock Nut (8X)

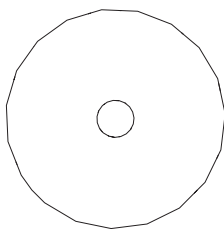

Neoprene Washer (8X)

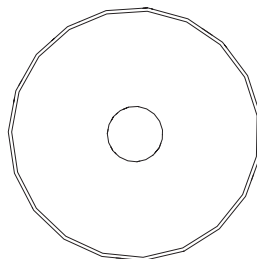

Fender Washer (8X)

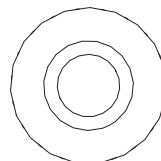

5/16" Seal Washer (8X)

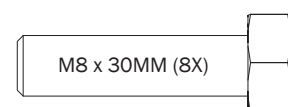

M8 x 30MM (8X)

0.1 6.00-8.00 Ft: Drill holes into the Service Body mounting location according to dimensions shown.

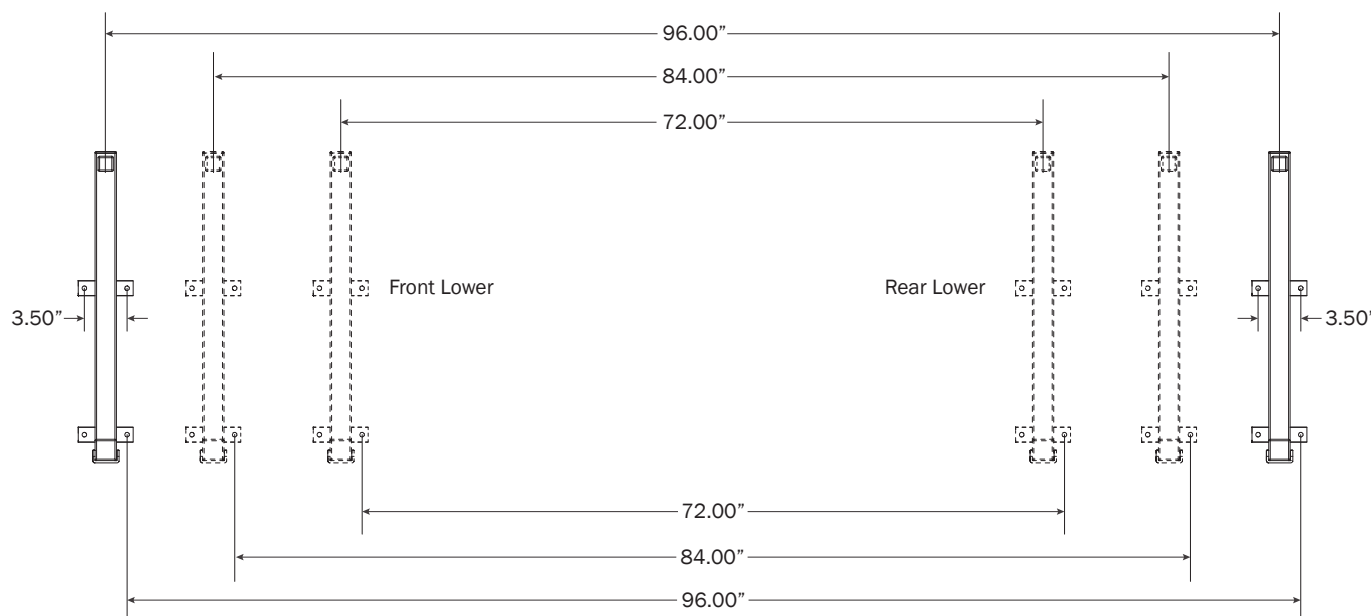

- 0.2** Position and align the vertical Uprights until the mounting holes realign to the body holes drilled during Steps 0.1.

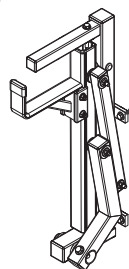

- ### 0.3
- Using the fastening hardware shown below, attach the vertical Uprights to the Utility Body. The Neoprene Washer, Fender Washer, and Locknut install from the inside of the Utility Body in the order shown, while the Bolt and Seal Washer install from the outside.

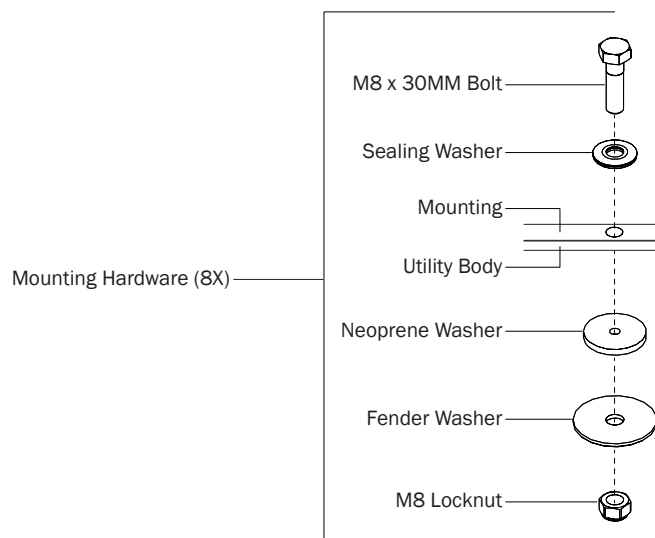

- 0.4** Torque to 90 in-lbs

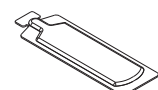
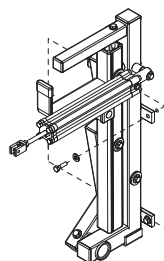

Anti-Seize
Must apply Anti-Seize
Compound and torque
to specified value.

LEFT ROTATION ASSEMBLY SEQUENCE

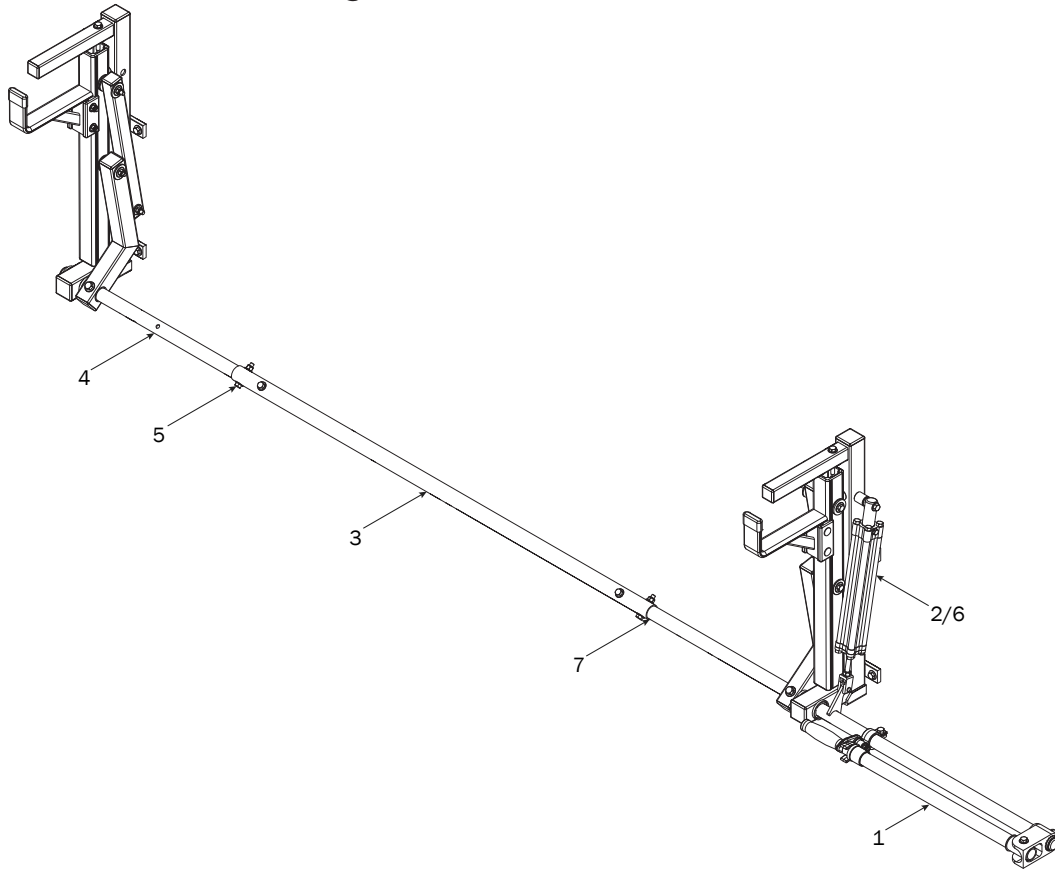

REAR DRIVE SHAFT

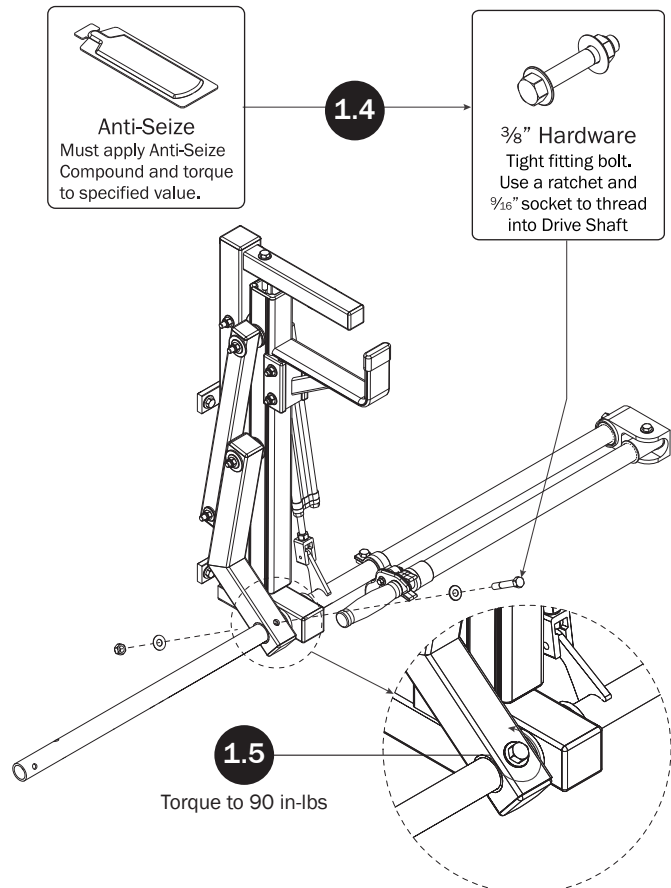
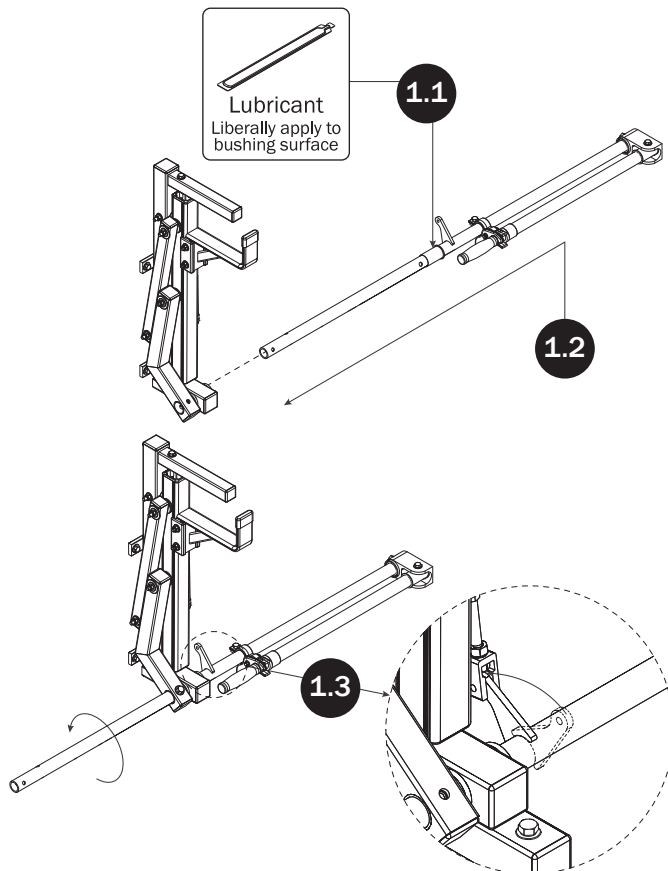

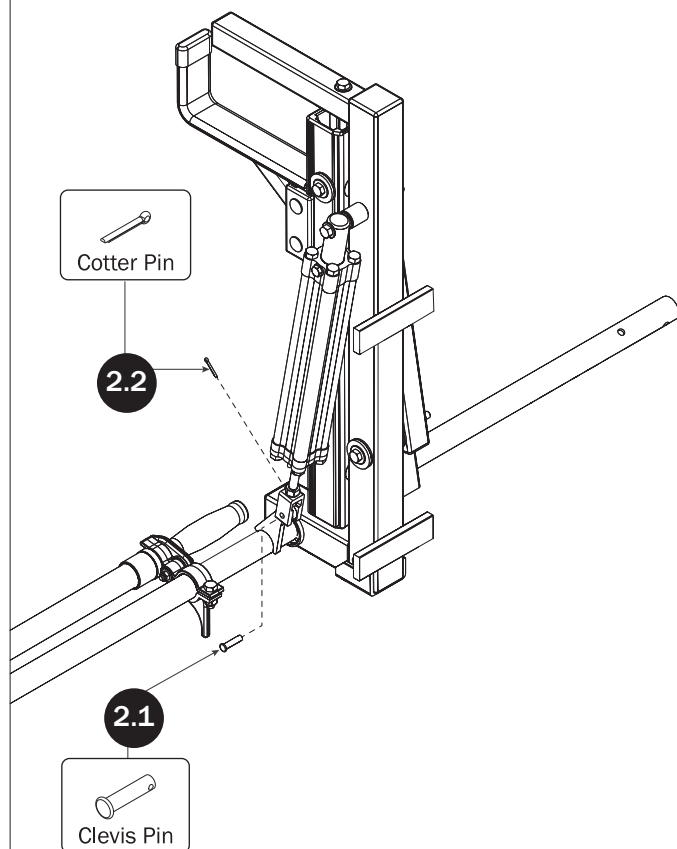
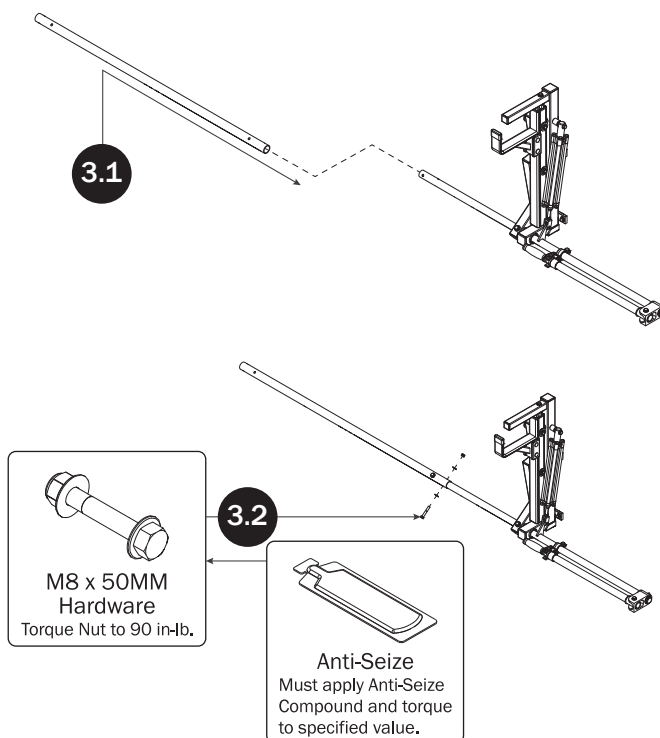
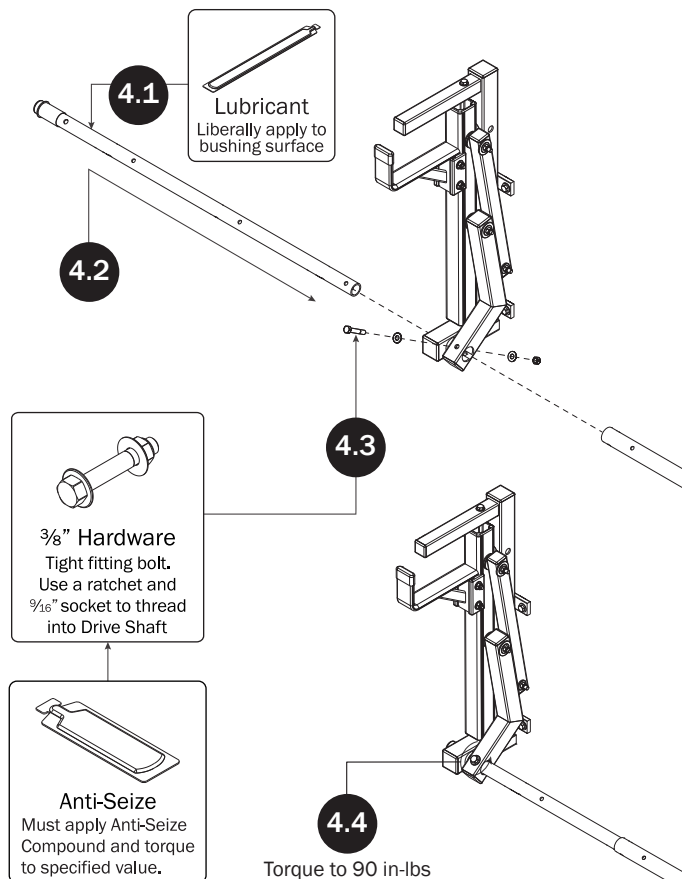
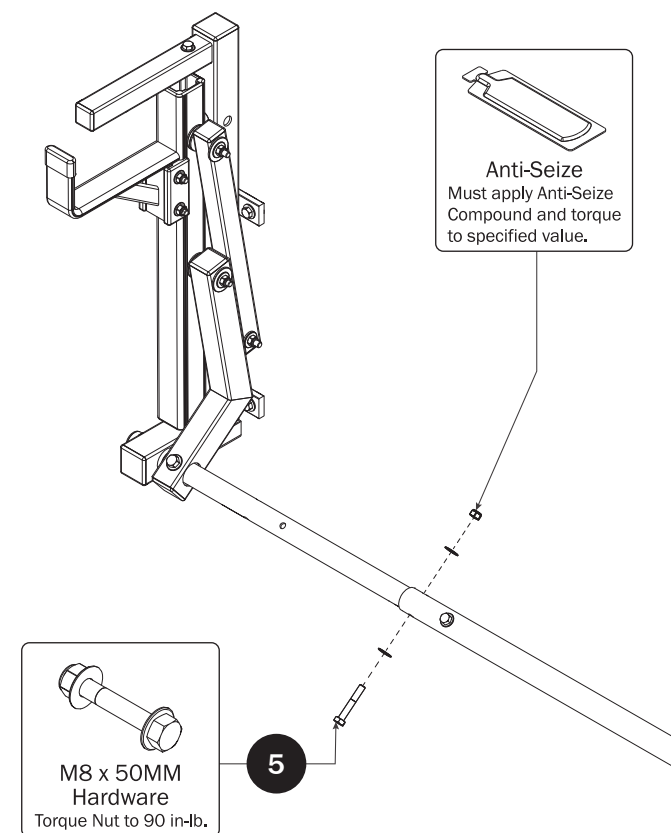
CYLINDER HARDWARE**CONNECTING BAR****FRONT DRIVE SHAFT****CONNECTING BAR FASTENERS**

CYLINDER ADJUSTMENT

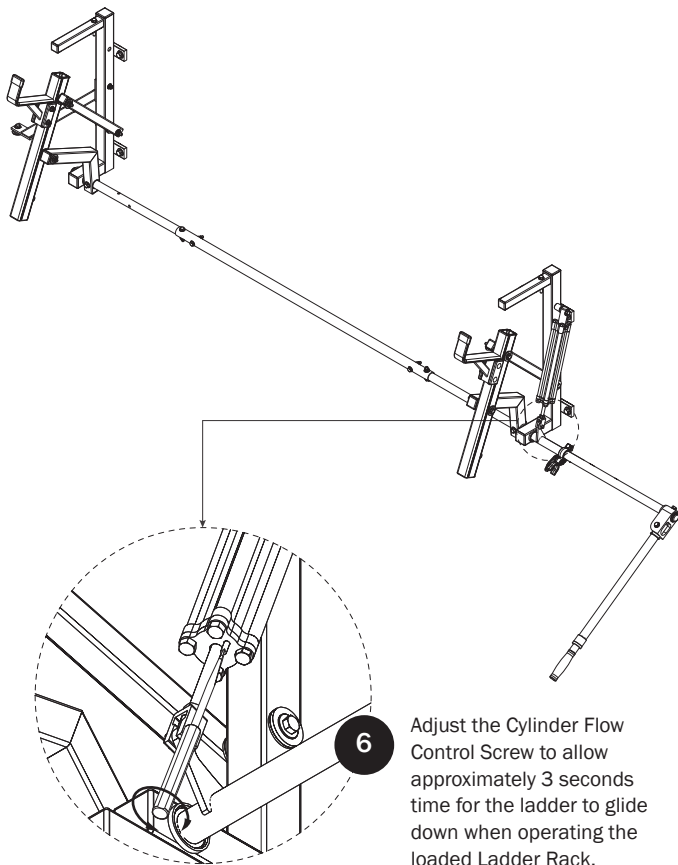

DRIVE SHAFT SEALING

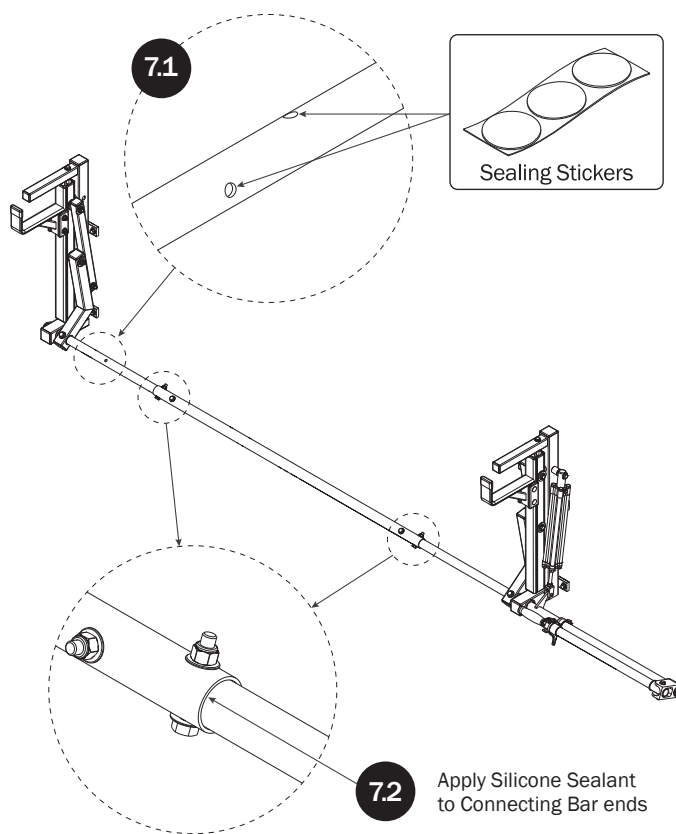

ADDITIONAL INFORMATION

For additional information regarding your UVX-211 Ladder Rack, please visit the Prime Design website at: www.primedesign.net.

Using a QR code reader in your smart phone or tablet, read the QR Code shown below and follow the same steps as you would from your laptop or computer.

If you're viewing this document as an interactive PDF, you may simply click on the QR Code below to access the Prime Design website.



