

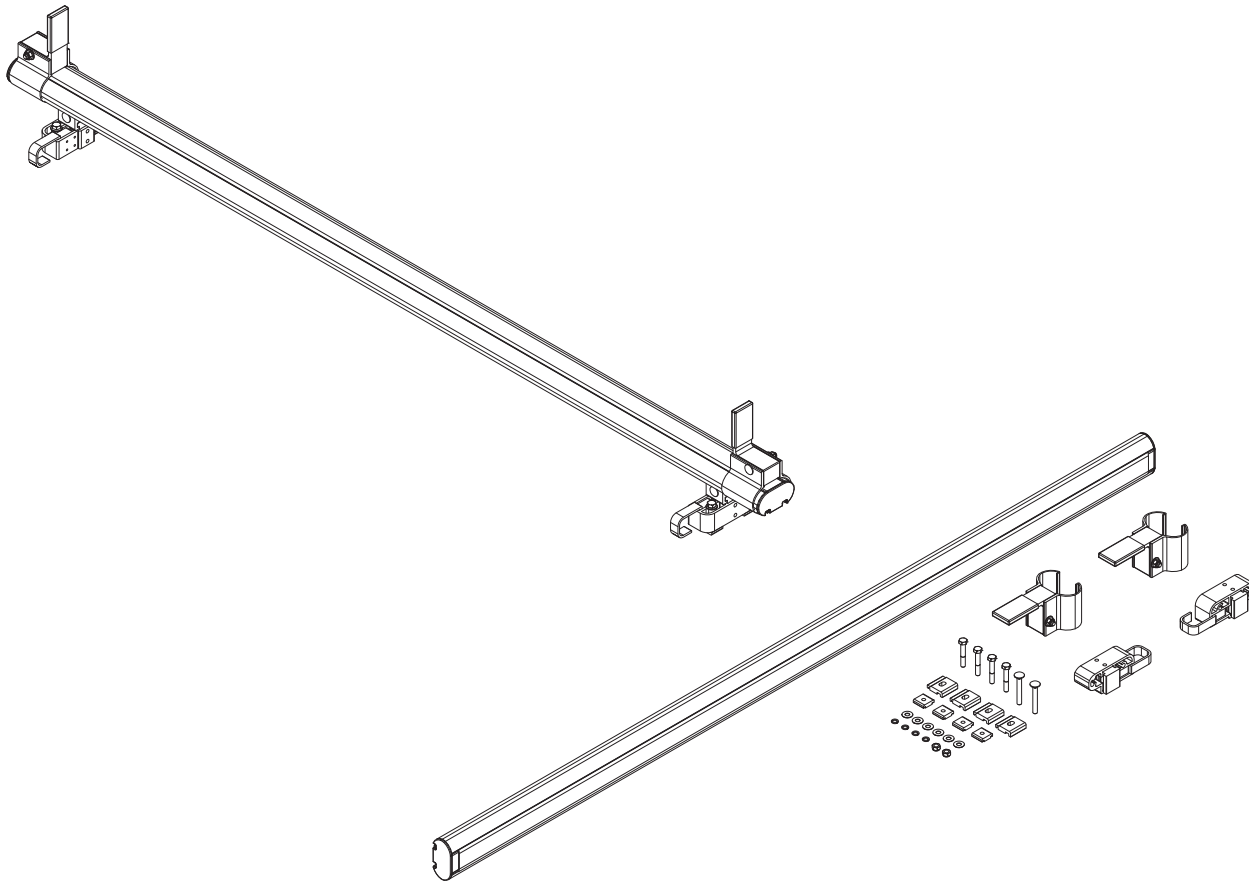

**Industrial
Products®**

PRIME DESIGN™

A Safe Fleet Brand



OVER THE CAB ADD-ON CROSSBAR

OCM-3032

CONTENTS OVERVIEW

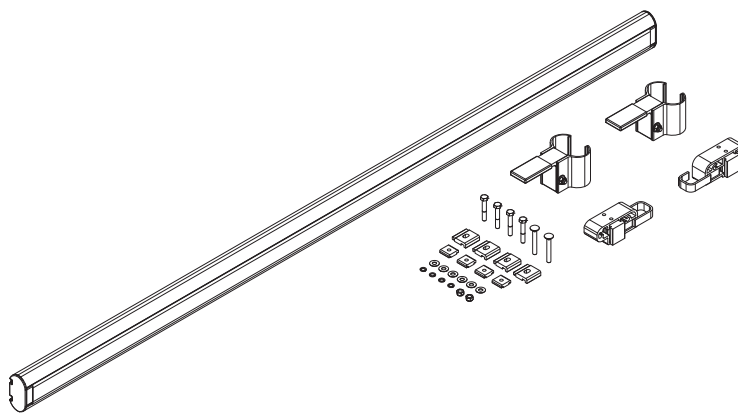

Pickup Crossbar (Qty 1)
67.00", with Caps and Hardware

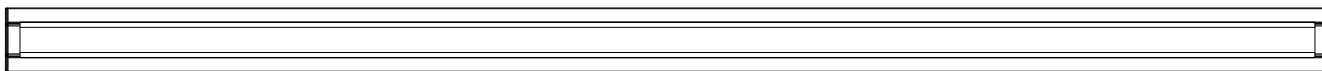

LH Removable
Crossbar Mount (1X)



RH Removable
Crossbar Mount (1X)

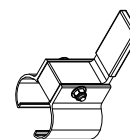

End Stop (2X)

HKT-0183 Removable Crossbar Hardware Kit

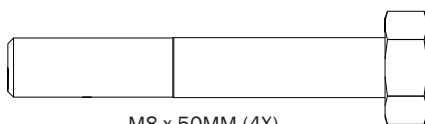

M8 x 50MM (4X)

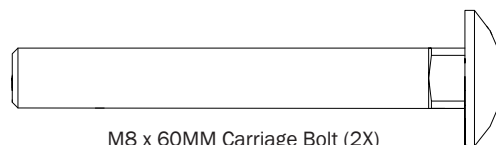

M8 x 60MM Carriage Bolt (2X)



M8 Lock Nut (2X)



Lock Washer (4X)

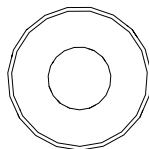

5/16" Flat Washer (6X)

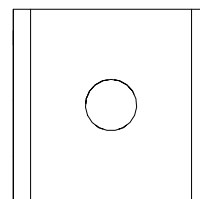

M8 Nut Bracket (4X)

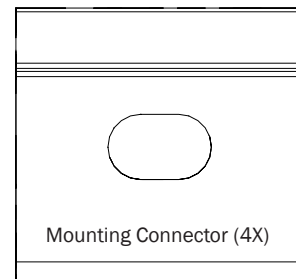

Mounting Connector (4X)



Anti-Seize

ASSEMBLY INSTRUCTIONS

NOTE: Channels in this Overview are shown for reference only. Specific channels and configurations are determined by Service Body size.

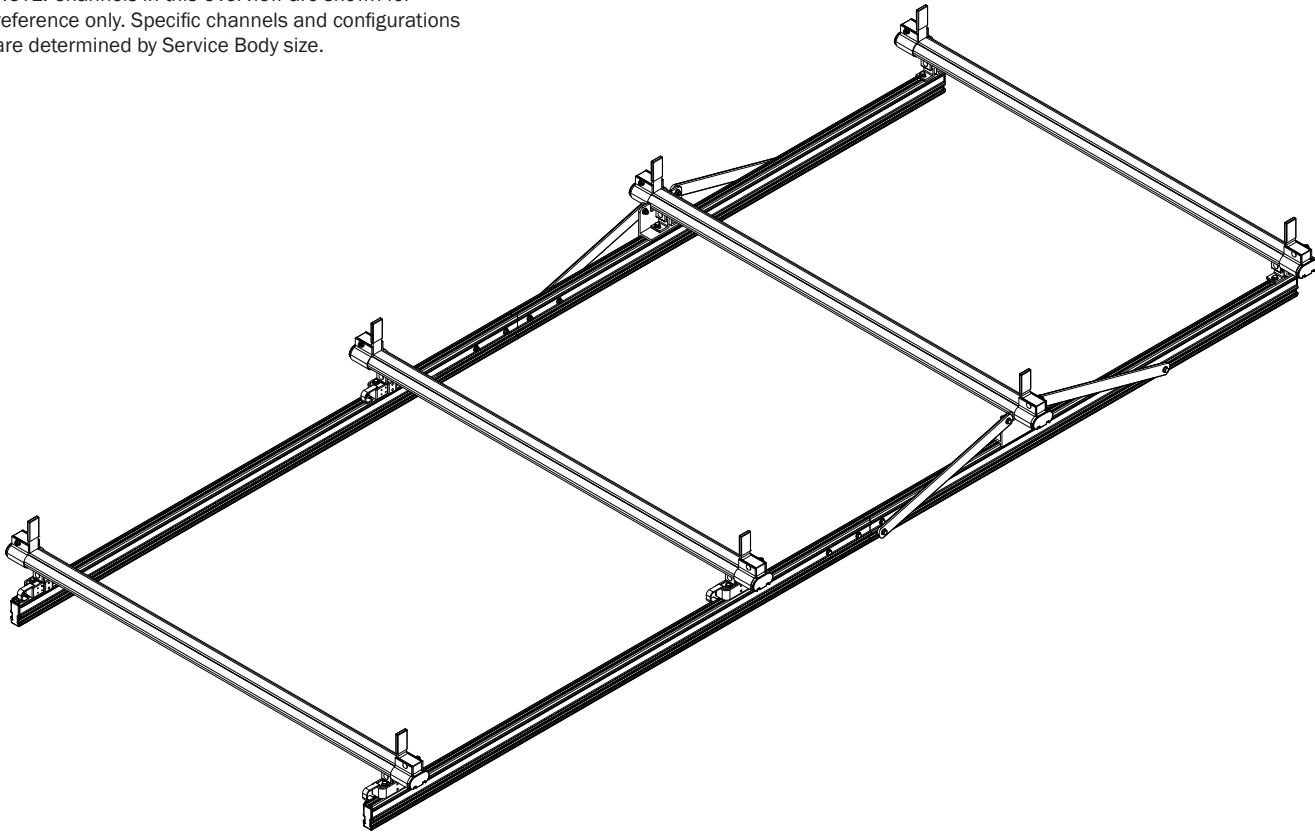

CROSSBAR MOUNT BUILDS

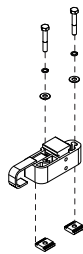
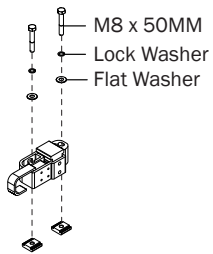

Leave M8 Nut Brackets loose until Step 5



1.2

Left side shown-repeat on right

Locknut
Flat Washer
M8 x 60MM Carriage Bolt

PRE-INSTALLED REMOVABLE CROSSBAR

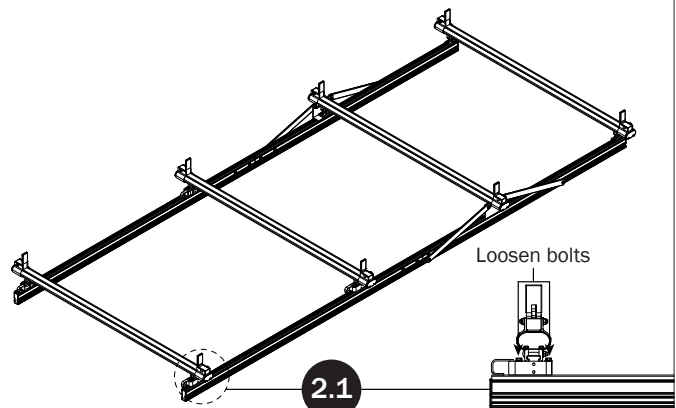

Loosen bolts

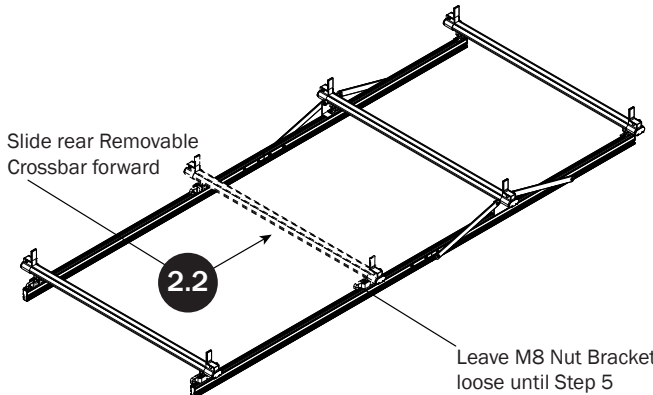

Slide rear Removable Crossbar forward

Leave M8 Nut Brackets loose until Step 5

ADD-ON CROSSBAR INSTALLATION

- 3** Install Mounts into Channels as shown below.

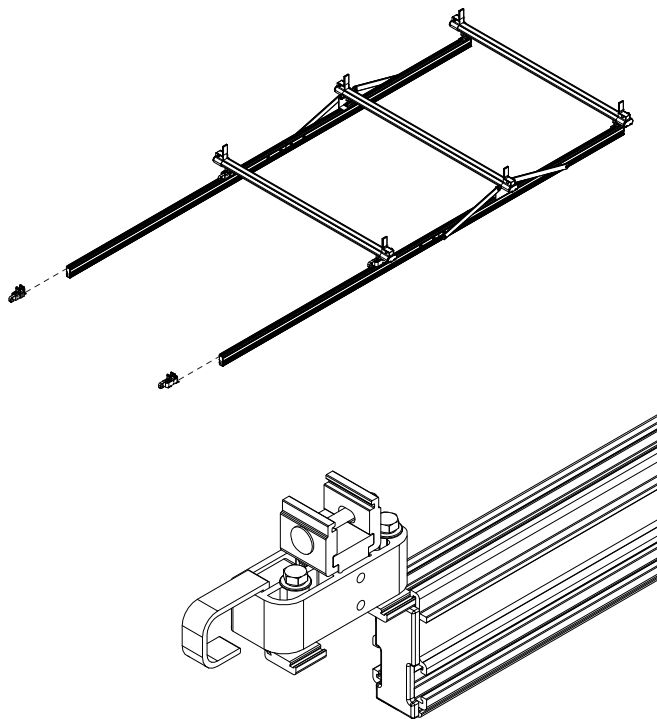

- 4.1** Set Crossbars into the Mounts as shown and torque Crossbar Connector Hardware to 90 in-lbs.

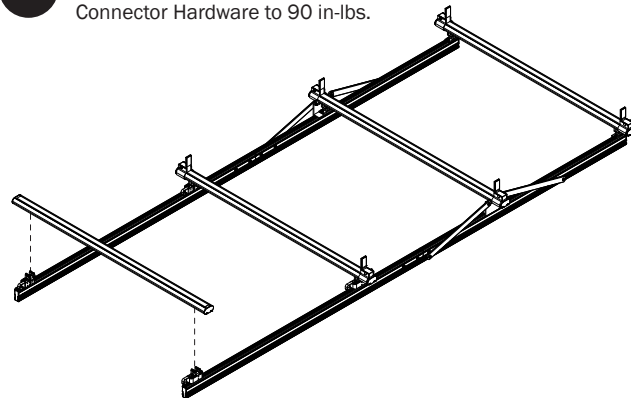

- 4.2** Attach Ladder stops as shown and torque to 90 in-lbs.

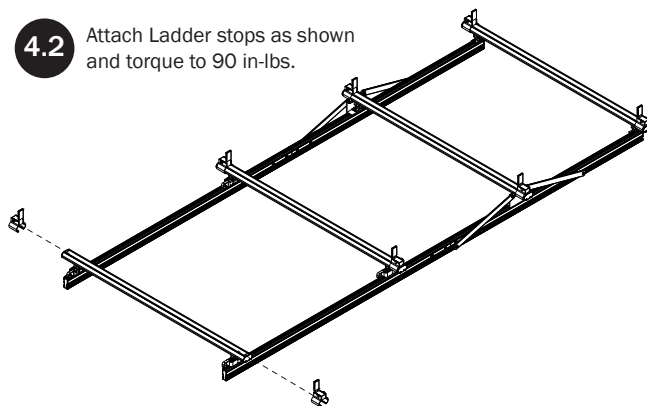

- 5** Set to distances as shown below, and torque all Removable Crossbar Mounts into the Channels at 90 in-lbs.

NOTE: Channels and FBM are shown for reference. Specific channels and configurations are determined by Service Body size.

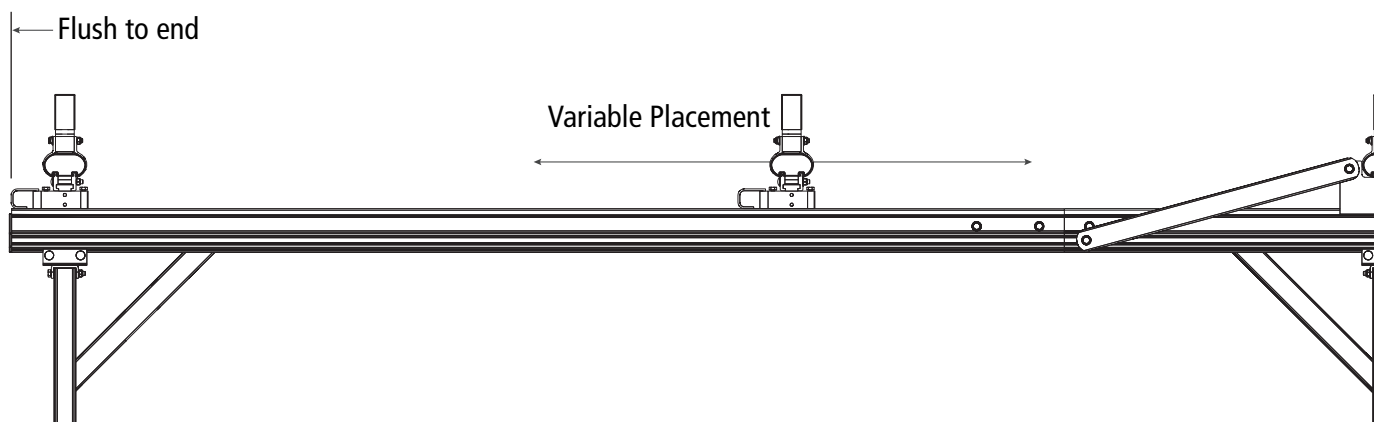

USAM-OCM3032-US01 Rev-A 0220