



FORK HAND TRUCK

INSTRUCTION MANUAL



67264-75

CONTENTS

Specs	3
Parts Diagram	4
Assembly	5

TOOLS NEEDED

- 7/16" Wrench
- Ratchet with 7/16" Socket
- Needle Nose Pliers
- Box Cutters / Utility Knife

STANDARD ON ALL AMERICAN CART PRODUCTS

Made in the USA

Hand crafted at our Ohio plant.

Heavy-duty comes standard

American Carts are all built to heavy duty specs

Flat-free tires

10 inch closed-cell tires that will never go flat

Powder coated finish

Protects the steel and provides a lasting finish

D-Brackets

One piece design holds the axle in place and supports the load

Steel construction

Built from American sourced steel

Easy to operate

Designed to get work done with less muscle strain and simple operation

WARRANTY

3 Year Limited Warranty. Carts, excluding any finishes, casters and wheels are warranted for three (3) years from date of original purchase. Casters and wheels are warranted for 90 days from date of original purchase. We will repair, without charge, any defect due to faulty material or workmanship. These warranties do not cover failures due to abuse, misuse, improper installation, accidental damage or when repairs or modifications have been made or attempted to be made by anyone other than Granite Industries. Any defective products that meet warranty specifications and Granite Industries approval, may be returned to the factory to be repaired or replaced free of charge. (Granite Industries will pay to ship replacement item(s) to the customer; however the customer is responsible for shipment of products to the factory.) This remedy is the sole remedy in contract, tort or otherwise, and Granite Industries is not liable for incidental, consequential or special damages. These warranties give you specific legal rights, and you may have other rights which vary from state to state. Should you have any questions, contact Granite Industries (Proof of purchase may be required).



Customer Service
877-447-2648
M-F, 8am - 5pm EST

SPECS

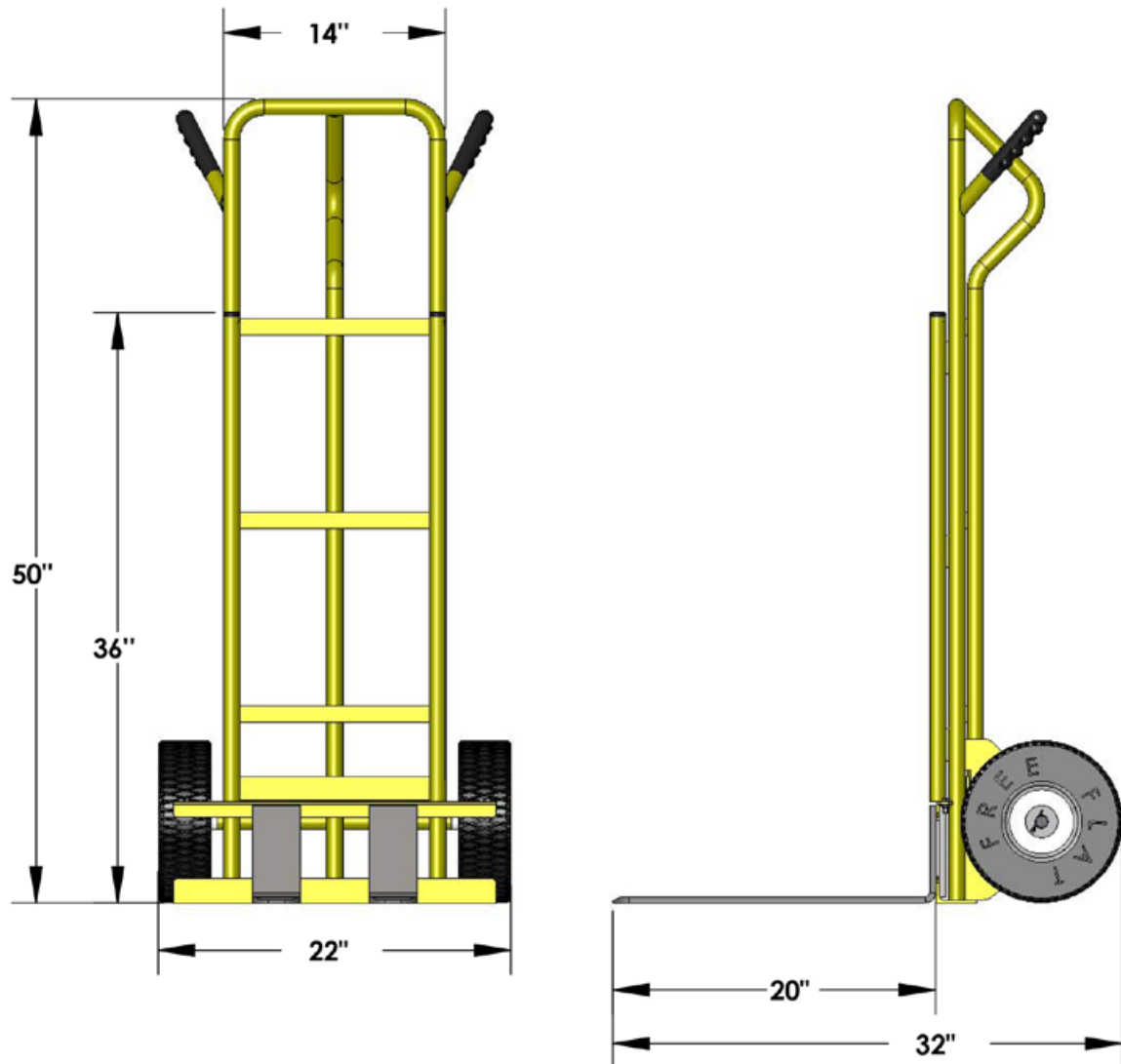

Overall Dimensions:	W: 22"	D: 32"	H: 50"
Forks:	W: 3"	D: 20"	
Weight:	62 lbs.	Capacity:	600 lbs.

PARTS DIAGRAM

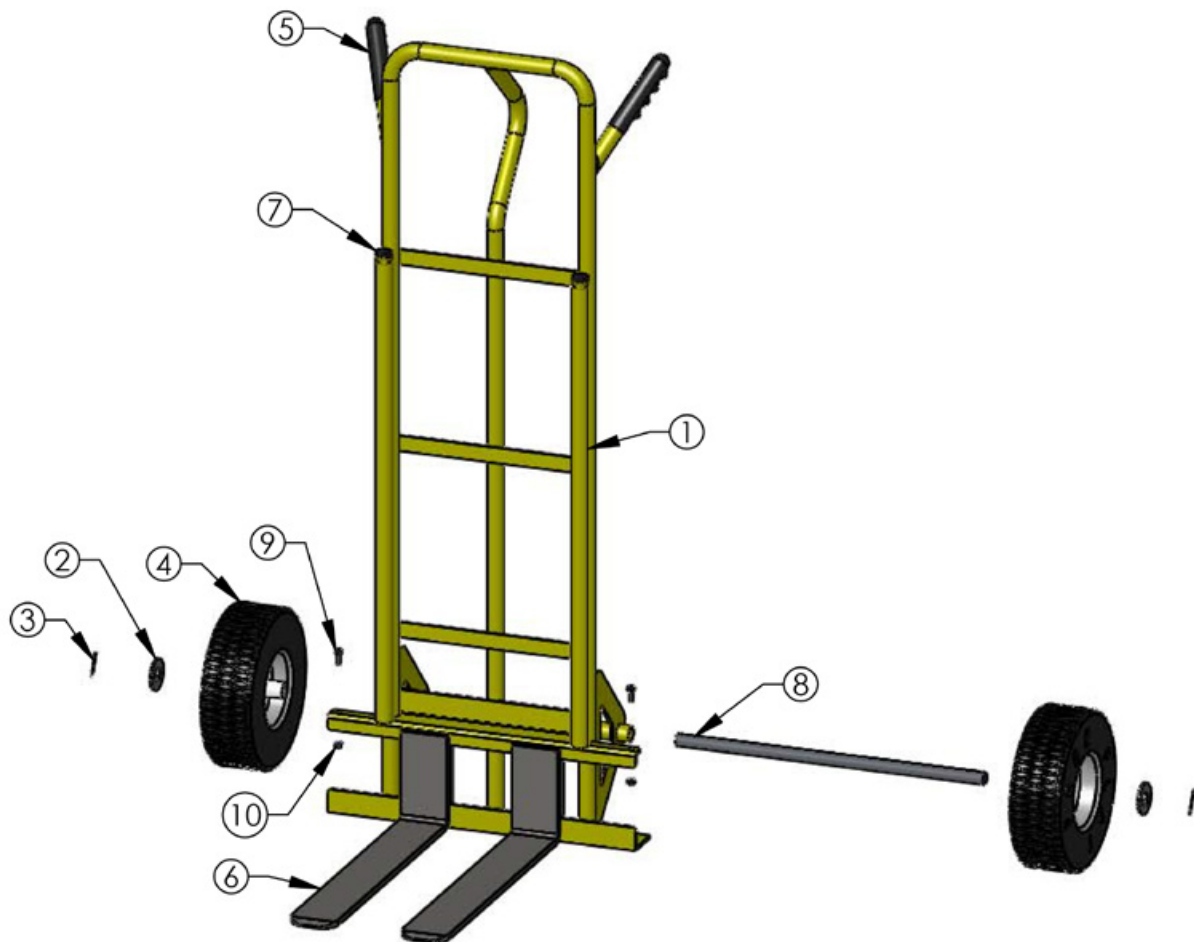

ITEM NO	QTY	PART NO	DESCRIPTION	
1	1	MI-12-5015	Fork Hand Truck Body	
2	4	PI-01-0451	3/4" Washer	
3	2	PI-01-0226	1-1/4" Cotter Pin	
4	2	PI-06-0115	10" Wheel with Steel Hub	
5	2	PI-04-0109	Hand Grip	
6	2	MI-12-2060	Fork	
7	2	PI-04-0035	1" Round Cap	
8	1	MI-04-0668	3/4" Axle Rod	
9	2	PI-01-0011	1/4" Hex Bolt	Use 7/16" Wrench/Socket
10	2	PI-01-0012	1/4" Lock Nut	Use 7/16" Wrench/Socket

STEP 1: FRONT WHEEL ASSEMBLY

COMPONENTS		
ITEM NO	QTY	DESCRIPTION
1	1	Fork Hand Truck Body
2	4	3/4" Washer
3	2	1-1/4" Cotter Pin
4	2	10" Wheel with Steel Hub
8	1	3/4" Axle Rod

TOOLS		
Needle Nose Pliers		



1

Insert the axle rod through the tube located on the back of the cart.



2

Slide a 3/4" washer, and a wheel onto the axle, making sure the offset side of the hub goes towards the body of the cart.



3

Slide the washer onto the axle.



4

Insert the cotter pin and secure it by bending both ends outward with a **needle nose pliers**. Repeat steps 2-4 on other side.

STEP 2: REAR AXLE ASSEMBLY

COMPONENTS		
ITEM NO	QTY	DESCRIPTION
6	2	Fork
9	2	1/4" Hex Bolt
10	2	1/4" Lock Nut

TOOLS		
7/16" Wrench and Socket		



1 Slide the fork onto the cart frame as shown. Repeat for the other side.



2 Insert the 1/4" hex bolt into the hole and secure it with the 1/4" lock nut.



3 Tighten down using a **7/16" wrench and socket**. Repeat these steps for the other side.



Your Fork Hand Truck is now fully assembled.

NOTES:

[illegible]



GRANITE INDUSTRIES
595 EAST LUGBILL ROAD
877-447-2648
SUPPORT@GRANITEIND.COM