

ERECT-A-STEP
WWW.ERECTASTEP.COM 888.878.1839

Universal Modular Platform System

Owner's Manual

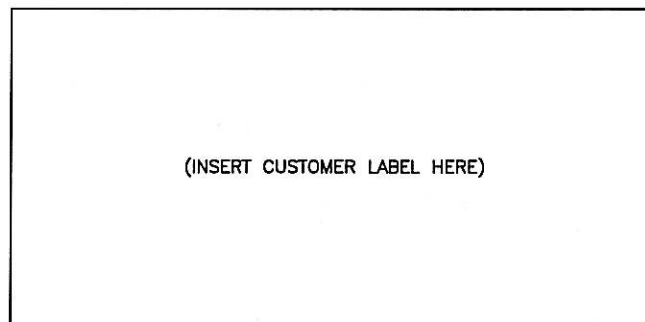
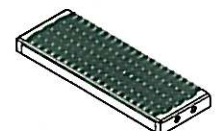
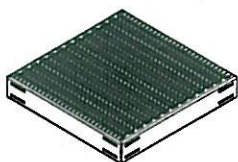
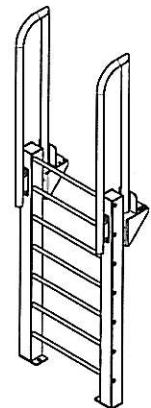
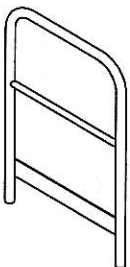
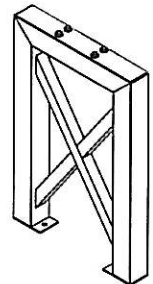
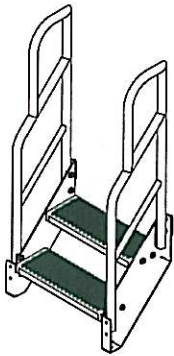

ERECT-A-STEP
219 SAFETY AVENUE
ANDREWS, SC 29510
888-878-1839 / Fax 843-264-8584

MODULAR PLATFORMS AND STAIRS - PRE-ENGINEERED DESIGN ALLOWS FOR UNLIMITED CONFIGURATIONS

INTRODUCTION

ERECT-A-STEP MODULAR PLATFORM AND STAIR SYSTEMS ARE PRE-ENGINEERED AND DESIGNED FOR UNLIMITED CONFIGURATIONS. THIS UNIVERSAL DESIGN ALLOWS FOR OPTIMUM FLEXIBILITY TO GAIN ACCESS AND EGRESS OVER AND/OR AROUND OBSTRUCTIONS, EQUIPMENT, WALLS, ETC.

ERECT-A-STEP USES ONLY THE HIGHEST QUALITY MATERIAL IN THE CONSTRUCTION OF ITS MODULAR SYSTEM TO ENSURE THE QUALITY, STRENGTH, AND DEPENDABILITY FOR YEARS. IT IS VERY IMPORTANT TO FOLLOW CONFIGURATION GUIDELINES AND INSTALLATION INSTRUCTIONS FOR YOUR ERECT-A-STEP SYSTEM. DESIGN LIMITATIONS CAN EXIST WITH RESPECT TO REQUIRED SUPPORTS, ADEQUATE FOOTINGS, AND PRESCRIBED APPLICATION.

SYSTEM DESIGN

APPLICABLE OSHA REGULATIONS DESIGNED TO:

OSHA 1910.23(e)(1) A standard railing shall consist of top rail, intermediate rail, and posts, and shall have a vertical height of 42 inches nominal from upper surface of top rail to floor, platform, runway, or ramp level. The top rail shall be smooth surfaced throughout the length of the railing. The intermediate rail shall be approximately halfway between the top rail and the floor, platform, runway, or ramp. The ends of the rails shall not overhang the terminal posts except where such overhang does not constitute a projection hazard.

OSHA 1910.23(e)(5)(iv) The mounting of handrails shall be such that the completed structure is capable of withstanding a load of at least 200 pounds applied in any direction at any point on the rail.

OSHA 1910.23(e)(6) All handrails and railings shall be provided with a clearance of not less than 3 inches between the handrail or railing and any other object.

OSHA 1910.23(e)(3)(ii) For pipe railings, posts and top and intermediate railings shall be at least 1-1/2 inches nominal diameter with posts spaced not more than 8 feet on centers.

OSHA 1910.23(e)(2) A stair railing shall be of construction similar to a standard railing but the vertical height shall be not more than 34 inches nor less than 30 inches from upper surface of top rail to surface of tread in line with face of riser at forward edge of tread.

OSHA 1910.24(c) "Stair strength." Fixed stairways shall be designed and constructed to carry a load of five times the normal live load anticipated but never of less strength than to carry safely a moving concentrated load of 1,000 pounds.

OSHA 1910.24(d) "Stair width." Fixed stairways shall have a minimum width of 22 inches.

OSHA 1910.24(e) "Angle of stairway rise." Fixed stairs shall be installed at angles to the horizontal of between 30 deg. and 50 deg. Any uniform combination of rise/tread dimensions may be used that will result in a stairway at an angle to the horizontal within the permissible range. Table D-1 gives rise/tread dimensions which will produce a stairway within the permissible range, stating the angle to the horizontal produced by each combination. However, the rise/tread combinations are not limited to those given in Table D-1.

Angle to horizontal	Rise (in inches) Table D-1	Tread run (in inches)
30 deg. 35'	6-1/2	11
32 deg. 08'	6-3/4	10-3/4
33 deg. 41'	7	10-1/2
35 deg. 16'	7-1/4	10-1/4
36 deg. 52'	7-1/2	10
38 deg. 29'	7-3/4	9-3/4
40 deg. 08'	8	9-1/2
41 deg. 44'	8-1/4	9-1/4
43 deg. 22'	8-1/2	9
45 deg. 00'	8-3/4	8-3/4
46 deg. 38'	9	8-1/2
48 deg. 16'	9-1/4	8-1/4
49 deg. 54'	9-1/2	8

OSHA 1910.24(f) "Stair treads." All treads shall be reasonably slip-resistant and the nosings shall be of nonslip finish. Welded bar grating treads without nosings are acceptable providing the leading edge can be readily identified by personnel descending the stairway and provided the tread is serrated or is of definite nonslip design. Rise height and tread width shall be uniform throughout any flight of stairs including any foundation structure used as one or more treads of the stairs.

OSHA 1910.144(a)(3) Yellow. Yellow shall be the basic color for designating caution and for marking physical hazards such as: Striking against, stumbling, falling, tripping, and "caught in between."

OSHA 1926.451(f)(16) Platforms shall not deflect more than 1/60 of the span when loaded.

START-UP TOOLS

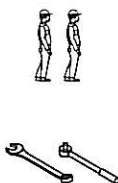

- MIN. 2 PEOPLE ARE RECOMMENDED FOR ASSEMBLY
- COMPLIMENTARY TOOL KIT INCLUDED IN SHIPMENT:
- (1) 3/4" WRENCH
- (1) 3/4" SOCKET AND HANDLE
- (1) ANTI-SEIZE PACKET

NOTE: USE ANTI-SEIZE ON BOLT/NUT CONNECTIONS TO PREVENT GALLING.



SAFETY STAIR

PACKAGE INCLUDES:

LEFT STRINGER with HANDRAIL
RIGHT STRINGER with HANDRAIL
STEP(S) w/ HARDWARE
LEFT GUSSET BRACKET
RIGHT GUSSET BRACKET
REAR CROSS BRACE (IF APPLICABLE)
HARDWARE PACKAGE

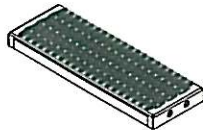

STEP
(step size determines qty)

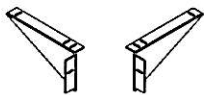

GUSSET BRACKET
(1 left, 1 right)
(1&2 step - not applicable)

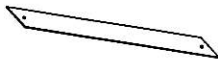

REAR CROSS BRACE
(1&2 step - not applicable)
(3&4 step - 1 req'd)
(5,6&7 step - 2 req'd)
(8 step - 3 req'd)
(9,10,&11 step - 4 req'd)

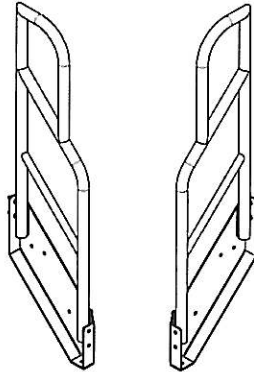

STRINGER
(1 left, 1 right)

STAIR UNIT

- 1 STEP - PART #11386
- 2 STEP - PART #11387
- 3 STEP - PART #11388
- 4 STEP - PART #11389
- 5 STEP - PART #11390
- 6 STEP - PART #11391
- 7 STEP - PART #11392
- 8 STEP - PART #11393
- 9 STEP - PART #11488
- 10 STEP - PART #11489
- 11 STEP - PART #11490

SAFETY HANDRAIL

PACKAGE INCLUDES:

HANDRAIL
(2) UHMW SPACERS
HARDWARE PACKAGE



UHMW SPACER

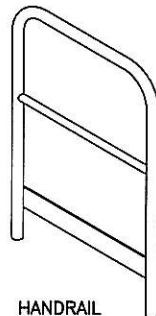

HANDRAIL

(PART #11395)

UNIVERSAL PLATFORM

PACKAGE INCLUDES:

36x36 PLATFORM
(8) BACKING PLATES
HARDWARE PACKAGE



BACKING PLATE

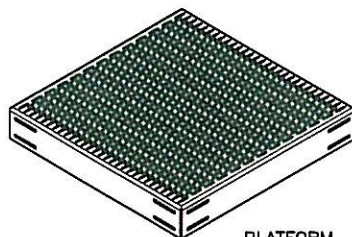

PLATFORM

(PART #11394)

TOWER SUPPORTS

PACKAGE INCLUDES:

TOWER SUPPORT
LEFT GUSSET BRACKET
RIGHT GUSSET BRACKET
HARDWARE PACKAGE

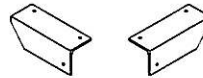

GUSSET BRACKET
(1 left, 1 right)
(1,2,&3 step - not applicable)

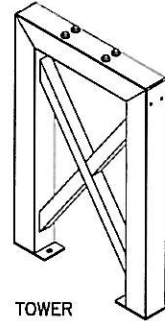

TOWER

NOTE: Cross bracing in tower varies depending on height. Shorter units will not have bracing.

- 1 STEP - PART #11378
- 2 STEP - PART #11379
- 3 STEP - PART #11380
- 4 STEP - PART #11381
- 5 STEP - PART #11382
- 6 STEP - PART #11383
- 7 STEP - PART #11384
- 8 STEP - PART #11385
- 9 STEP - PART #11468
- 10 STEP - PART #11469
- 11 STEP - PART #11470

LADDER

PACKAGE INCLUDES:

LADDER SECTION
HANDRAIL (2)
UHMW SPACER-HR (2)
UHMW SPACER-LAD (2)
GUSSET BRACKET (2)
HARDWARE PACKAGE



GUSSET BRACKET



UHMW SPACER-HR



UHMW SPACER-LAD



HANDRAIL

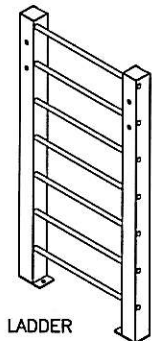

LADDER

- 1 STEP - PART #11457
- 2 STEP - PART #11458
- 3 STEP - PART #11459
- 4 STEP - PART #11460
- 5 STEP - PART #11461
- 6 STEP - PART #11462
- 7 STEP - PART #11463
- 8 STEP - PART #11464
- 9 STEP - PART #11488
- 10 STEP - PART #11489
- 11 STEP - PART #11490

TOOL PACKET

PACKAGE INCLUDES:

WRENCH
DEEP WELL SOCKET
SOCKET HANDLE
ANTI-SEIZE PACKET



NOTE: USE ANTI-SEIZE ON BOLT/NUT CONNECTIONS TO PREVENT GALLING.

PLEASE TAKE A MOMENT TO INSPECT YOUR NEW EQUIPMENT AND LOOK FOR SHIPPING DAMAGE. PLEASE CHECK PACKING LIST AGAINST YOUR EQUIPMENT TO INSURE ALL PARTS HAVE ARRIVED WITHOUT DAMAGE.



ERECT-A-STEP
WWW.ERECT-A-STEP.COM 888.678.1838

SPECIFICATIONS

4

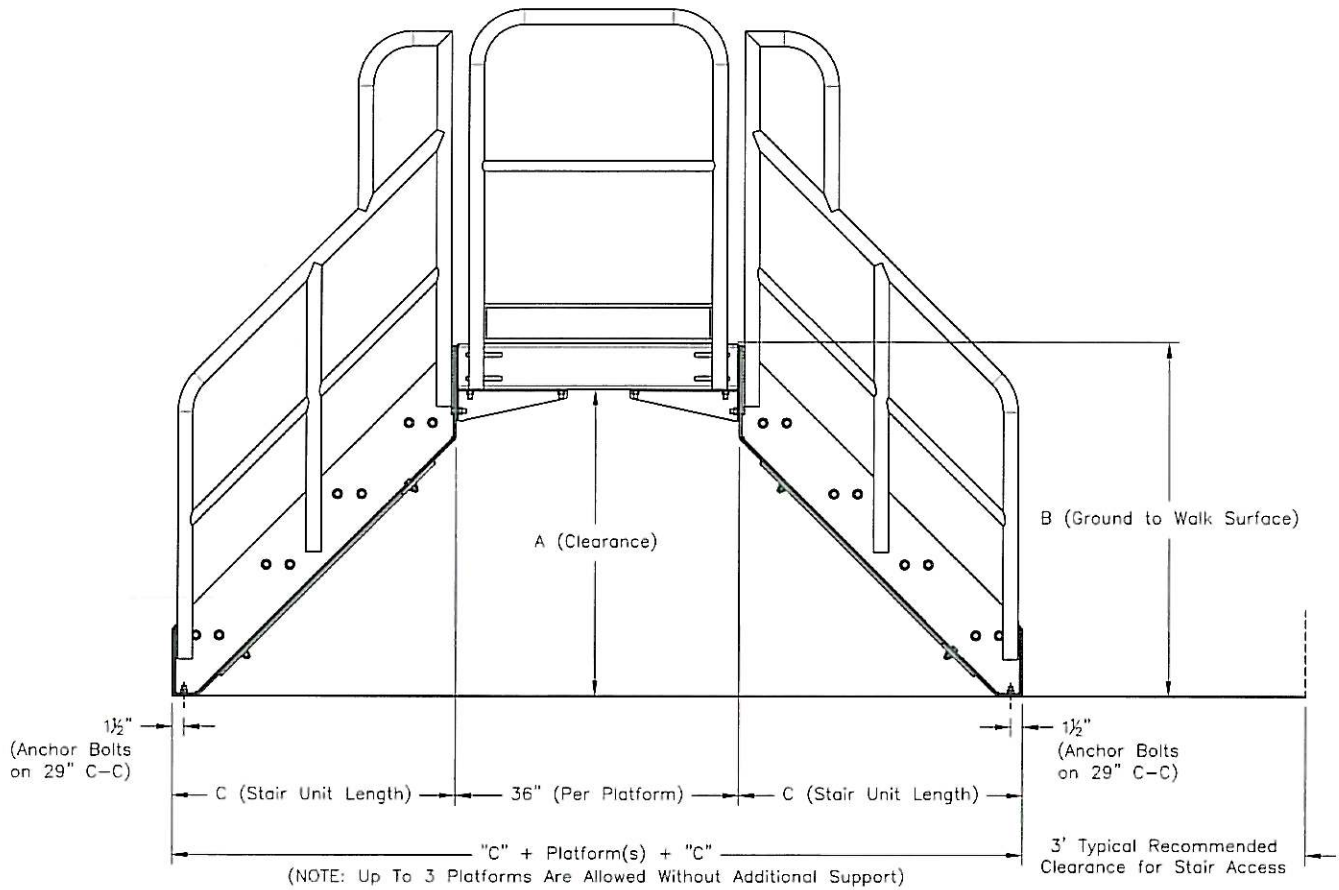

Cross-Over Clearance Table			
	A (in)	B (in)	C (in)
1-Step	12	18	9
2-Step	21	27	18
3-Step	30	36	27
4-Step	39	45	36
5-Step	48	54	45
6-Step	57	63	54
7-Step	66	72	63
8-Step	75	81	72
9-Step	84	90	81
10-Step	93	99	90
11-Step	102	108	99

SPECIFICATIONS - Stair

5

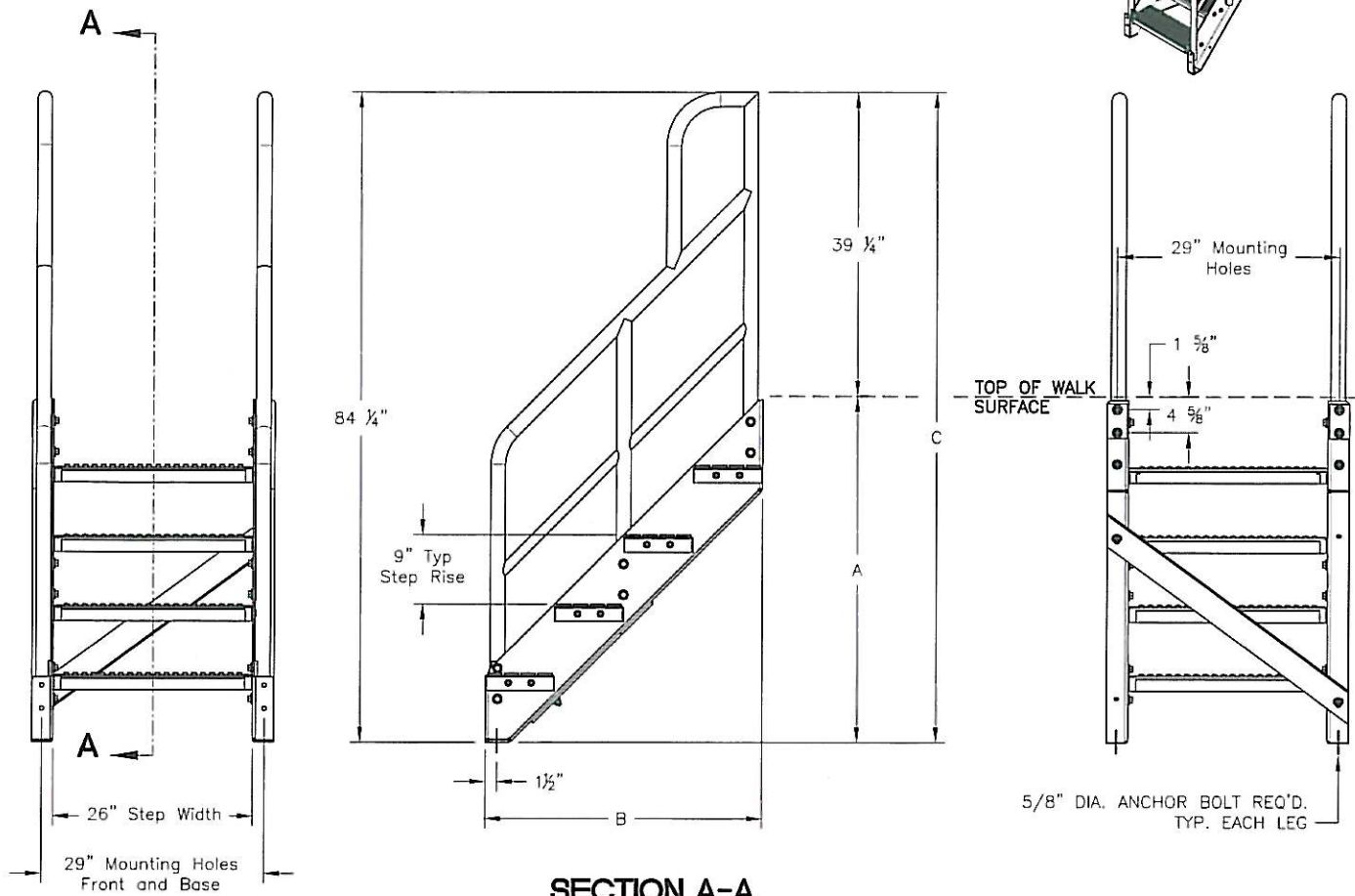
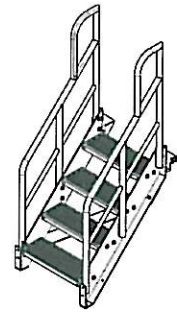

	A	B	C	Est. Weight
1-Step	18"	9"	57 1/4"	31 lbs
2-Step	27"	18"	66 1/4"	47 lbs
3-Step	36"	27"	75 1/4"	72 lbs
4-Step	45"	36"	84 1/4"	93 lbs
5-Step	54"	45"	93 1/4"	113 lbs
6-Step	63"	54"	102 1/4"	128 lbs
7-Step	72"	63"	111 1/4"	145 lbs
8-Step	81"	72"	120 1/4"	164 lbs
9-Step	90"	81"	129 1/4"	128 lbs
10-Step	99"	90"	138 1/4"	145 lbs
11-Step	108"	99"	147 1/4"	164 lbs

SPECIFICATIONS - Support

6

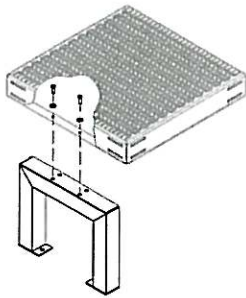

OUTSIDE BOLTING ONE

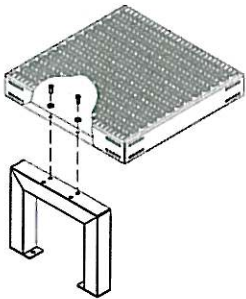

INSIDE BOLTING ONE

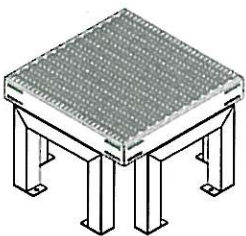

OUTSIDE BOLTING ALL SIDES

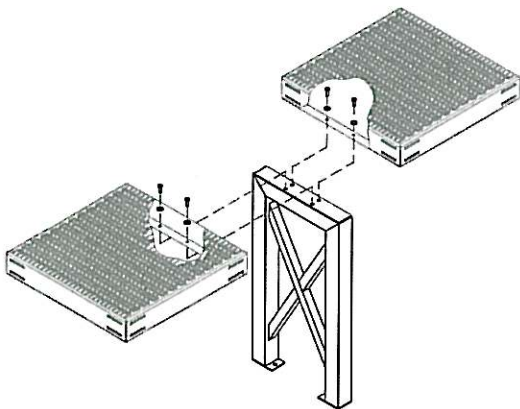

OUTSIDE BOLTING TWO

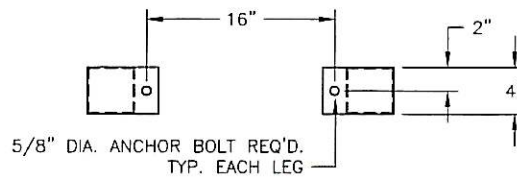
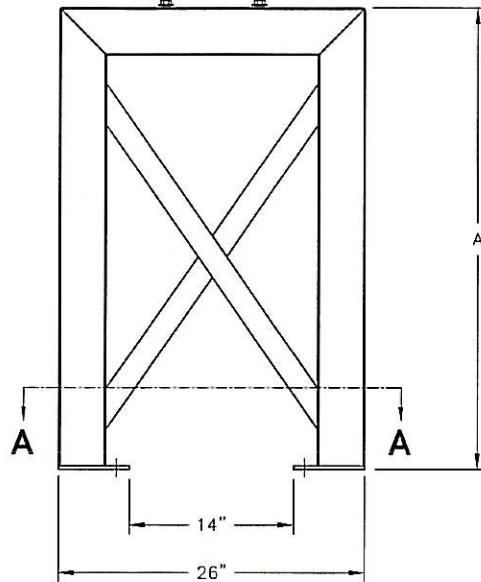
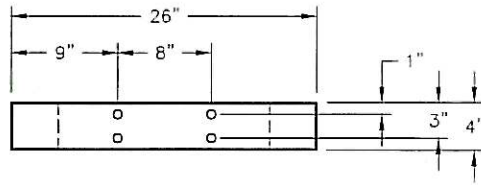

SECTION A-A

	A	Est. Weight
1-Step	12"	10 lbs
2-Step	21"	13 lbs
3-Step	30"	17 lbs
4-Step	39"	25 lbs
5-Step	48"	30 lbs
6-Step	57"	34 lbs
7-Step	66"	41 lbs
8-Step	75"	44 lbs
9-Step	84"	48 lbs
10-Step	93"	52 lbs
11-Step	102"	59 lbs

TYPICAL BOLTED CONNECTIONS



ERECTASTEP
WWW.ERECTASTEP.COM 888.878.1638

SPECIFICATIONS - Platform

7

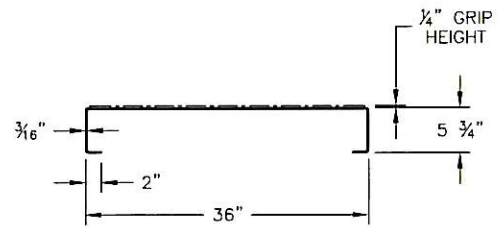
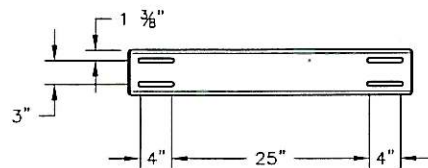
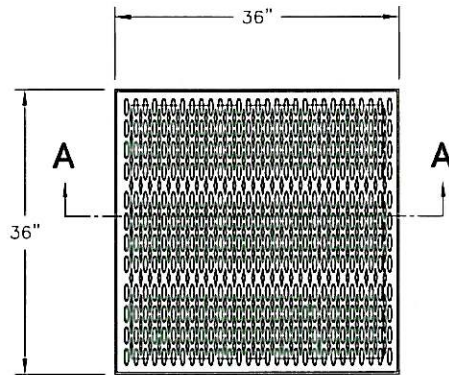
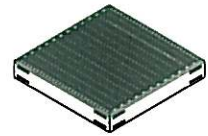

SECTION A-A

	Est. Weight
Standard 36X36 Platform	38 lbs

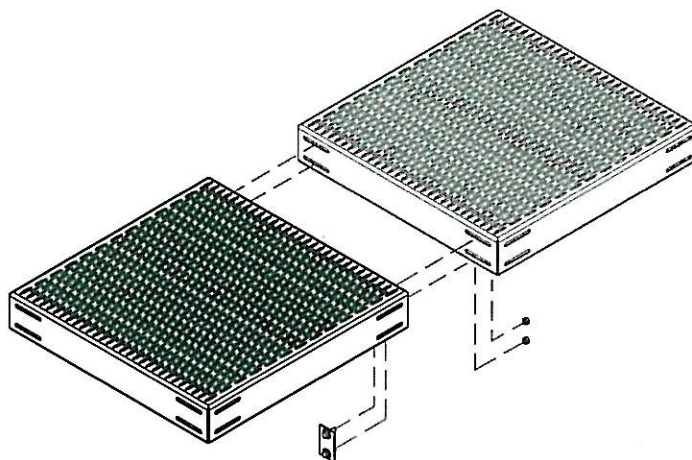

TYPICAL BOLTED CONNECTION

SPECIFICATIONS - Handrail

8

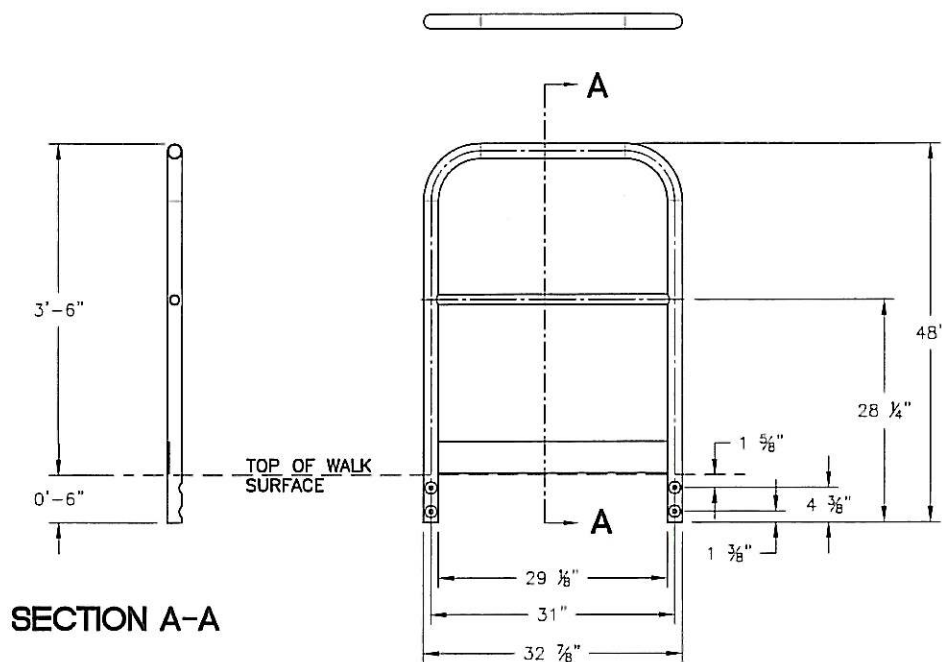

	Est. Weight
Standard Platform Handrail	12 lbs

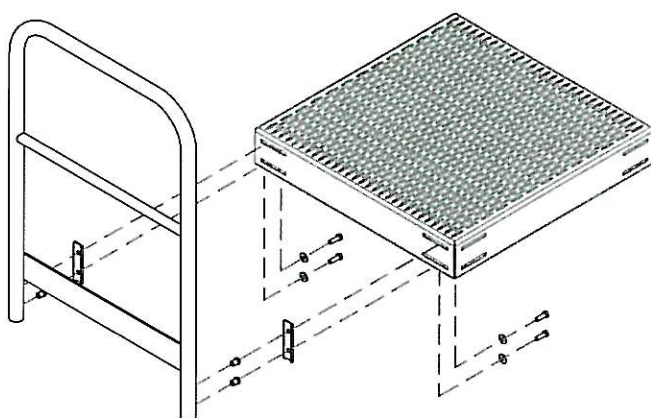

TYPICAL BOLTED CONNECTION

SPECIFICATIONS - Ladder

9

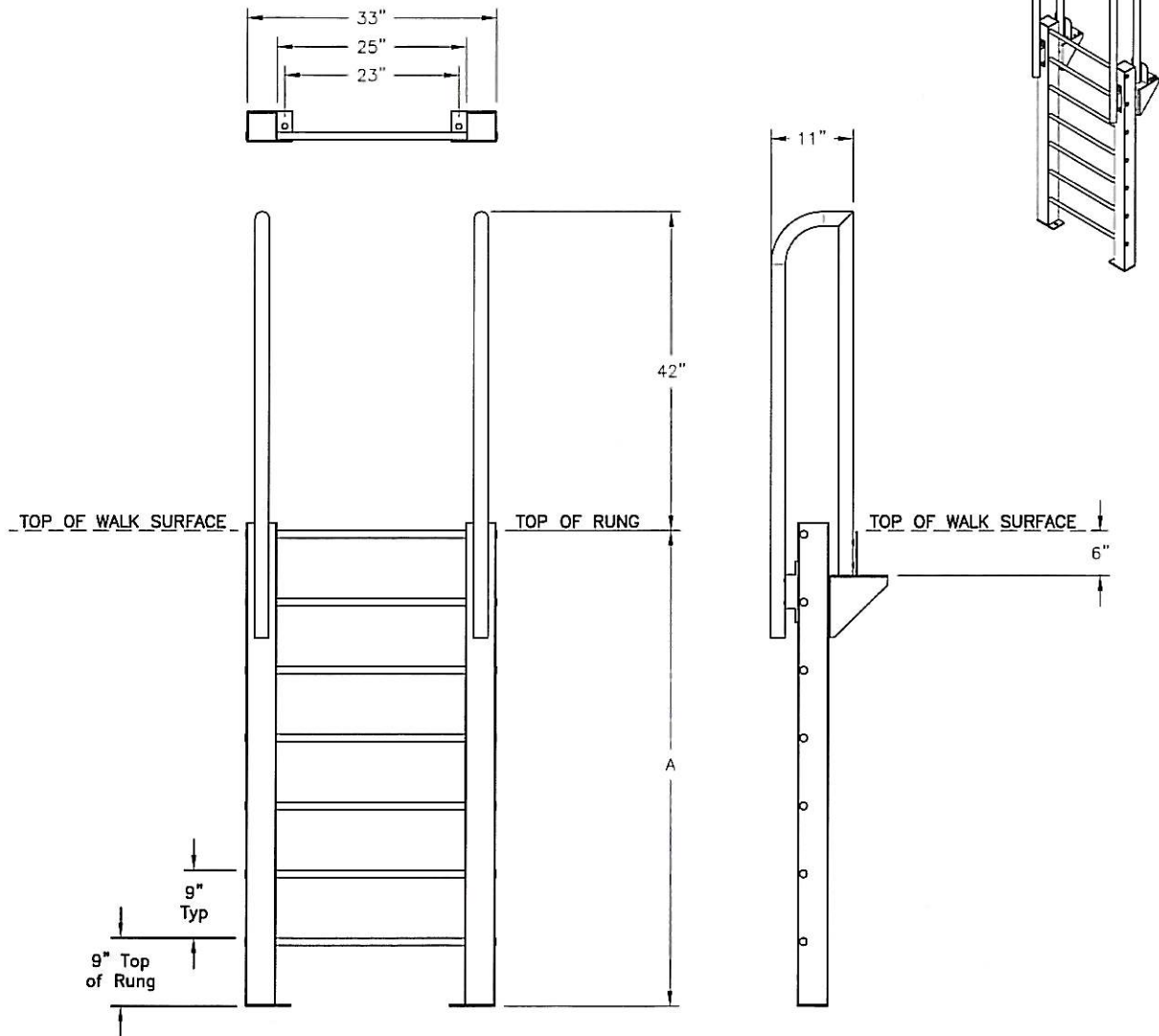

	A	Est. Weight
1-Step	18"	38 lbs
2-Step	27"	42 lbs
3-Step	36"	48 lbs
4-Step	45"	54 lbs
5-Step	54"	60 lbs
6-Step	63"	66 lbs
7-Step	72"	72 lbs
8-Step	81"	78 lbs
9-Step	90"	84 lbs
10-Step	99"	90 lbs
11-Step	108"	96 lbs

ASSEMBLY INSTRUCTIONS

Stair

10

Assembly 1:

STAIRS MUST BE PRE-ASSEMBLED BEFORE
ERECTING YOUR ERECTASTEP SYSTEM

- POSITION LEFT AND RIGHT SIDE STAIR SECTIONS AS SHOWN AND BOLT IN ALL STEPS PROVIDED.
- SECURE EACH STEP IN PLACE WITH BOLTS PROVIDED AND TIGHTEN ALL CONNECTIONS.

NOTE:
WHEN BOLTING COMPONENTS TOGETHER,
IF FASTENER INSERT "SPINS" IN PLACE, IT
IS DEFECTIVE AND MUST BE REPLACED.
CONTACT ERECTASTEP FOR A WARRANTY
REPLACEMENT.

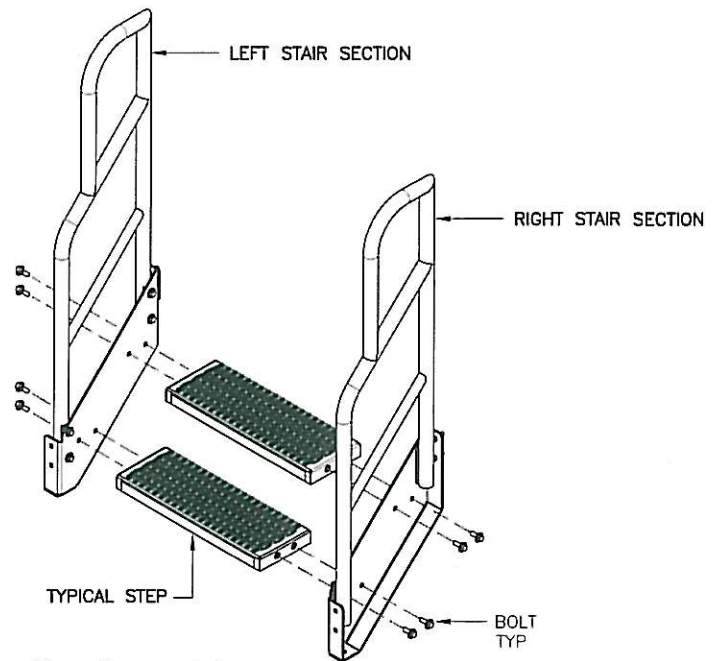

Step to Stair Section Assembly

Assembly 2:

- LARGER STAIR UNITS REQUIRE BRACING ON THE BACK ON THE UNIT.
- TYPICAL BRACING PATTERNS ARE SHOWN HERE FOR DIFFERENT SIZE STAIR UNITS.
- MATCH BRACING WITH STAIR AS SHOWN AND BOLT TOGETHER USING PROVIDED BOLTS. TIGHTEN ALL CONNECTIONS.

NOTE:
USE ANTI-SEIZE ON
BOLT/NUT CONNECTIONS
TO PREVENT GALLING.

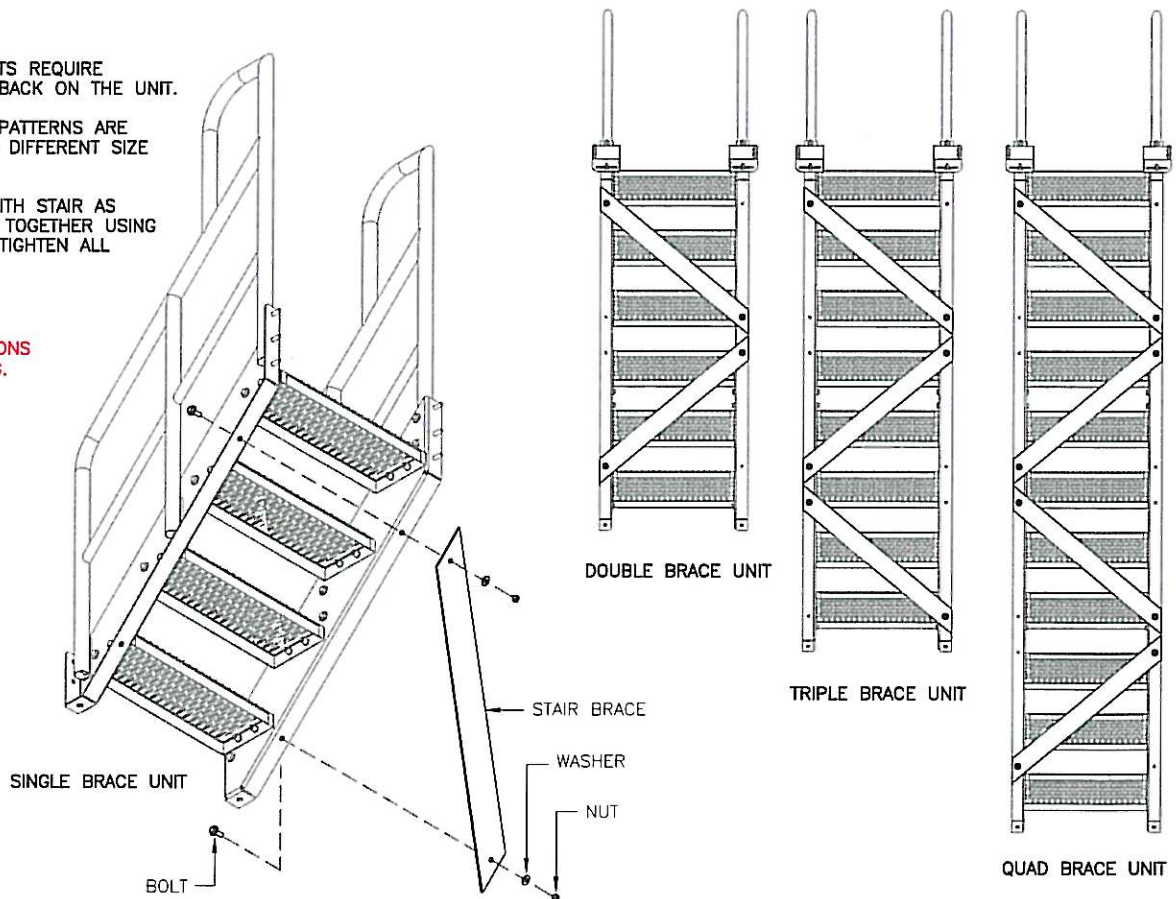

Stair Bracing to Stair Assembly
(REAR/BOTTOM VIEW OF STAIR)

ASSEMBLY INSTRUCTIONS

Stair To Platform

11

Assembly 1:

- ALIGN HOLES IN BACK OF STAIR WITH SLOTS IN PLATFORM. STAIRS CAN BE POSITIONED AND/OR RE-POSITIONED AS NECESSARY ALONG PLATFORM SIDE.
- WHEN BOLTING TO PLATFORM, BE SURE TO USE BACKING PLATE INSIDE PLATFORM BETWEEN SLOTS AND NUT.

- WHEN USING A MULTI-LEVEL CONFIGURATION, BOLT PLATFORM TO FRONT OF STAIR AS SHOWN. BE SURE TO USE BACKING PLATE INSIDE PLATFORM BETWEEN SLOTS AND NUT.

NOTE: WHEN USING THIS OPTION, THE STAIR HANDRAILS WILL HAVE TO BE REMOVED FROM THE STAIR UNIT TO INSERT THE BOLTS FOR THE PLATFORM CONNECTION AND THEN RE-INSTALLED.

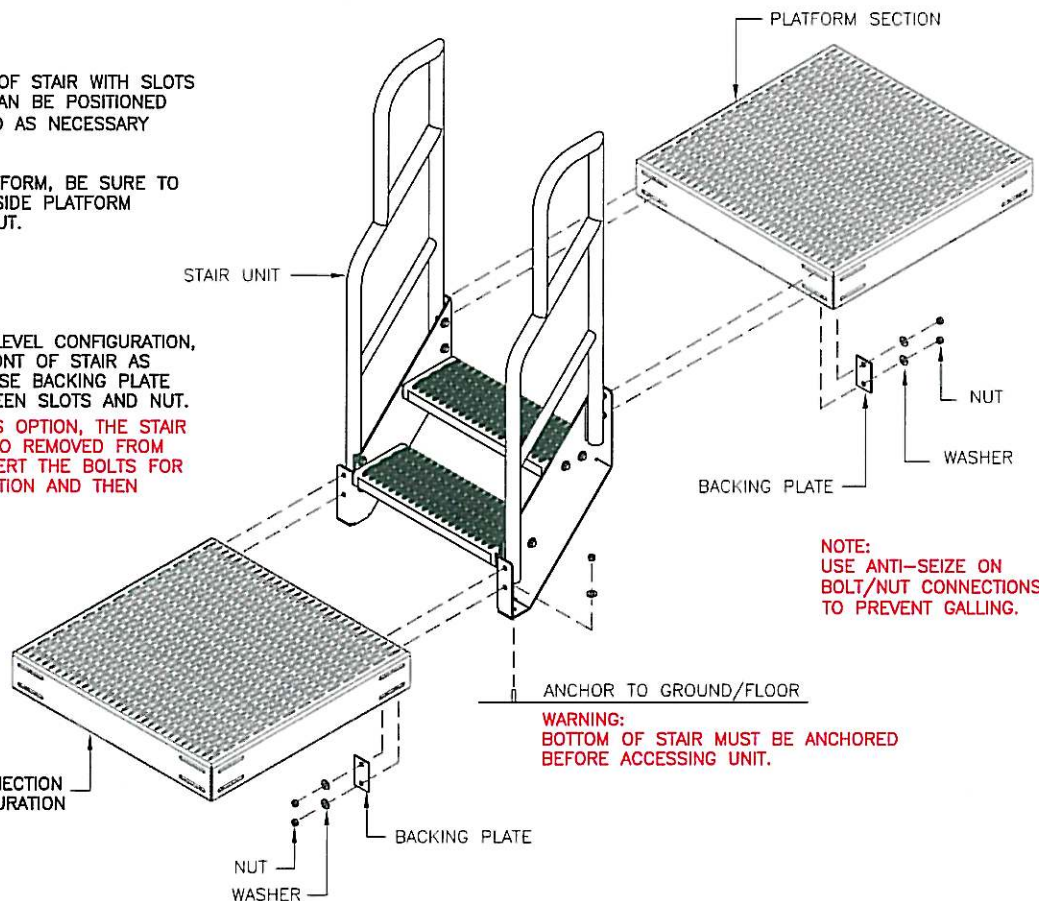

NOTE: USE ANTI-SEIZE ON BOLT/NUT CONNECTIONS TO PREVENT GALLING.

WARNING: BOTTOM OF STAIR MUST BE ANCHORED BEFORE ACCESSING UNIT.

Assembly 2 - Gusset Brackets:

WARNING: GUSSET BRACKETS (1 LEFT, 1 RIGHT) MUST BE INSTALLED AS SHOWN. FAILURE TO DO SO CAN RESULT IN AN UNSTABLE UNIT.

- ALIGN BOTTOM HOLE IN BACK OF STAIR WITH SLOT IN LEG OF BRACKET.
 - ALIGN THREE HOLES IN TOP OF BRACKET WITH CORRESPONDING HOLES IN BOTTOM OF PLATFORM AND BOLT TOGETHER USING SUPPLIED HARDWARE.
- (GUSSETS NOT APPLICABLE ON 1 & 2 STEP UNITS)
- TIGHTEN ALL CONNECTIONS SECURELY.

NOTE: USE ANTI-SEIZE ON BOLT/NUT CONNECTIONS TO PREVENT GALLING.

NOTE: PLATFORM CONNECTIONS ARE SLOTTED TO ALLOW FOR HANDRAIL CLEARANCE ISSUES THAT MAY BE NEEDED IN SOME MULTI-LEVEL, 90 DEGREE TURN CONFIGURATIONS. OTHERWISE, STAIRS SHOULD BE MOUNTED CENTERED ON PLATFORM.

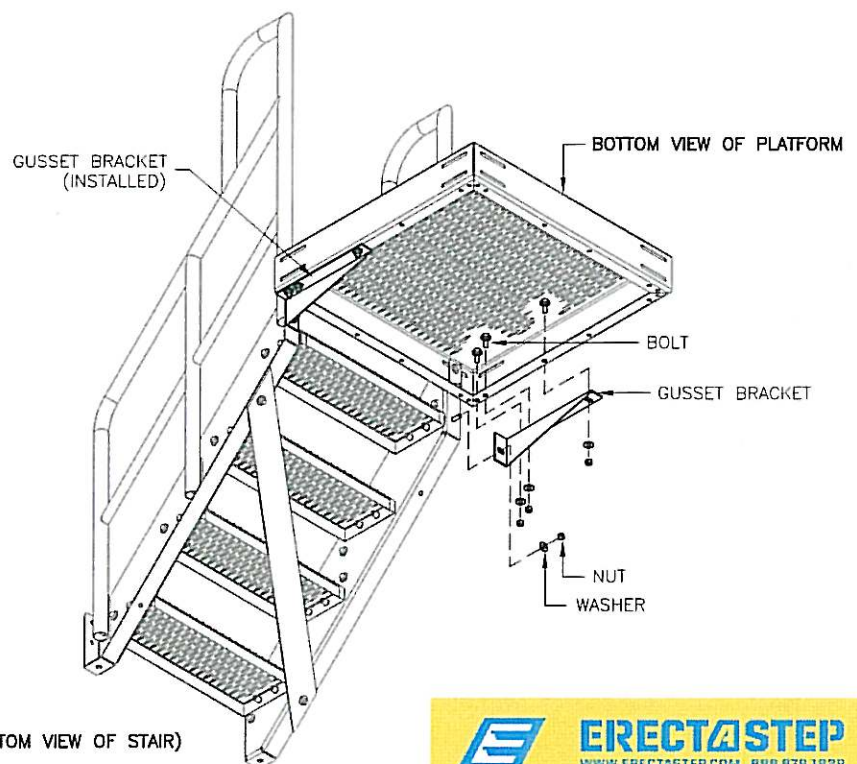

ASSEMBLY INSTRUCTIONS

Platform To Platform

12

Assembly:

- ALIGN SLOTS IN EACH SECTION OF PLATFORM. PLATFORMS CAN BE POSITIONED AS NECESSARY IN EITHER DIRECTION.
- WHEN BOLTING TOGETHER, BE SURE TO USE BACKING PLATE INSIDE PLATFORM BETWEEN SLOT AND NUT AND USE FLAT WASHER ON BOLT SIDE OF CONNECTION.
- TIGHTEN ALL CONNECTIONS SECURELY.

NOTE:
USE ANTI-SEIZE ON BOLT/NUT CONNECTIONS
TO PREVENT GALLING.

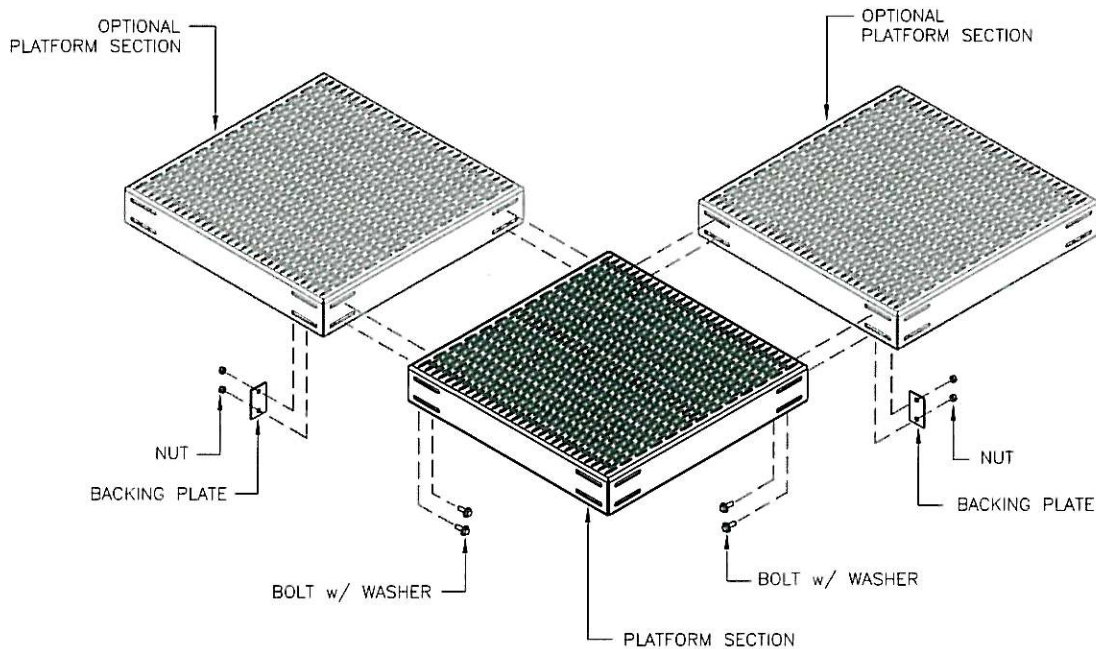

NOTE:
PLATFORM CONNECTIONS ARE SLOTTED TO
ALLOW FOR HANDRAIL CLEARANCE ISSUES
THAT MAY BE NEEDED IN SOME MULTI-LEVEL,
90 DEGREE TURN CONFIGURATIONS.
BUT MULTI-PLATFORMS SHOULD BE MOUNTED
CENTERED WITH EACH OTHER AS SHOWN.

ASSEMBLY INSTRUCTIONS

Support To Platform

13

Assembly a:

- ALIGN HOLES IN BOTTOM FLANGE OF PLATFORM WITH CONNECTION HOLES IN TOP OF SUPPORT.
- NOTE: WHEN SUPPORTING ONE PLATFORM, EITHER SET OF HOLES MAY BE USED. BY USING OUTSIDE HOLES (AS SHOWN), SUPPORT IS COMPLETELY RECESSED UNDER PLATFORM.
- BOLT TOGETHER USING SUPPLIED BOLTS AND WASHERS AS SHOWN.
- TIGHTEN ALL CONNECTIONS SECURELY.

NOTE:
WHEN BOLTING COMPONENTS TOGETHER, IF FASTENER INSERT "SPINS" IN PLACE, IT IS DEFECTIVE AND MUST BE REPLACED. CONTACT ERECTASTEP FOR A WARRANTY REPLACEMENT.

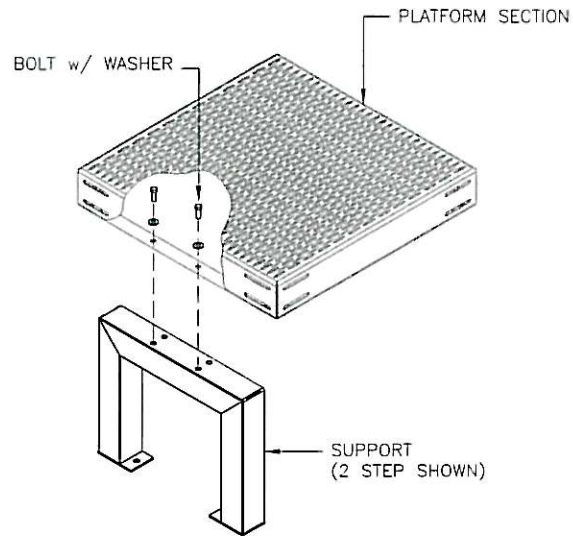
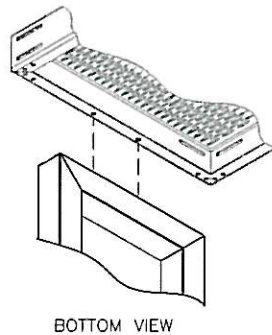

Support at End of Platform

Assembly b:

- NOTE: WHEN SUPPORTING TWO PLATFORMS, BE SURE EACH PLATFORM SECTION IS BOLTED TO TOP OF SUPPORT AS SHOWN.
- ALSO BOLT PLATFORMS TOGETHER AS SHOWN ON PAGE 11 OF THIS MANUAL.
- ALIGN HOLES IN BOTTOM FLANGE OF PLATFORM WITH CONNECTION HOLES IN TOP OF SUPPORT.
- BOLT TOGETHER USING SUPPLIED BOLTS AND WASHERS AS SHOWN.
- TIGHTEN ALL CONNECTIONS SECURELY.

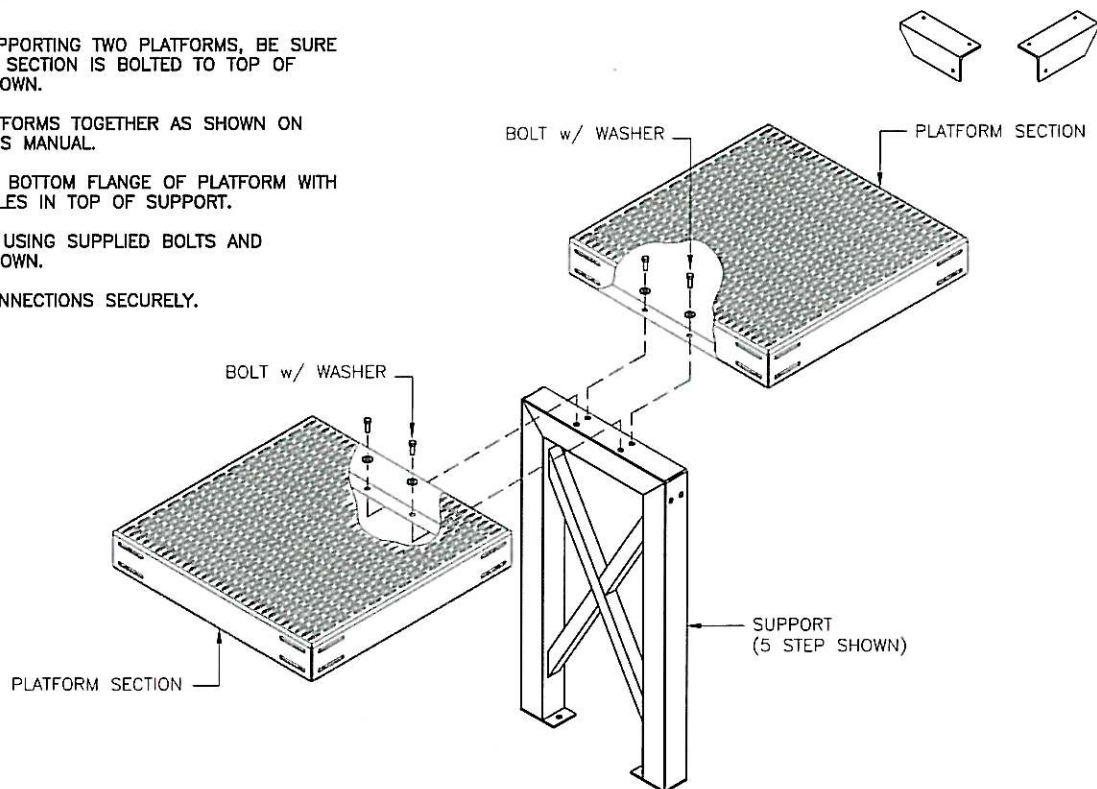

Support Between Two Platforms

ASSEMBLY INSTRUCTIONS

Handrail To Platform

14

Assembly:

- ALIGN HOLES IN HANDRAIL WITH SLOTS IN PLATFORM. HANDRAILS CAN FIT ANY SIDE OF PLATFORM.
- WHEN BOLTING TOGETHER, BE SURE TO USE UHMW SPACER BETWEEN HANDRAIL AND PLATFORM AND USE BACKING PLATE ON BOLT SIDE OF CONNECTION.
- TIGHTEN ALL CONNECTIONS SECURELY.

NOTE:
WHEN BOLTING COMPONENTS TOGETHER, IF FASTENER INSERT "SPINS" IN PLACE, IT IS DEFECTIVE AND MUST BE REPLACED. CONTACT ERECTASTEP FOR A WARRANTY REPLACEMENT.

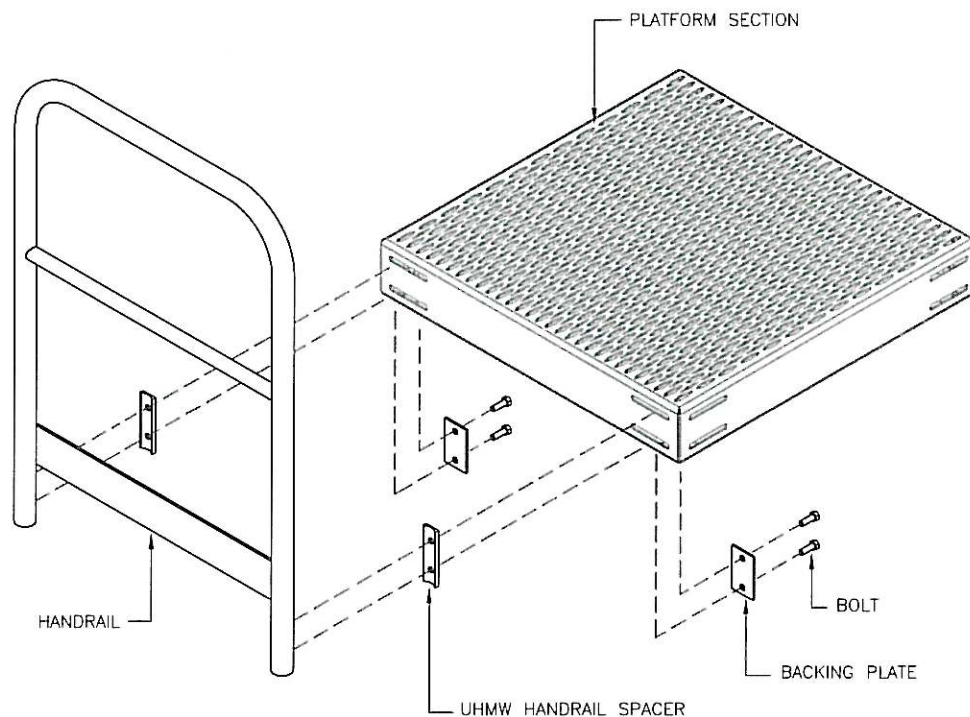

NOTE:
PLATFORM CONNECTIONS ARE SLOTTED TO ALLOW FOR HANDRAIL CLEARANCE ISSUES THAT MAY BE NEEDED IN SOME MULTI-LEVEL, 90 DEGREE TURN CONFIGURATIONS. OTHERWISE, HANDRAILS SHOULD BE MOUNTED CENTERED ON PLATFORM.