

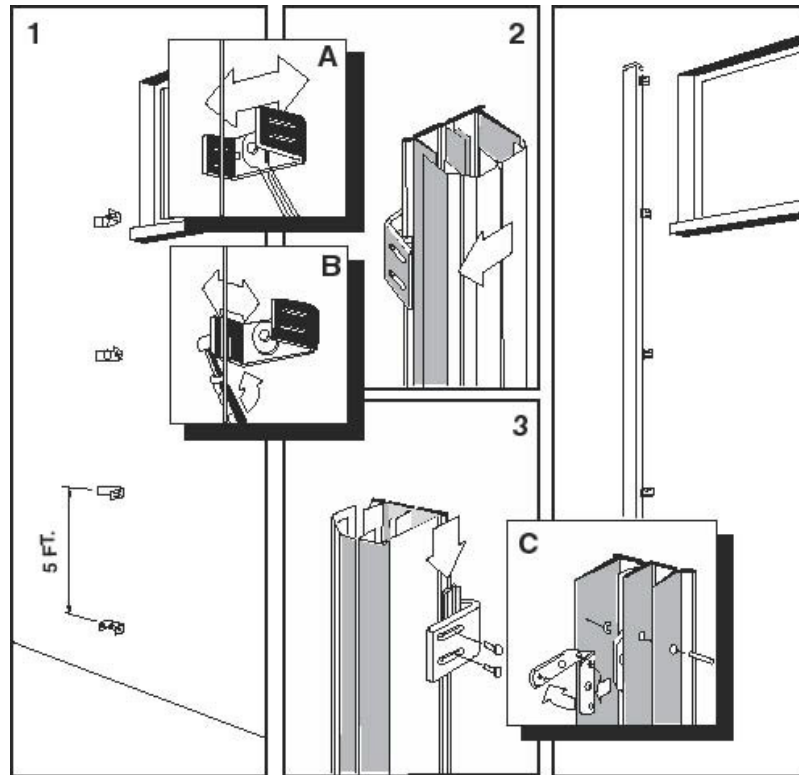

## Mini JOMY® : Installation Instructions



1. Drill holes every three to five feet (two brackets per 7' section) and attach mounting brackets as shown in A & B:

A. Align top mounting bracket. Align all with plumb line and tighten mounting bolts.

B. Attach mounting trunnion on short side of mounting bracket. Align with plumb line and tighten.

1. Insert ladder into installed mounting trunnions.
2. Insert remaining trunnions between long side of mounting bracket and ladder. Tighten securely.

### LATCH POSITIONING (C)

1. Remove clip and latch pin. This is located on the 4th rungs inside the fixed portion of the ladder.
2. Rotate latch 90° degrees (one quarter turn).
3. Reinsert latch pin and attach clip.

(Latch may be attached at the base or at the top at specified pins and slots.)